

THIS DRAWING IS UNPUBLISHED. RELEASED FOR PUBLICATION
 © COPYRIGHT - TE Connectivity ALL RIGHTS RESERVED.

| REVISIONS | | | | | |
|-----------|-----|-----------------------|--------|-----|------|
| P | LTR | DESCRIPTION | DATE | DWN | APVD |
| | C | REV PER ECO 17-004921 | 6-6-17 | CT | EH |

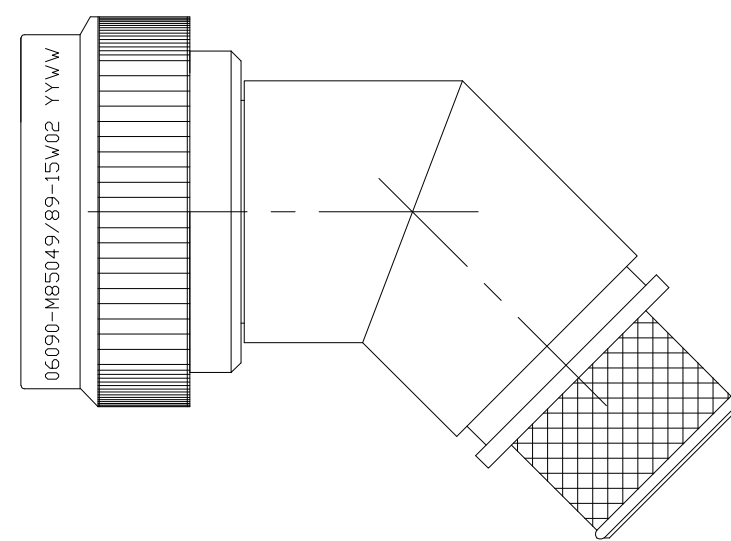

SELF-LOCKING
 SHIELD BAND TERMINATION
 SHRINK BOOT ACCOMMODATION 45°
 ADAPTER

1. THIS PRODUCT IS DESIGNED TO TERMINATE A BRAIDED CABLE SHIELD AND A HEAT SHRINKABLE LIPPED BOOT TO A CONNECTOR, AND DESIGNED TO MEET PERFORMANCE REQUIREMENT OF AS85049/89.
2. ALL COMPONENTS SHALL BE PACKAGED AND SUPPLIED IN A PLASTIC BAG AND LABELED WITH M85049/89 DESIGNATION e. g. M85049/89-15W02.
3. PART SUPPLIED WITH STANDARD DETENTED SELF-LOCKING WHICH PROVIDES A POSITIVE AUDIBLE DETENTED COUPLING.
4. THIS ADAPTER MATES TO CONNECTOR MIL-DTL-38999 SERIES III AND MIL-DTL-38999 SERIES IV.
5. FOR MATERIAL AND FINISH INFORMATION REFER TO R85049.
 FOR ALTERNATIVE MATERIALS AND PLATING FINISHES CONTACT TE CONNECTIVITY.

| | | | | | |
|---|--|--------------------------------|---|--------------------|---------------------------|
| THIS DRAWING IS A CONTROLLED DOCUMENT. | | DWN C.C.THOMAS 06JUN2017 | | | |
| DIMENSIONS: INCHES | | CHK E.HALEY 6-6-17 | | | |
| | | APVD E.HALEY 6-6-17 | NAME BACKSHELL, 45°, SELF-LOCKING, SHIELD BAND TERMINATION, SHRINK BOOT ADAPTER | | |
| TOLERANCES UNLESS OTHERWISE SPECIFIED: | | PRODUCT SPEC | APPLICATION SPEC | | |
| 0 PLC ± - 1 PLC ± - 2 PLC ± - 3 PLC ± - 4 PLC ± - ANGLES ± - | | WEIGHT 0 | SIZE A3 | CAGE CODE 06090 | DRAWING NO C-R85049/89 |
| MATERIAL - | | FINISH - | | RESTRICTED TO - | CUSTOMER DRAWING |
| | | | SCALE NTS | SHEET 1 OF 3 | REV C |

THIS DRAWING IS UNPUBLISHED.

RELEASED FOR PUBLICATION

REVISIONS

© COPYRIGHT - TE Connectivity

ALL RIGHTS RESERVED.

| P | LTR | DESCRIPTION | DATE | DWN | APVD |
|---|-----|-------------|------|-----|------|
| - | - | SEE SHEET 1 | - | - | - |



PART NUMBERING

R85049/89 - 15 W 02

- SPECIFICATION SHEET _____
- CONFIGURATION: _____
 - (DASH) DETENTED SELF-LOCKING
- ORDER NO. _____
- FINISH _____
- ENTRY SIZE _____

| | | | | | | | | | | | | | | | | | |
|--|-------------|--------------------------------|---|--------------------|---------------------------|--------------------|-----|-------|-----|-------|-----|--------|-----|-------------------|-----------------------|--|--|
| THIS DRAWING IS A CONTROLLED DOCUMENT. | | DWN C.C.THOMAS 06JUN2017 | TE Connectivity | | | | | | | | | | | | | | |
| DIMENSIONS: INCHES | | CHK E.HALEY 6-6-17 | | | | | | | | | | | | | | | |
| TOLERANCES UNLESS OTHERWISE SPECIFIED: | | APVD E.HALEY 6-6-17 | NAME BACKSHELL, 45°, SELF-LOCKING, SHIELD BAND TERMINATION, SHRINK BOOT ADAPTER | | | | | | | | | | | | | | |
| <table border="0"> <tr> <td>0 PLC</td><td>± -</td> </tr> <tr> <td>1 PLC</td><td>± -</td> </tr> <tr> <td>2 PLC</td><td>± -</td> </tr> <tr> <td>3 PLC</td><td>± -</td> </tr> <tr> <td>4 PLC</td><td>± -</td> </tr> <tr> <td>ANGLES</td><td>± -</td> </tr> </table> | | 0 PLC | ± - | 1 PLC | ± - | 2 PLC | ± - | 3 PLC | ± - | 4 PLC | ± - | ANGLES | ± - | PRODUCT SPEC - | APPLICATION SPEC - | | |
| 0 PLC | ± - | | | | | | | | | | | | | | | | |
| 1 PLC | ± - | | | | | | | | | | | | | | | | |
| 2 PLC | ± - | | | | | | | | | | | | | | | | |
| 3 PLC | ± - | | | | | | | | | | | | | | | | |
| 4 PLC | ± - | | | | | | | | | | | | | | | | |
| ANGLES | ± - | | | | | | | | | | | | | | | | |
| MATERIAL - | FINISH - | WEIGHT - | SIZE A3 | CAGE CODE 06090 | DRAWING NO C-R85049/89 | RESTRICTED TO - | | | | | | | | | | | |
| CUSTOMER DRAWING | | | SCALE NTS | SHEET 2 OF 3 | REV C | | | | | | | | | | | | |

THIS DRAWING IS UNPUBLISHED.

RELEASED FOR PUBLICATION

© COPYRIGHT - TE Connectivity

ALL RIGHTS RESERVED.

REVISIONS

| P | LTR | DESCRIPTION | DATE | DWN | APVD |
|---|-----|-------------|------|-----|------|
| - | - | SEE SHEET 1 | - | - | - |

TABLE I - SHELL SIZE AND DIMENSIONS

| ORDER NUMBER | SHELL SIZE | ØA MAX | ØB ±.010 ENTRY SIZE | | ØC REF | |
|--------------|------------|-------------|---------------------|-------------|------------|-------------|
| | | | 02 | 03 | 02 | 03 |
| 9 | A | .86 (21.8) | N/A | .25 (6.4) | N/A | .39 (10.0) |
| 11 | B | .98 (25.0) | N/A | .31 (7.9) | N/A | .46 (11.6) |
| 13 | C | 1.16 (29.4) | .31 (7.9) | .44 (11.1) | .46 (11.6) | .58 (14.8) |
| 15 | D | 1.28 (32.5) | .44 (11.1) | .56 (14.3) | .58 (14.8) | .71 (18.0) |
| 17 | E | 1.41 (35.7) | .50 (12.7) | .62 (15.9) | .64 (16.4) | .77 (19.6) |
| 19 | F | 1.52 (38.5) | .62 (15.9) | .75 (19.1) | .77 (19.6) | .89 (22.7) |
| 21 | G | 1.64 (41.7) | .62 (15.9) | .81 (20.6) | .77 (19.6) | .96 (24.3) |
| 23 | H | 1.77 (44.9) | .69 (17.5) | .94 (23.8) | .83 (21.1) | 1.08 (27.5) |
| 25 | J | 1.89 (48.0) | .75 (19.1) | 1.00 (25.4) | .89 (22.7) | 1.14 (29.1) |

TABLE I - SHELL SIZE AND DIMENSIONS (CONTINUED)

| ORDER NUMBER | SHELL SIZE | D MAX | E MAX | G MAX | | F REF | |
|--------------|------------|-------------|-------------|-------------|-------------|-------------|-------------|
| | | | | 02 | 03 | 02 | 03 |
| 9 | A | 1.01 (25.7) | 1.16 (29.5) | N/A | 1.97 (50.0) | N/A | 2.22 (56.3) |
| 11 | B | 1.03 (26.2) | 1.19 (30.2) | N/A | 2.03 (51.6) | N/A | 2.28 (57.9) |
| 13 | C | 1.06 (26.9) | 1.21 (30.7) | 2.08 (52.8) | 2.12 (53.9) | 2.33 (59.1) | 2.37 (60.2) |
| 15 | D | 1.08 (27.4) | 1.24 (31.5) | 2.16 (54.9) | 2.21 (56.1) | 2.41 (61.2) | 2.46 (62.4) |
| 17 | E | 1.11 (28.2) | 1.26 (32.0) | 2.23 (56.6) | 2.27 (57.7) | 2.48 (62.9) | 2.52 (64.0) |
| 19 | F | 1.12 (28.4) | 1.27 (32.3) | 2.29 (58.2) | 2.33 (59.3) | 2.54 (64.5) | 2.58 (65.6) |
| 21 | G | 1.15 (29.2) | 1.30 (33.0) | 2.34 (59.5) | 2.41 (61.2) | 2.59 (65.8) | 2.66 (67.5) |
| 23 | H | 1.17 (29.7) | 1.33 (33.8) | 2.40 (61.1) | 2.49 (63.3) | 2.65 (67.4) | 2.74 (69.6) |
| 25 | J | 1.20 (30.5) | 1.35 (34.3) | 2.47 (62.8) | 2.56 (65.0) | 2.72 (69.1) | 2.81 (71.3) |

THIS DRAWING IS A CONTROLLED DOCUMENT.

DWN C.C.THOMAS 06JUN2017

CHK E.HALEY 6-6-17

APVD E.HALEY 6-6-17

PRODUCT SPEC

APPLICATION SPEC

WEIGHT -

CUSTOMER DRAWING

DIMENSIONS:
INCHES

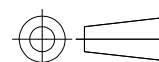

TOLERANCES UNLESS OTHERWISE SPECIFIED:

- 0 PLC ± -
- 1 PLC ± -
- 2 PLC ± -
- 3 PLC ± -
- 4 PLC ± -
- ANGLES ± -
- FINISH -

MATERIAL -



NAME BACKSHELL, 45°, SELF-LOCKING, SHIELD BAND TERMINATION, SHRINK BOOT ADAPTER

SIZE A3 CAGE CODE 06090 DRAWING NO C-R85049/89 RESTRICTED TO -

SCALE NTS SHEET 3 OF 3 REV C

Компания «Life Electronics» занимается поставками электронных компонентов импортного и отечественного производства от производителей и со складов крупных дистрибьюторов Европы, Америки и Азии.

С конца 2013 года компания активно расширяет линейку поставок компонентов по направлению коаксиальный кабель, кварцевые генераторы и конденсаторы (керамические, пленочные, электролитические), за счёт заключения дистрибьюторских договоров

Мы предлагаем:

- Конкурентоспособные цены и скидки постоянным клиентам.
- Специальные условия для постоянных клиентов.
- Подбор аналогов.
- Поставку компонентов в любых объемах, удовлетворяющих вашим потребностям.
- Приемлемые сроки поставки, возможна ускоренная поставка.
- Доставку товара в любую точку России и стран СНГ.
- Комплексную поставку.
- Работу по проектам и поставку образцов.
- Формирование склада под заказчика.
- Сертификаты соответствия на поставляемую продукцию (по желанию клиента).
- Тестирование поставляемой продукции.
- Поставку компонентов, требующих военную и космическую приемку.
- Входной контроль качества.
- Наличие сертификата ISO.

В составе нашей компании организован Конструкторский отдел, призванный помогать разработчикам, и инженерам.

Конструкторский отдел помогает осуществить:

- Регистрацию проекта у производителя компонентов.
- Техническую поддержку проекта.
- Защиту от снятия компонента с производства.
- Оценку стоимости проекта по компонентам.
- Изготовление тестовой платы монтаж и пусконаладочные работы.



Тел: +7 (812) 336 43 04 (многоканальный)

Email: org@lifeelectronics.ru