

Series 79 Micro-Crimp

Section F: Straight Printed Circuit Board Connectors

PANEL PLUGS WITH SOCKET CONTACTS, STRAIGHT PCB TERMINATION, 790-029S



Lightweight, rugged vertical mount headers feature gold-plated PC tail contacts for thru-hole printed circuit board termination. 790-029S connectors are designed for rear-panel mounting and are supplied with conductive panel gaskets. Contacts are permanently installed and are sealed with epoxy. Shells are aluminum alloy. Threaded board mounting holes and integral standoffs simplify installation. Available in 29 different contact arrangements, these connectors feature size #23 signal contacts along with #16 and #12 power contacts for up to 23 amps current rating. Optional EMI spring improves shell-to-shell conductivity and shielding performance. Stainless steel jackposts are non-removable.

HOW TO ORDER

Sample Part Number

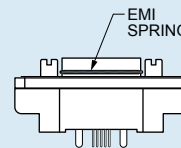
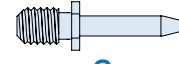
| 790-029S | K-43 | M | E | P | B |
|--|---|--|--|--|---|
| Part Number | Shell Size - Insert Arr. | Shell Finish | EMI Spring | Hardware Option | PC Tail Length |
| 790-029S Rear Panel Mounted Plug with Straight PC Tail Contacts for Termination to Backplanes or Flexible Circuits | See Table 1 for Available Insert Arrangements | M Electroless Nickel <i>general purpose applications</i> MT Nickel-PTFE <i>1000 Hour Grey™ maximum corrosion protection and durability (non-reflective grey)</i> ZNU Zinc-Nickel with Black Chromate <i>tactical applications (non-reflective black)</i> Additional shell finishes are listed on page C-9. | E EMI Spring N No Spring  |  N No Hardware G Guide Pin P Female Jackpost S Female Guide Socket | A .125 Inch (3.2 mm.) B .250 inch (6.4 mm.)  |

SPECIFICATIONS

| | |
|---------------------------------|---|
| Current Rating | #23 5 AMPS, #16 13 A., #12 23 A. |
| Dielectric Withstanding Voltage | #23 500 VAC RMS, #12 and #16 1800 VAC RMS |
| Insulation Resistance | 5000 megohms minimum |
| Operating Temperature | -65° C. to +150° C. |
| Shock | 300 g. |
| Vibration | 37 g. |

MATERIALS AND FINISHES

| | |
|--------------|--|
| Shell | Aluminum alloy |
| Contacts | Copper alloy, 50 microinches gold plated, with stainless steel hoods |
| Insulator | Liquid crystal polymer (LCP) |
| Hardware | 300 series stainless steel |
| Panel Gasket | Fluorosilicone, conductive |
| Encapsulant | Epoxy |

Dimensions in inches (millimeters) and are subject to change without notice.

© 2009 Glenair, Inc.

CAGE Code 06324

Printed in U.S.A.

GLENAIR, INC. • 1211 AIR WAY • GLENDALE, CA 91201-2497 • 818-247-6000 • FAX 818-500-9912

www.glenair.com

F-16

E-Mail: sales@glenair.com

Rev. 04-July-2009

Series 79 Micro-Crimp

Section F: Straight Printed Circuit Board Connectors



Table 1 Contact Arrangements

| Layout | Contact Quantity | #23#16#12 | Face View |
|--------|------------------|-----------|-----------|
| A-5 | 5 | | |
| B-2P2 | 2 | | |
| B-9 | 9 | | |
| C-13 | 13 | | |
| D-15 | 15 | | |
| D-3P3 | 3 | | |
| D-7P2 | 5 | 2 | |
| E-11P2 | 9 | 2 | |
| E-19 | 19 | | |
| E-7P3 | 4 | 3 | |
| F-15P2 | 13 | 2 | |
| F-23 | 23 | | |
| F-5P5 | 5 | | |
| G-33 | 33 | | |
| H-10P4 | 6 | 4 | |
| H-29P7 | 22 | 7 | |
| H-36P2 | 34 | 2 | |
| H-54P2 | 52 | 2 | |
| H-5P5 | | 5 | |
| H-66 | 66 | | |
| J-17P4 | 13 | 4 | |
| J-25P2 | 23 | 2 | |
| J-33 | 33 | | |
| J-7P7 | | 7 | |
| K-27P4 | 23 | 4 | |
| K-35P2 | 33 | 2 | |
| K-43 | 43 | | |
| K-9P9 | | 9 | |
| L-6P6 | | 6 | |

CROSS-SECTIONAL VIEW OF 790-029S

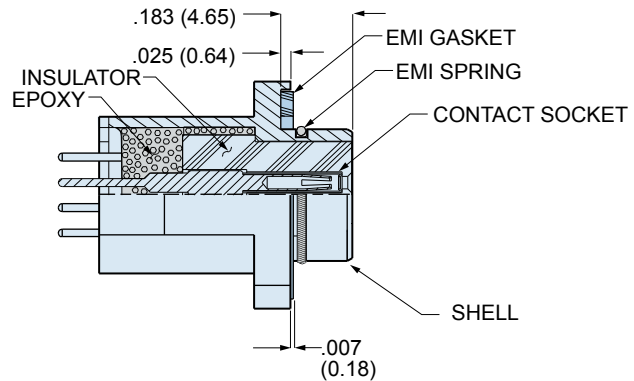
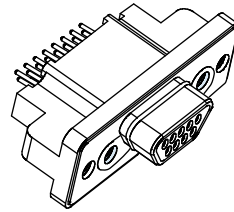

TABLE 2 HARDWARE OPTION



N

No Mating Hardware

Connector is supplied with threaded holes. Shell sizes H and L have #6-32 threads, other sizes have #4-40 threads. Thread depth is .150" (3.8).

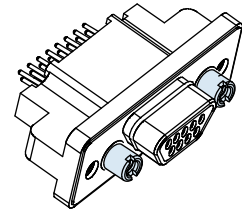

P

Jackposts

Connector is supplied with non-removable stainless steel jackposts. Shell sizes H and L have #4-40 UNC thread, other sizes have #2-56 thread.

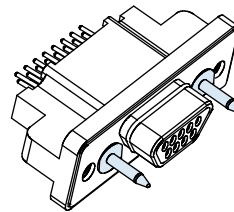

G

Guide Pins

Connector is supplied with stainless steel non-removable guide pins. Mates with type "S" guide sockets on corresponding receptacle connector.

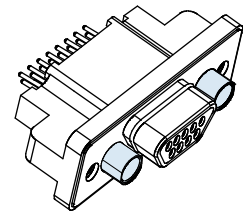

S

Guide Sockets

Connector is supplied with stainless steel non-removable bushings. Mates with type "G" guide pins on corresponding receptacle connector.

Dimensions in inches (millimeters) and are subject to change without notice.

© 2009 Glenair, Inc.

CAGE Code 06324

Printed in U.S.A.

GLENAIR, INC. • 1211 AIR WAY • GLENDALE, CA 91201-2497 • 818-247-6000 • FAX 818-500-9912

www.glenair.com

F-17

E-Mail: sales@glenair.com

Rev. 04-July-2009

790-029S SHELL SIZE A,B,C,D,E,F,J,K DIMENSIONS

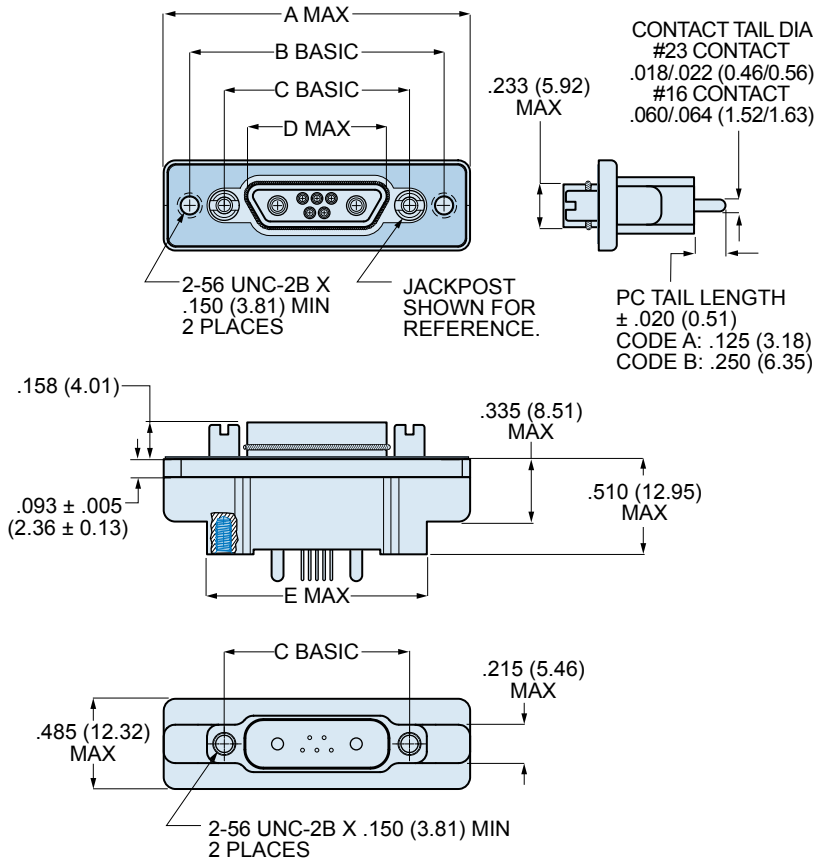

BLIND MATE

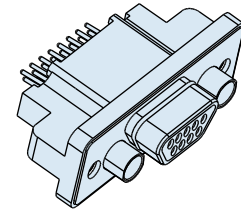

SHELL SIZES A, B, C, D, E, F, G, J, K
 +/- .030 (0.76) ALLOWABLE
 MISALIGNMENT FROM CENTERLINE

790-029S SIZE A-F, J, K DIMENSIONS

| Shell Size | A Max. | | B Basic | | C Basic | | D Max. | | E Max. | |
|------------|--------|-------|---------|-------|---------|-------|--------|-------|--------|-------|
| | In. | mm. | In. | mm. | In. | mm. | In. | mm. | In. | mm. |
| A | 1.211 | 30.76 | .925 | 23.50 | .565 | 14.35 | .335 | 8.51 | .760 | 19.30 |
| B | 1.361 | 34.57 | 1.075 | 27.31 | .715 | 18.16 | .485 | 12.32 | .910 | 21.11 |
| C | 1.511 | 38.38 | 1.225 | 31.12 | .865 | 21.97 | .635 | 16.13 | 1.060 | 26.92 |
| D | 1.611 | 40.92 | 1.325 | 33.66 | .965 | 24.51 | .735 | 18.67 | 1.160 | 29.46 |
| E | 1.761 | 44.73 | 1.475 | 37.47 | 1.115 | 28.32 | .885 | 22.48 | 1.310 | 33.27 |
| F | 1.911 | 48.54 | 1.625 | 41.28 | 1.265 | 32.13 | 1.035 | 26.29 | 1.460 | 37.08 |
| J | 2.261 | 57.43 | 1.975 | 50.17 | 1.615 | 41.02 | 1.390 | 35.31 | 1.810 | 45.97 |
| K | 2.661 | 67.59 | 2.375 | 60.33 | 2.015 | 51.18 | 1.795 | 45.59 | 2.210 | 56.13 |

Dimensions in inches (millimeters) and are subject to change without notice.

Series 79 Micro-Crimp Section F: Straight Printed Circuit Board Connectors



790-029S SHELL SIZE G DIMENSIONS

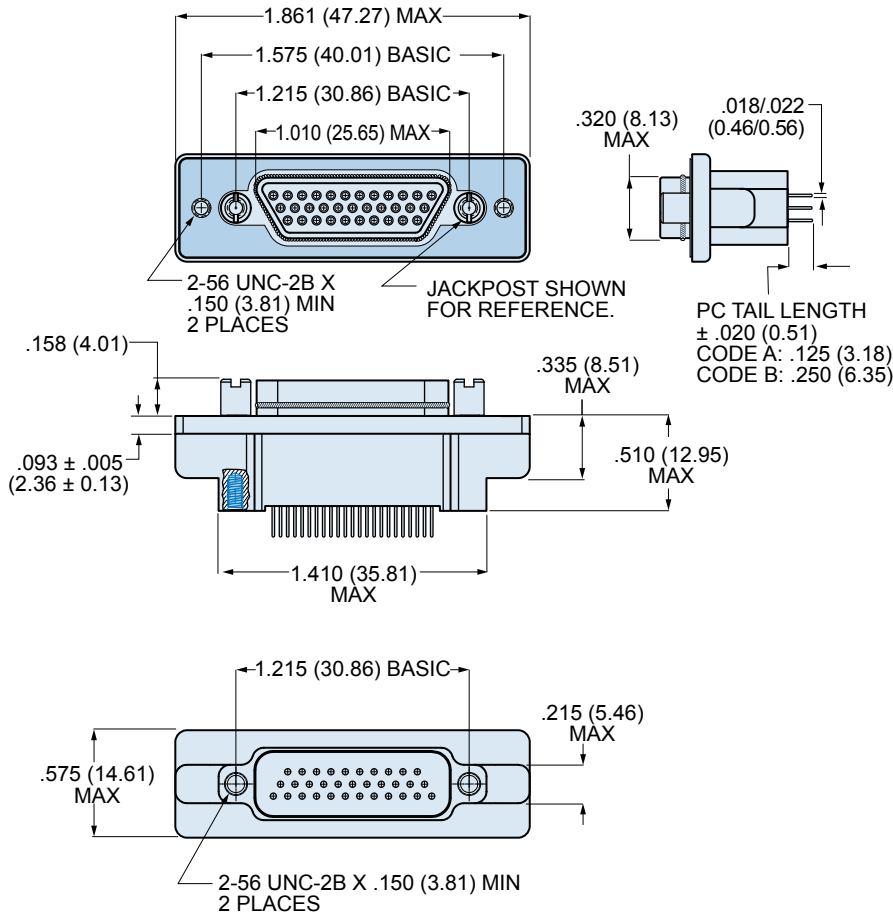

BLIND MATE

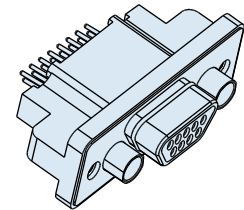

SHELL SIZES A, B, C, D, E, F, G, J, K
+/- .030 (0.76) ALLOWABLE
MISALIGNMENT FROM CENTERLINE

Dimensions in inches (millimeters) and are subject to change without notice.

790-029S SHELL SIZE H AND L DIMENSIONS

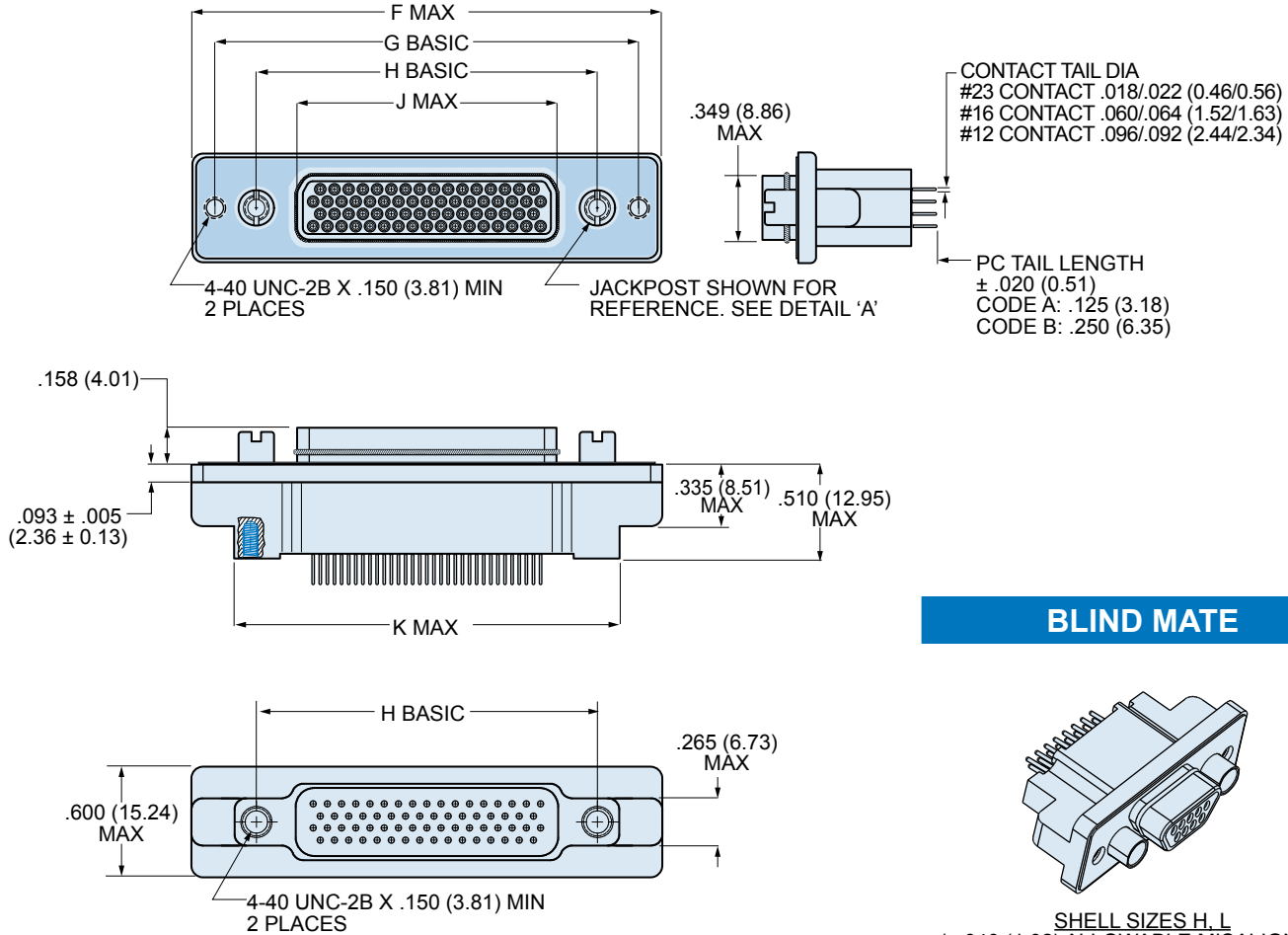

BLIND MATE

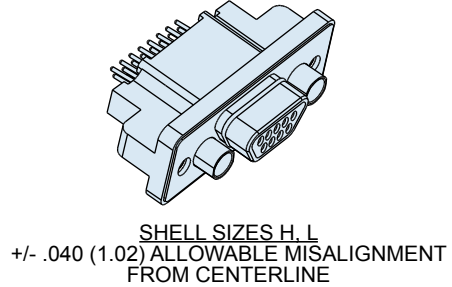

790-029S SIZE H & L DIMENSIONS

| Shell Size | F Max. | | G Basic | | H Basic | | J Max. | | K Max. | |
|------------|--------|-------|---------|-------|---------|-------|--------|-------|--------|-------|
| | In. | mm. | In. | mm. | In. | mm. | In. | mm. | In. | mm. |
| H | 2.500 | 63.50 | 2.236 | 56.79 | 1.800 | 45.72 | 1.385 | 35.18 | 2.045 | 51.94 |
| L | 2.736 | 69.49 | 2.472 | 62.79 | 2.036 | 51.71 | 1.623 | 41.22 | 2.281 | 57.94 |

Dimensions in inches (millimeters) and are subject to change without notice.

Series 79 Micro-Crimp Section F: Straight Printed Circuit Board Connectors



PCB Hole Patterns for 790-029S and 790-044S Plugs

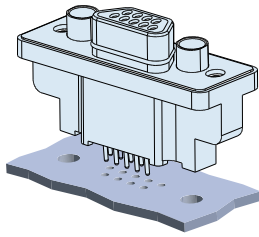

This section contains printed circuit board footprints for vertical mounted Series 79 plugs. The contact identification numbers are shown for the connector mounting side of the PC board. Contact tails are gold over nickel plated.

| Contact Size | PC Tail Diameter | |
|--------------|------------------|----------------|
| | In. | Ø Diameter mm. |
| #23 | .018-.022 | 0.46-0.56 |
| #16 | .060-.064 | 1.52-1.63 |
| #12 | .092-.096 | 2.34-2.44 |

790-029S AND 790-044S PRINTED CIRCUIT BOARD PATTERNS

| Insert Arr. | Component Mounting Side of PCB |
|-------------|--------------------------------|
| A-5 | |
| B-2P2 | |
| B-9 | |
| C-13 | |

Dimensions in inches (millimeters) and are subject to change without notice.

790-029S AND 790-044S PRINTED CIRCUIT BOARD PATTERNS

| Insert Arr. | Component Mounting Side of PCB |
|-------------|--------------------------------|
| D-15 | |
| D-3P3 | |
| D-7P2 | |
| E-11P2 | |
| E-19 | |

Dimensions in inches (millimeters) and are subject to change without notice.

Series 79 Micro-Crimp Section F: Straight Printed Circuit Board Connectors



790-029S AND 790-044S PRINTED CIRCUIT BOARD PATTERNS

| Insert Arr. | Component Mounting Side of PCB |
|-------------|--------------------------------|
| E-7P3 | |
| F-15P2 | |
| F-23 | |
| F-5P5 | |
| G-33 | |

Dimensions in inches (millimeters) and are subject to change without notice.

790-029S AND 790-044S PRINTED CIRCUIT BOARD PATTERNS

| Insert Arr. | Component Mounting Side of PCB |
|-------------|--------------------------------|
| H-10P4 | |
| H-29P7 | |
| H-36P2 | |
| H-54P2 | |
| H-5P5 | |

Dimensions in inches (millimeters) and are subject to change without notice.

Series 79 Micro-Crimp

Section F: Straight Printed Circuit Board Connectors



790-029S AND 790-044S PRINTED CIRCUIT BOARD PATTERNS

| Insert Arr. | Component Mounting Side of PCB |
|-------------|--------------------------------|
| H-66 | |
| J-17P4 | |
| J-25P2 | |
| J-33 | |
| J-7P7 | |

Dimensions in inches (millimeters) and are subject to change without notice.

790-029S AND 790-044S PRINTED CIRCUIT BOARD PATTERNS

| Insert Arr. | Component Mounting Side of PCB |
|-------------|--|
| K-27P4 | <p>Dimensions: .595 (15.11), .4325 (10.99), .2575 (6.54), 2.015 (51.18), .0375 (0.95) TYP, .075 (1.91) TYP, 1.150 (29.21), 1.500 (38.1), .0325 (0.83) TYP, .065 (1.65) TYP.</p> <p>Notes: (HOLE TO ACCEPT .022 (0.56) MAX DIA CONTACT 23x), (HOLE TO ACCEPT .064 (1.63) MAX DIA CONTACT 4x), $\phi \varnothing .003 \text{ (M) (A)}$.</p> |
| K-35P2 | <p>Dimensions: .2575 (6.54), .4075 (10.35), 2.015 (51.18), .075 (1.91) TYP, 1.500 (38.1), .0325 (0.83) TYP, .065 (1.65) TYP.</p> <p>Notes: (HOLE TO ACCEPT .022 (0.56) MAX DIA CONTACT 33x), (HOLE TO ACCEPT .064 (1.63) MAX DIA CONTACT 2x), $\phi \varnothing .003 \text{ (M) (A)}$.</p> |
| K-43 | <p>Dimensions: .220 (5.59), 2.015 (51.18), .075 (1.91) TYP, .0375 (0.95) TYP, .065 (1.65) TYP, .0325 (0.83) TYP.</p> <p>Notes: (HOLE TO ACCEPT .022 (0.56) MAX DIA CONTACT 43x), $\phi \varnothing .003 \text{ (M) (A)}$.</p> |
| K-9P9 | <p>Dimensions: .3075 (7.81), .175 (4.45), 2.015 (51.18).</p> <p>Notes: (HOLE TO ACCEPT .064 (1.63) MAX DIA CONTACT 9), $\phi \varnothing .003 \text{ (M) (A)}$.</p> |
| L-6P6 | <p>Dimensions: .428 (10.87), .236 (5.99) 5x, 2.036 (51.71).</p> <p>Notes: (HOLE TO ACCEPT .096 (2.44) MAX DIA CONTACT 6x), $\phi \varnothing .003 \text{ (M) (A)}$.</p> |

Dimensions in inches (millimeters) and are subject to change without notice.

Компания «Life Electronics» занимается поставками электронных компонентов импортного и отечественного производства от производителей и со складов крупных дистрибьюторов Европы, Америки и Азии.

С конца 2013 года компания активно расширяет линейку поставок компонентов по направлению коаксиальный кабель, кварцевые генераторы и конденсаторы (керамические, пленочные, электролитические), за счёт заключения дистрибьюторских договоров

Мы предлагаем:

- Конкуренспособные цены и скидки постоянным клиентам.
- Специальные условия для постоянных клиентов.
- Подбор аналогов.
- Поставку компонентов в любых объемах, удовлетворяющих вашим потребностям.
- Приемлемые сроки поставки, возможна ускоренная поставка.
- Доставку товара в любую точку России и стран СНГ.
- Комплексную поставку.
- Работу по проектам и поставку образцов.
- Формирование склада под заказчика.
- Сертификаты соответствия на поставляемую продукцию (по желанию клиента).
- Тестирование поставляемой продукции.
- Поставку компонентов, требующих военную и космическую приемку.
- Входной контроль качества.
- Наличие сертификата ISO.

В составе нашей компании организован Конструкторский отдел, призванный помогать разработчикам, и инженерам.

Конструкторский отдел помогает осуществить:

- Регистрацию проекта у производителя компонентов.
- Техническую поддержку проекта.
- Защиту от снятия компонента с производства.
- Оценку стоимости проекта по компонентам.
- Изготовление тестовой платы монтаж и пусконаладочные работы.



Тел: +7 (812) 336 43 04 (многоканальный)

Email: org@lifeelectronics.ru