

## Compatible Flexible LED Strips

### NORMAL Bright

Product Code: **NB-WW-12M**



**30 White LEDs per Meter 12V** (9 LEDs per foot)  
LED Spacing: 1.31" Reel Length: 12M  
Cut Points: Every 4"  
Color Temperature: (Warm) ~3000K (Pure) ~4200K (Cool) ~6000K  
Lumen/Power Output: 100lm per Watt, **1W per foot**

Ideal for above cabinets, coves, and ceiling trays.  
 Recommended for use as accent light, not primary light source.

### SUPER Bright

Product Code: **SBWW-12M**



**60 White LEDs per Meter 12V** (18 LEDs per foot)  
LED Spacing: 0.66" Reel Length: 12M  
Cut Points: Every 1.97"  
Color Temperature: (Warm) ~3000K (Pure) ~4200K (Cool) ~6000K  
Lumen/Power Output: 100lm per Watt, **2W per foot**

**Best Value.** Great for accent lighting and low level task lighting.  
 Ideal for under cabinet, and display cabinets.

### ULTRA Bright

Product Code: **UBWW-12M**



**99 White LEDs per Meter 12V** (30 LEDs per foot)  
LED Spacing: 0.39" Reel Length: 12M  
Cut Points: Every 1.18"  
Color Temperature: (Warm) ~3000K (Pure) ~4200K (Cool) ~6000K  
Lumen/Power Output: 100lm per Watt, **3.2W per foot**

Perfect for task lighting applications. Most commonly used for under cabinets, garages, safes and jewelry cases. Excellent for restaurant and retail.

### MEGA Bright

Product Code: **MBWW- 12M**



**120 White LEDs per Meter 12V or 24V** (36 LEDs per foot)  
LED Spacing: 0.33" Reel Length: 12M  
Cut Points: Every 1.97"  
Color Temperature: (Warm) ~3000K (Pure) ~4200K (Cool) ~6000K  
Lumen/Power Output: 100lm per Watt, **4W per foot**

Use when too much light is just right.

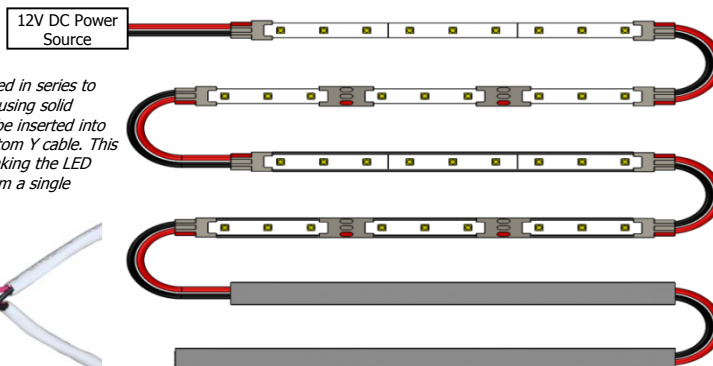

**NOTE:** Products can be used in series to create an LED system. When using solid 22AWG wire, two cables can be inserted into the connector to create a custom Y cable. This is extremely useful when breaking the LED system into two directions from a single connector.

## Solderless Wire Lock Connector:



**Size:** 0.42" x 0.63" x 0.19"  
**Screw Terminal Size:** Fits 18-24AWG  
**Quantity:** Sold in sets of 25, includes 5 LED Strip extenders  
 Product Code: **3563**

Ideal for making custom length flex strips in the field.  
 Perfect for contractors and electricians. Input terminals work with **18-22AWG solid strand cable.**

- Termination for Inspired LED Flex Strips only
- 5 IDEA Series Connectors and 1 Flexible LED Strip Extenders included in each flexible LED Strip reel.
- To be used for in indoor applications
- Allows for assembly and testing before installation
- Does not require the use of a soldering iron

**STEP 1:** Open connector locking cap.



**STEP 2:** Peel adhesive liner from flexible LED strip.



**STEP 3:** Insert flexible LED strip into LED input channel of connector.



**STEP 4:** Close locking cap until the snap of the connector is heard. The snapping sound indicates the locking cap has been properly terminated.



**STEP 5:** Identify polarity on LED strip. Polarity is marked throughout the length of the flexible LED strip. Use a red sharpie to mark polarity on connector.



**STEP 6:** Strip 18-22AWG cable and match polarity between LED connector and cable.



**STEP 7:** Poke cable leads into wire holes of connector making sure the positive polarity matches the positive input hole of connector.



**NOTE:** Connectors are not assigned polarity. Polarity must be defined by user. Look throughout the length of the strip to identify polarity, it may not be indicated exactly at each cut point. Check termination by tugging on the cable leads and LED flex to insure tight connections. Cable should be difficult to remove when properly terminated.

# iDea Series LED Extrusion w/ Lens – LED Panels

## Extrusion w/ Lens

Aluminum Channel (6'): **3565**  
 Polycarbonate Covers (6'): **3566**  
 Mounting Clips/Screws (10/bag): **3567**  
 Black Clips/Screws (10/bag): **4774**



## LED Panels on Demand

Flexible LED Strip: Fits *Normal, Super, Ultra* and *Mega Bright* Flex Strips

Aluminum Extrusion Channel: 0.14" x 0.41" x 72"

Polycarbonate Covers/Lens: 0.22" x 0.5" x 72"

Lens Colors: White (Frosted) or Clear

Color Temperature: (Warm) ~3000K (Pure) 4200K (Cool) 6000K

Mounting: Metal or Plastic Mounting Clips

Create custom low profile panels within minutes.

- All panel materials are optional and sold separately
- Tiny, light weight construction
- Provides a beautiful finished look
- Allows for in-field assembly and testing before installation
- Does not require the use of a soldering iron or heavy machinery

## iDea Series LED Extrusion w/ Lens Assembly

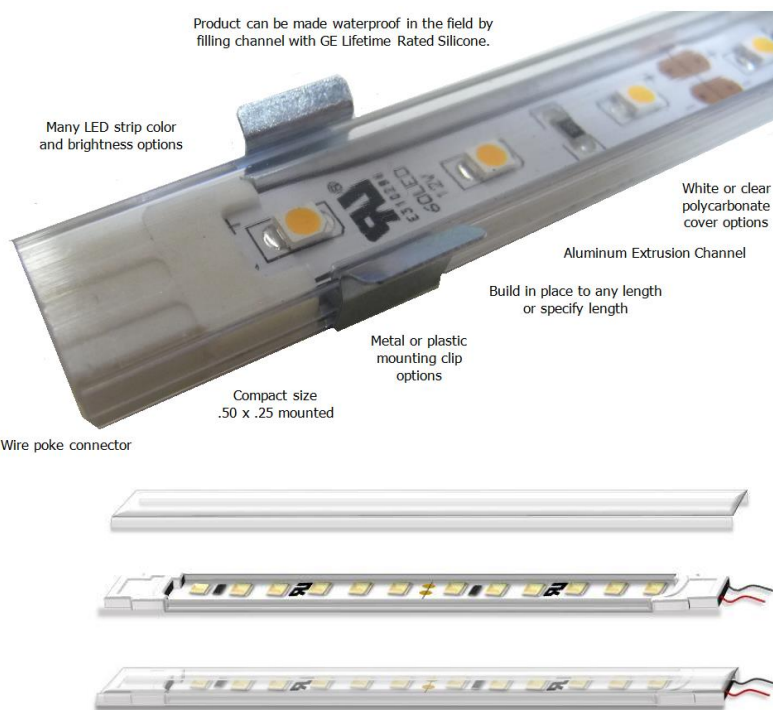
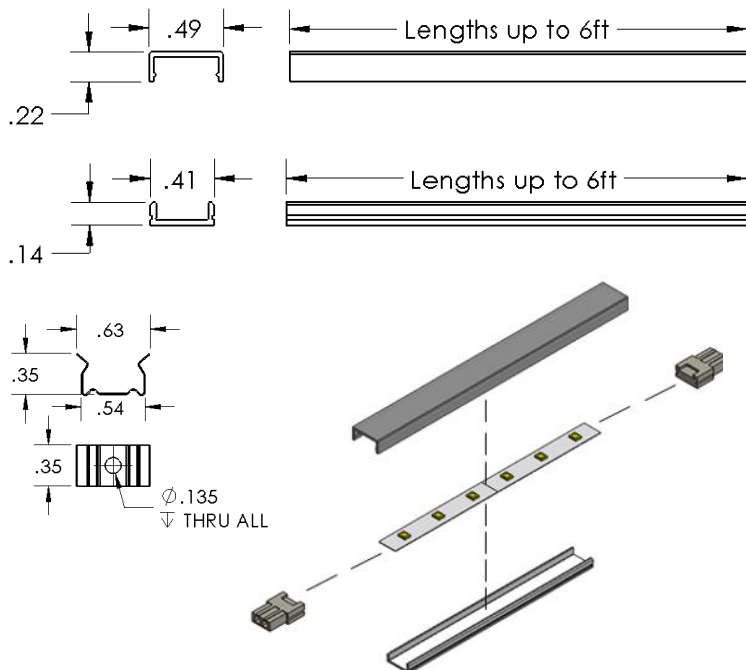

## Solderless Flexible LED Strip Extender

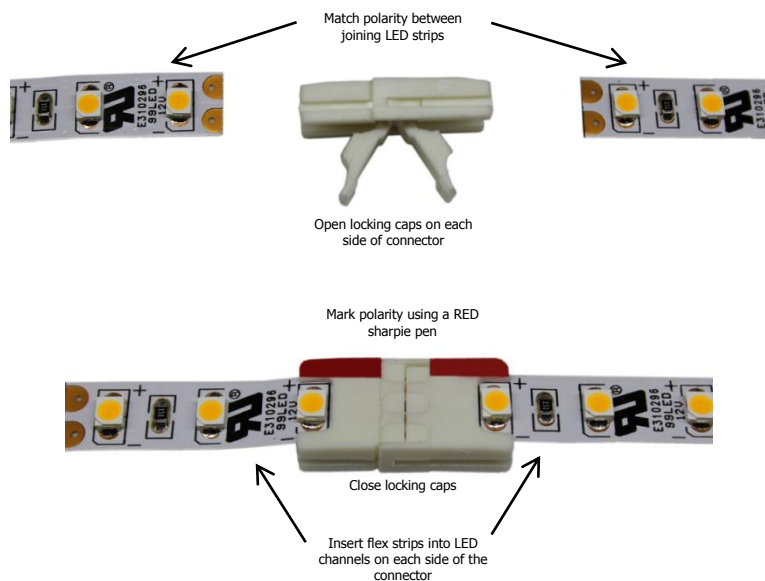

## iDea Series Connector Sets

Each **Inspired LED 12M LED Flexible Strip Reel** includes 5 IDEA Series Connectors and 1 Flexible Strip Extender.



IDEA Series Connectors are sold in 30 piece sets.  
**25 Wire Lock Connectors + 5 Flex Extenders**

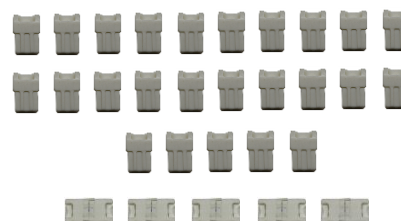

Компания «Life Electronics» занимается поставками электронных компонентов импортного и отечественного производства от производителей и со складов крупных дистрибьюторов Европы, Америки и Азии.

С конца 2013 года компания активно расширяет линейку поставок компонентов по направлению коаксиальный кабель, кварцевые генераторы и конденсаторы (керамические, пленочные, электролитические), за счёт заключения дистрибьюторских договоров

Мы предлагаем:

- Конкурентоспособные цены и скидки постоянным клиентам.
- Специальные условия для постоянных клиентов.
- Подбор аналогов.
- Поставку компонентов в любых объемах, удовлетворяющих вашим потребностям.
- Приемлемые сроки поставки, возможна ускоренная поставка.
- Доставку товара в любую точку России и стран СНГ.
- Комплексную поставку.
- Работу по проектам и поставку образцов.
- Формирование склада под заказчика.
- Сертификаты соответствия на поставляемую продукцию (по желанию клиента).
- Тестирование поставляемой продукции.
- Поставку компонентов, требующих военную и космическую приемку.
- Входной контроль качества.
- Наличие сертификата ISO.

В составе нашей компании организован Конструкторский отдел, призванный помогать разработчикам, и инженерам.

Конструкторский отдел помогает осуществить:

- Регистрацию проекта у производителя компонентов.
- Техническую поддержку проекта.
- Защиту от снятия компонента с производства.
- Оценку стоимости проекта по компонентам.
- Изготовление тестовой платы монтаж и пусконаладочные работы.



Тел: +7 (812) 336 43 04 (многоканальный)

Email: [org@lifeelectronics.ru](mailto:org@lifeelectronics.ru)