

"Stay Connected" with



HEYware Products

a PennEngineering® Company



HEYClip™ Snap Rivets

- Designed for **fast and easy installation with no tools** - just fingertip pressure required.
- Simply place rivet into the hole and press down on the head to fasten; legs expand to securely fasten components.
- To release, simply pull up on rivet head section.
- Round head provides a clean, finished look.
- Part Description Key: PR X-Y where X = Mounting Hole Diameter (inches) and Y = minimum Panel Thickness (inches).
- Standard Material: Nylon 6. Nylon 6/6 UL 94V-0 available by special order, consult Heyco.
- Standard Pack - 1,000/bag.

| WILL FIT THESE PANELS | | | | PART NO. | | | DESCRIPTION | PART DIMENSIONS | | | | | | EXTRACTION FORCE | | | |
|-----------------------|-----|---------------------------|----------|----------|-------|--------------|--------------|-----------------|------------|---------------|------|-----------------|-----|------------------|-------|-----|-------------|
| MOUNTING HOLE DIA. | | ASSEMBLED PANEL THICKNESS | | Black | White | V-0 Black * | | A Length | | B Head Height | | C Head Diameter | | N | Style | | |
| in. | mm. | Min. in. | Max. mm. | | | | | in. | mm. | in. | mm. | in. | mm. | | | in. | mm. |
| PR Series | | | | | | | | | | | | | | | | | |
| .083 | 2,1 | .02 | 0,5 | .05 | 1,3 | 9296 | 9297 | 9296F | PR 083-024 | .10 | 2,5 | | | | | | |
| | | .05 | 1,3 | .08 | 2,0 | 9300 | 9301 | 9300F | PR 083-051 | .13 | 3,3 | | | | | | |
| | | .08 | 2,0 | .11 | 2,8 | 9302 | 9303 | 9302F | PR 083-083 | .16 | 4,1 | | | | | | |
| | | .11 | 2,8 | .14 | 3,6 | 9304 | 9305 | 9304F | PR 083-114 | .19 | 4,8 | .05 | 1,3 | .17 | 4,3 | 29 | 2 |
| | | .15 | 3,8 | .17 | 4,3 | 9306 | 9307 | 9306F | PR 083-146 | .22 | 5,6 | | | | | | |
| | | .17 | 4,3 | .20 | 5,1 | 9308 | 9309 | 9308F | PR 083-173 | .25 | 6,4 | | | | | | |
| .102 | 2,6 | .04 | 1,0 | .08 | 2,0 | 9020 | 9021 | 9020F | PR 102-039 | .13 | 3,3 | | | | | | |
| | | .08 | 2,0 | .12 | 3,0 | 9022 | 9023 | 9022F | PR 102-082 | .17 | 4,3 | | | | | | |
| | | .11 | 2,8 | .14 | 3,6 | 9024 | 9025 | 9024F | PR 102-106 | .19 | 4,8 | | | | | | |
| | | .13 | 3,3 | .17 | 4,3 | 9026 | 9027 | 9026F | PR 102-134 | .22 | 5,6 | .06 | 1,5 | .20 | 5,1 | 49 | 2 |
| | | .17 | 4,3 | .21 | 5,3 | 9310 | 9311 | 9310F | PR 102-169 | .25 | 6,4 | | | | | | |
| | | .20 | 5,1 | .24 | 6,1 | 9312 | 9313 | 9312F | PR 102-201 | .28 | 7,1 | | | | | | |
| .106 | 2,7 | .13 | 3,3 | .17 | 4,3 | 19000 | 19001 | 19000F | PR 106-133 | .23 | 5,8 | .06 | 1,5 | .20 | 5,1 | 49 | NEW! |
| .118 | 3,0 | .14 | 3,5 | .18 | 4,6 | 19002 | 19003 | 19002F | PR 118-137 | .30 | 7,6 | .07 | 1,8 | .24 | 6,1 | 122 | NEW! |
| | | .14 | 3,5 | .22 | 5,6 | 19004 | 19005 | 19004F | PR 118-138 | .31 | 7,9 | .06 | 1,5 | .24 | 6,1 | | NEW! |
| .122 | 3,1 | .04 | 1,0 | .08 | 2,0 | 9028 | 9029 | 9028F | PR 122-039 | .14 | 3,5 | | | | | | |
| | | .08 | 2,0 | .12 | 3,0 | 9030 | 9031 | 9030F | PR 122-079 | .18 | 4,6 | | | | | | |
| | | .12 | 3,0 | .16 | 4,1 | 9032 | 9033 | 9032F | PR 122-118 | .22 | 5,6 | | | | | | |
| | | .16 | 4,1 | .19 | 4,8 | 9034 | 9035 | 9034F | PR 122-157 | .26 | 6,6 | | | | | | |
| | | .20 | 5,1 | .24 | 6,1 | 9036 | 9037 | 9036F | PR 122-197 | .30 | 7,6 | | | | | | |
| | | .22 | 5,5 | .26 | 6,6 | 9038 | 9039 | 9038F | PR 122-217 | .32 | 8,1 | .06 | 1,5 | .25 | 6,4 | 78 | 2 |
| | | .26 | 6,6 | .30 | 7,6 | 9040 | 9041 | 9040F | PR 122-256 | .35 | 8,9 | | | | | | |
| | | .30 | 7,6 | .34 | 8,6 | 9042 | 9043 | 9042F | PR 122-295 | .39 | 9,9 | | | | | | |
| | | .45 | 11,4 | .51 | 13,0 | 9314 | 9315 | 9314F | PR 122-453 | .57 | 14,5 | | | | | | |
| | | .81 | 20,6 | .85 | 21,6 | 9316 | 9317 | 9316F | PR 122-807 | .91 | 23,1 | | | | | | |
| .142 | 3,6 | .05 | 1,3 | .08 | 2,0 | 9044 | 9045 | 9044F | PR 142-047 | .14 | 3,5 | | | | | | |
| | | .08 | 2,0 | .12 | 3,0 | 9046 | 9047 | 9046F | PR 142-083 | .18 | 4,6 | | | | | | |
| | | .11 | 2,8 | .14 | 3,6 | 9048 | 9049 | 9048F | PR 142-106 | .20 | 5,1 | | | | | | |
| | | .12 | 3,0 | .16 | 4,1 | 9050 | 9051 | 9050F | PR 142-118 | .22 | 5,6 | .06 | 1,5 | .25 | 6,4 | 118 | 1 |
| | | .15 | 3,8 | .18 | 4,6 | 9052 | 9053 | 9052F | PR 142-146 | .24 | 6,1 | | | | | | |
| | | .18 | 4,6 | .22 | 5,6 | 9054 | 9055 | 9054F | PR 142-177 | .28 | 7,1 | | | | | | |
| .157 | 4,0 | .09 | 2,3 | .11 | 2,8 | 19006 | 19007 | 19006F | PR 157-086 | .22 | 5,6 | .08 | 2,0 | .31 | 7,9 | 196 | 1 |
| | | .21 | 5,3 | .24 | 6,1 | 19008 | 19009 | 19008F | PR 157-212 | .31 | 7,9 | .07 | 1,8 | .32 | 8,1 | | NEW! |
| | | .41 | 10,4 | .45 | 11,4 | 19010 | 19011 | 19010F | PR 157-413 | .53 | 13,5 | .08 | 2,0 | .31 | 7,9 | 196 | 2 |
| | | | | | | | | | | | | | | | | | NEW! |
| .161 | 4,1 | .10 | 2,5 | .14 | 3,5 | 9058 | 9059 | 9058F | PR 161-098 | .20 | 5,1 | | | | | | |
| | | .14 | 3,5 | .18 | 4,6 | 9060 | 9061 | 9060F | PR 161-138 | .24 | 6,1 | | | | | | |
| | | .18 | 4,6 | .22 | 5,6 | 9062 | 9063 | 9062F | PR 161-177 | .28 | 7,1 | | | | | | |
| | | .22 | 5,6 | .26 | 6,6 | 9064 | 9065 | 9064F | PR 161-217 | .32 | 8,1 | | | | | | |
| | | .26 | 6,6 | .30 | 7,6 | 9066 | 9067 | 9066F | PR 161-256 | .35 | 8,9 | .07 | 1,8 | .32 | 8,1 | 196 | 1 |
| | | .30 | 7,6 | .34 | 8,6 | 9068 | 9069 | 9068F | PR 161-295 | .39 | 9,9 | | | | | | |
| | | .35 | 8,9 | .41 | 10,4 | 9318 | 9319 | 9318F | PR 161-354 | .47 | 11,9 | | | | | | |
| | | .49 | 12,4 | .55 | 14,0 | 9320 | 9321 | 9320F | PR 161-492 | .61 | 15,5 | | | | | | |

Available in Small Packs



| PART NO. | | DESCRIPTION | QTY |
|---------------|---------------|------------------|-----|
| Black | White | | |
| 9028-P | 9029-P | PR 122-039 100PK | 100 |
| 9030-P | 9031-P | PR 122-079 100PK | |
| 9032-P | 9033-P | PR 122-118 100PK | |
| 9034-P | 9035-P | PR 122-157 100PK | |
| 9036-P | 9037-P | PR 122-197 100PK | |
| 9038-P | 9039-P | PR 122-217 100PK | |
| 9058-P | 9059-P | PR 161-098 50PK | 50 |
| 9060-P | 9061-P | PR 161-138 50PK | |
| 9062-P | 9063-P | PR 161-177 50PK | |
| 9064-P | 9065-P | PR 161-217 50PK | |
| 9066-P | 9067-P | PR 161-256 50PK | |
| 9068-P | 9069-P | PR 161-295 50PK | |
| 9074-P | 9075-P | PR 201-138 50PK | |
| 9076-P | 9077-P | PR 201-177 50PK | |
| 9078-P | 9079-P | PR 201-217 50PK | |
| 9080-P | 9081-P | PR 201-256 50PK | |
| 9082-P | 9083-P | PR 201-295 50PK | |
| 9084-P | 9085-P | PR 240-098 20PK | 20 |
| 9324-P | 9325-P | PR 240-138 20PK | |

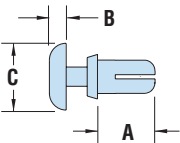

STYLE 1



STYLE 2



Quick Specs

Standard colors black and white.
*Black nylon 6/6 UL 94V-0.

| | |
|---------------------|--------------------------------|
| Material | Nylon 6 UL V-2 |
| Flammability Rating | 94V-2 |
| Temperature Range | -40°F (-40°C) to 239°F (115°C) |

“Stay Connected” with



HEYware Products

a PennEngineering® Company



HEYClip™ Snap Rivets – continued

| WILL FIT THESE PANELS | | | | PART NO. | | | DESCRIPTION | PART DIMENSIONS | | | | | | EXTRACTION FORCE | | | |
|-----------------------|---------------------------|-----|-------|----------|-------------|----------|-------------|-----------------|------------|-----------------|------|-----|-------|------------------|------|-----|---|
| MOUNTING HOLE DIA. | ASSEMBLED PANEL THICKNESS | | Black | White | V-0 Black * | A Length | | B Head Height | | C Head Diameter | | N | Style | | | | |
| | in. | mm. | | | | | Min. | Max. | in. | mm. | in. | | | mm. | in. | mm. | |
| PR Series | | | | | | | | | | | | | | | | | |
| .201 | 5,1 | .06 | 1,5 | .10 | 2,5 | 9070 | 9071 | 9070F | PR 201-059 | .18 | 4,6 | | | | | 245 | 1 |
| | | .10 | 2,5 | .14 | 3,5 | 9072 | 9073 | 9072F | PR 201-098 | .22 | 5,6 | | | | | | |
| | | .14 | 3,5 | .18 | 4,6 | 9074 | 9075 | 9074F | PR 201-138 | .26 | 6,6 | | | | | | |
| | | .18 | 4,6 | .22 | 5,6 | 9076 | 9077 | 9076F | PR 201-177 | .30 | 7,6 | .09 | 2,3 | .35 | 8,9 | | |
| | | .22 | 5,6 | .26 | 6,6 | 9078 | 9079 | 9078F | PR 201-217 | .34 | 8,6 | | | | | | |
| | | .26 | 6,6 | .30 | 7,6 | 9080 | 9081 | 9080F | PR 201-256 | .37 | 9,4 | | | | | | |
| | | .30 | 7,6 | .34 | 8,6 | 9082 | 9083 | 9082F | PR 201-295 | .41 | 10,4 | | | | | | |
| .232 | 5,9 | .12 | 3,0 | .16 | 4,1 | 9322 | 9323 | 9322F | PR 232-118 | .25 | 6,4 | .11 | 2,8 | .47 | 11,9 | | |
| .240 | 6,1 | .10 | 2,5 | .16 | 4,1 | 9084 | 9085 | 9084F | PR 240-098 | .24 | 6,1 | .10 | 2,5 | | | 294 | |
| | | .14 | 3,5 | .22 | 5,6 | 9324 | 9325 | 9324F | PR 240-138 | .32 | 8,1 | .12 | 3,0 | | | | |

Standard colors black and white.

*Black nylon 6/6 UL 94V-0.

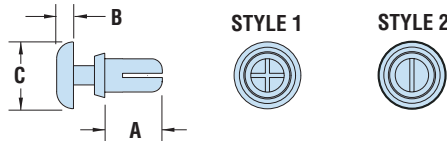

- Designed for **fast and easy installation with no tools** - just fingertip pressure required.
- Simply place rivet into the hole and press down on the head to fasten; legs expand to securely fasten components.
- To release, simply pull up on rivet head section.
- Round head provides a clean, finished look.
- Part Description Key: PR X-Y where X = Mounting Hole Diameter (inches) and Y = minimum Panel Thickness (inches).
- Standard Material: Nylon 6. Nylon 6/6 UL 94V-0 available by special order, consult Heyco.
- Standard Pack - 1,000/bag.
- See Quick Specs on opposite page.

HEYClip™ Heat Resistant Snap Rivets

| WILL FIT THESE PANELS | | | | PART NO. | | | DESCRIPTION | PART DIMENSIONS | | | | | | EXTRACTION FORCE | |
|-----------------------|---------------------------|-----|-----------------------|----------|-------------------|----------|-------------------|-----------------|------|-----------------|-----|-----|-------|------------------|-----|
| MOUNTING HOLE DIA. | ASSEMBLED PANEL THICKNESS | | Tan Nylon 4/6 UL94V-2 | Tan | Nylon 4/6 UL94V-2 | A Length | | B Head Height | | C Head Diameter | | N | Style | | |
| | in. | mm. | | | | | Min. | Max. | in. | mm. | in. | | | mm. | in. |
| PR Tan Series | | | | | | | | | | | | | | | |
| .122 | 3,1 | .04 | 1,0 | .08 | 2,0 | 9028H | PR 122-039 HR Tan | .14 | 3,5 | | | | | 78 | 2 |
| | | .08 | 2,0 | .12 | 3,0 | 9030H | PR 122-079 HR Tan | .18 | 4,5 | | | | | | |
| | | .12 | 3,0 | .16 | 4,0 | 9032H | PR 122-118 HR Tan | .22 | 5,6 | .06 | 1,6 | .25 | 6,4 | | |
| | | .16 | 4,0 | .19 | 5,0 | 9034H | PR 122-157 HR Tan | .26 | 6,5 | | | | | | |
| | | .22 | 5,5 | .26 | 6,5 | 9038H | PR 122-217 HR Tan | .32 | 8,0 | | | | | | |
| .142 | 3,6 | .05 | 1,2 | .08 | 2,1 | 9044H | PR 142-047 HR Tan | .14 | 3,5 | | | | | 118 | 1 |
| | | .08 | 2,1 | .12 | 3,0 | 9046H | PR 142-083 HR Tan | .18 | 4,5 | | | | | | |
| | | .11 | 2,7 | .14 | 3,6 | 9048H | PR 142-106 HR Tan | .20 | 5,0 | .06 | 1,6 | .25 | 6,4 | | |
| | | .12 | 3,0 | .16 | 4,0 | 9050H | PR 142-118 HR Tan | .22 | 5,6 | | | | | | |
| .161 | 4,1 | .10 | 2,5 | .14 | 3,5 | 9058H | PR 161-098 HR Tan | .20 | 5,0 | | | | | 196 | 1 |
| | | .14 | 3,5 | .18 | 4,5 | 9060H | PR 161-138 HR Tan | .24 | 6,0 | | | | | | |
| | | .18 | 4,5 | .22 | 5,5 | 9062H | PR 161-177 HR Tan | .28 | 7,0 | .07 | 1,8 | .32 | 8,0 | | |
| | | .22 | 5,5 | .26 | 6,5 | 9064H | PR 161-217 HR Tan | .32 | 8,0 | | | | | | |
| | | .30 | 7,5 | .34 | 8,5 | 9068H | PR 161-295 HR Tan | .39 | 10,0 | | | | | | |

Standard color tan (beige).



- Molded from Nylon 4/6 94V-2 - **heat resistant to 266°F (130°C)**.
- Automotive **tan** (beige) color.
- Designed for fast and easy installation with no tools - just fingertip pressure required.
- Simply place rivet into the hole and press down on the head to fasten; legs expand to securely fasten components.
- Part Description Key: PR X-Y where X = Mounting Hole Diameter (inches) and Y = minimum Panel Thickness (inches).
- Standard Pack - 1,000/bag.

Material Nylon 4/6
 Flammability Rating 94V-2
 Temperature Range -4°F (-18°C) to 266°F (130°C)

Quick Specs

Компания «Life Electronics» занимается поставками электронных компонентов импортного и отечественного производства от производителей и со складов крупных дистрибьюторов Европы, Америки и Азии.

С конца 2013 года компания активно расширяет линейку поставок компонентов по направлению коаксиальный кабель, кварцевые генераторы и конденсаторы (керамические, пленочные, электролитические), за счёт заключения дистрибьюторских договоров

Мы предлагаем:

- Конкуренеспособные цены и скидки постоянным клиентам.
- Специальные условия для постоянных клиентов.
- Подбор аналогов.
- Поставку компонентов в любых объемах, удовлетворяющих вашим потребностям.
- Приемлемые сроки поставки, возможна ускоренная поставка.
- Доставку товара в любую точку России и стран СНГ.
- Комплексную поставку.
- Работу по проектам и поставку образцов.
- Формирование склада под заказчика.
- Сертификаты соответствия на поставляемую продукцию (по желанию клиента).
- Тестирование поставляемой продукции.
- Поставку компонентов, требующих военную и космическую приемку.
- Входной контроль качества.
- Наличие сертификата ISO.

В составе нашей компании организован Конструкторский отдел, призванный помогать разработчикам, и инженерам.

Конструкторский отдел помогает осуществить:

- Регистрацию проекта у производителя компонентов.
- Техническую поддержку проекта.
- Защиту от снятия компонента с производства.
- Оценку стоимости проекта по компонентам.
- Изготовление тестовой платы монтаж и пусконаладочные работы.



Тел: +7 (812) 336 43 04 (многоканальный)

Email: org@lifeelectronics.ru