

4S1 & 4SS-Series

Sub-Miniature & **Sealed** Sub-Miniature Slide Switches

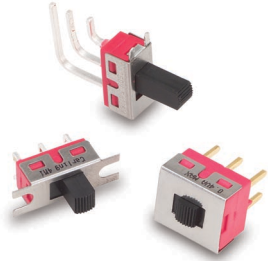

4M1-Series

Miniature Slide Switch

Specifications

Contact Rating refer to ordering scheme
 Electrical Life 30,000 make & break cycles at full load
 Contact Resistance. 10 mΩ max. initial @ 2-4 VDC
 100mA for both silver & gold plated contacts.
 Insulation Resistance 1000 MΩ min.
 Dielectric Strength 1500 Volts RMS @ sea level
 Operating Temperature . . . -30°C to +85°C
 Solder Heat Resistance. . . MIL-STD-202, Method 210
 Actuator Travel 25°

Materials

Case Diallyl phthalate (DAP) (UL 94V-0)
 Slide Handle. Nylon
 Housing. Stainless Steel
 Terminal Seal Epoxy

4S1-Series Ordering Scheme



1 SERIES 4S1 Sub-Miniature Slide Switch			
2 POLES FSP single pole			
3 CIRCUIT			
Switching Position:			
1	2-1	OPEN	2-3
3	ON	NONE	ON
	ON	OFF	ON
4 TERMINATION			
M2 PCB			
M6 PC Mount, 90° horizontal			

5 CONTACT		
	<i>Material</i>	<i>Terminal Plating</i>
G	silver ¹	gold over silver ³
K	gold ²	tin-lead ⁴
P	silver ¹	tin-lead ⁴
Q	silver ¹	silver ¹
R	gold ²	gold ²
	<i>Rating</i>	
	3A@125VAC or 28VDC; 1.5A @ 250VAC	
	0.4VA max. @20V max (AC/DC)	
	3A@125VAC or 28VDC; 1.5A @ 250VAC	
	3A@125VAC or 28VDC; 1.5A @ 250VAC	
	0.4VA max. @20V max (AC/DC)	
NOTE:		
Tin-lead option available with PC type terminations only.		
1	Moveable contact & terminals: copper alloy, silver plate	
2	Moveable contact & terminals: copper alloy with gold plate over nickel plate	
3	Terminals: silver plate with outer layer in gold plating	
6 EPOXY SEAL		
E epoxy seal		
7 PACKAGING		
Switches are bulk packed, unless T/R is specified at the end of the part number.		
T/R tape reel - 500 pieces per reel		

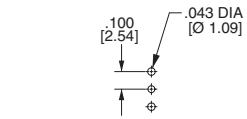
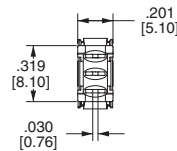
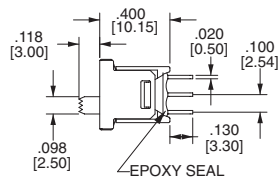
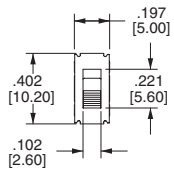
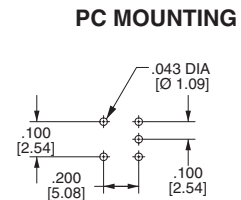
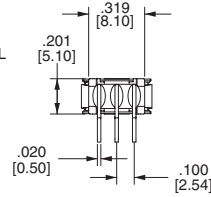
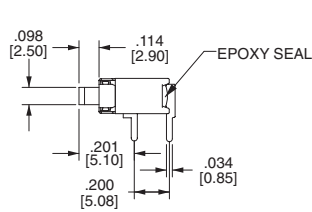
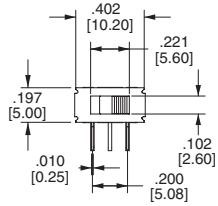
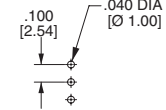
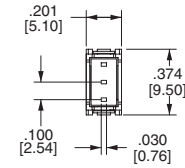
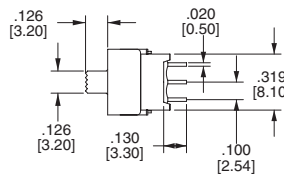
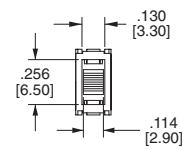
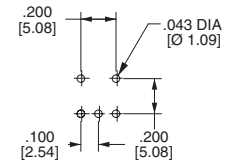
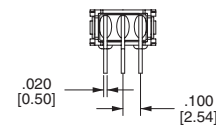
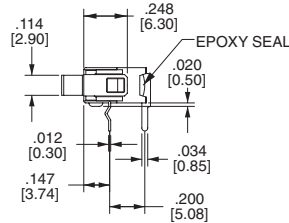
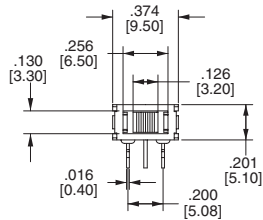
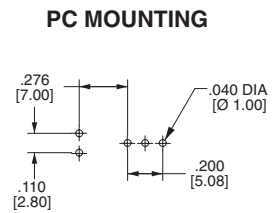
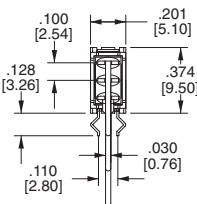
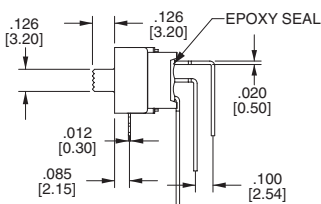
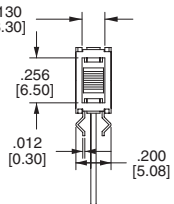
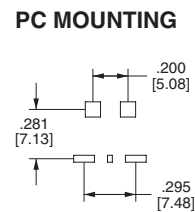
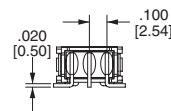
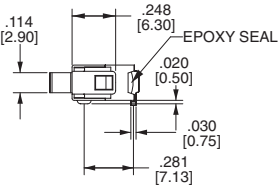
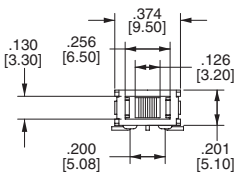
4S-Series Dimensional Specifications: in. [mm]
4S1-Series
TERMINATION
PC MOUNTING
M2

M6

4SS-Series
TERMINATION
PC MOUNTING
M2

M6

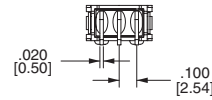
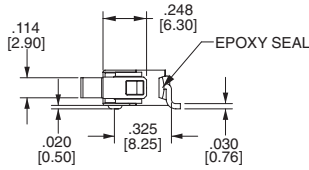
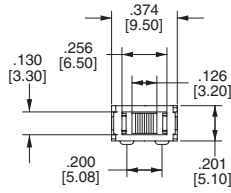
M7

L6

4SS-Series Dimensional Specifications: in. [mm]

TERMINATION

S6



PC MOUNTING

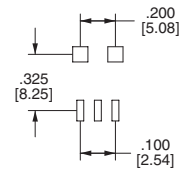

S7

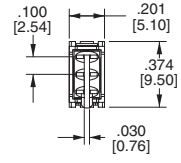
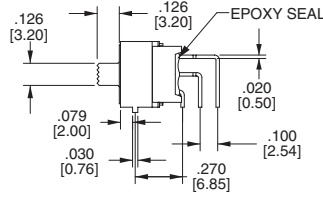
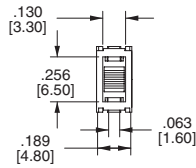

PC MOUNTING

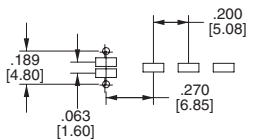

REEL TAPING

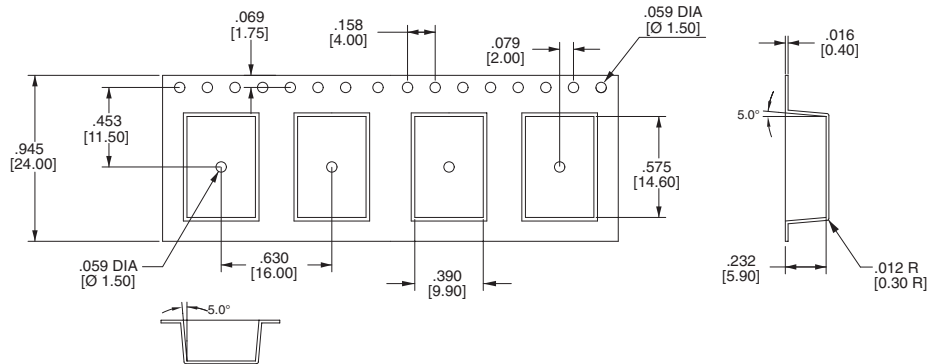

FOR S6, L6 ONLY

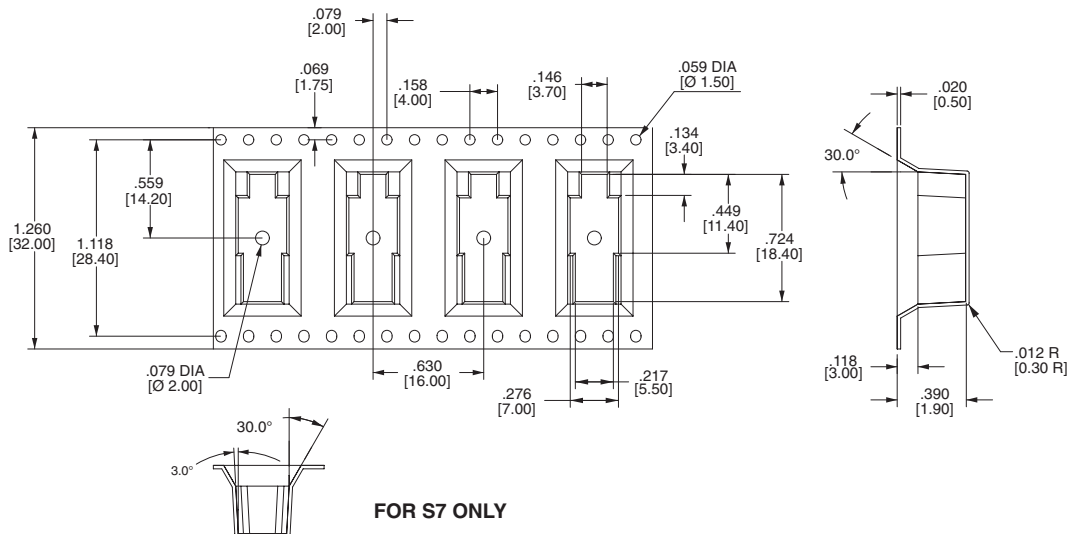

FOR S7 ONLY

4M1-Series Dimensional Specifications: in. [mm]

ACTUATOR

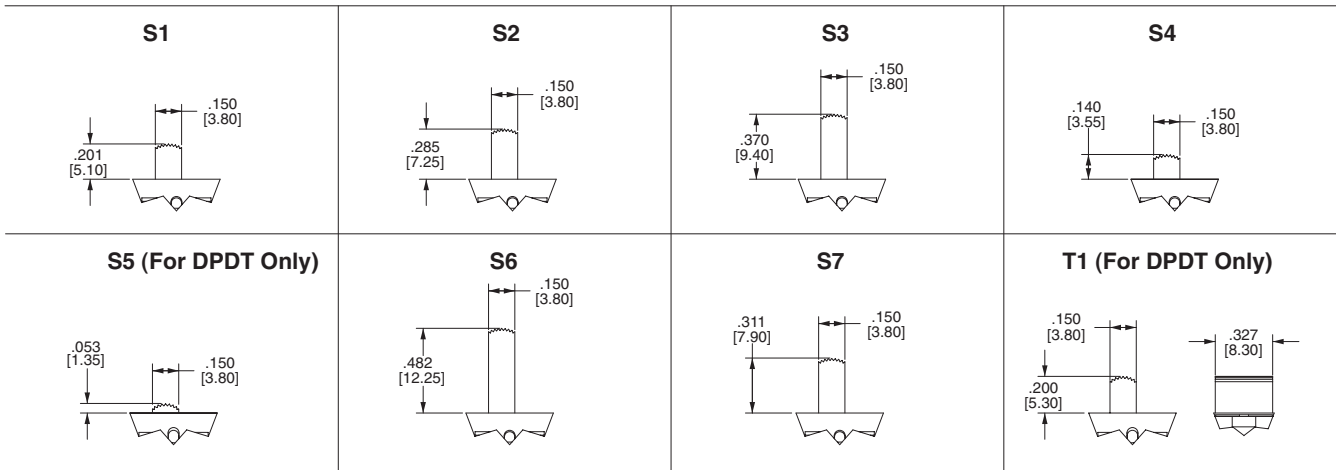

TERMINATION

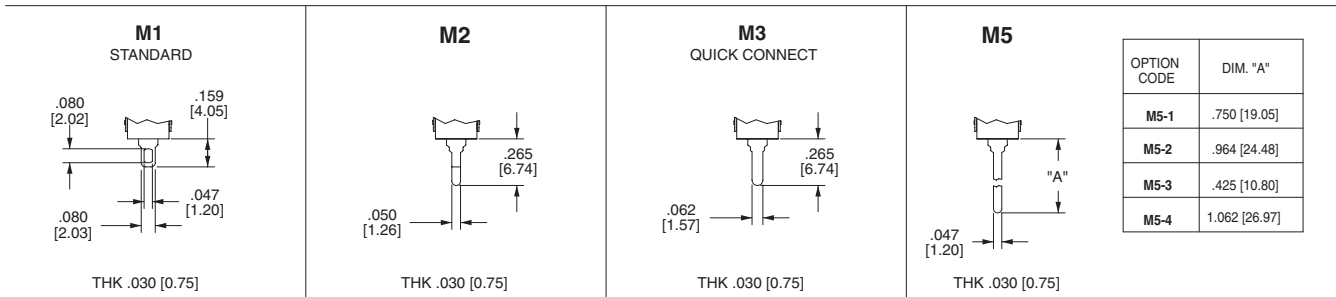

SINGLE POLE

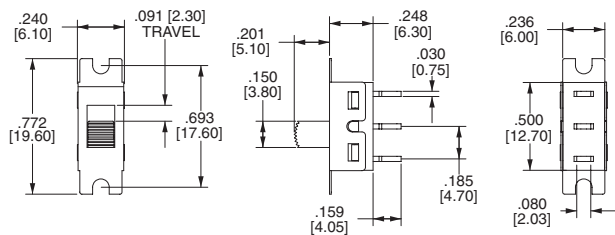

DOUBLE POLE

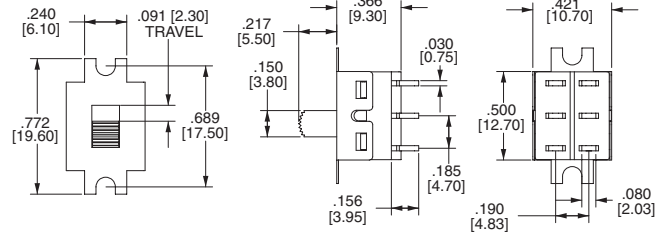

M6

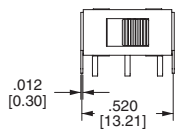

SINGLE POLE

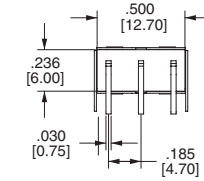
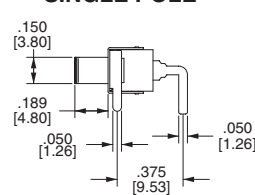

PC MOUNTING

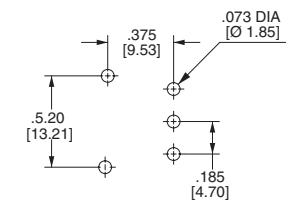

DOUBLE POLE

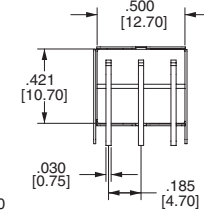
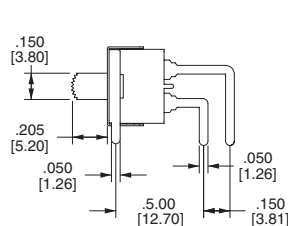

PC MOUNTING

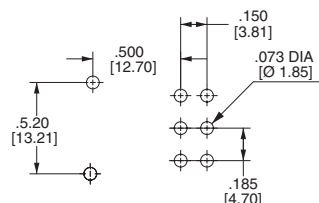

4M1-Series Dimensional Specifications: in. [mm]

TERMINATION

M7

SINGLE POLE

PC MOUNTING

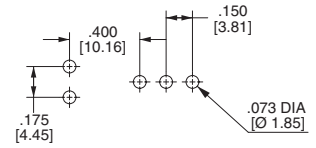
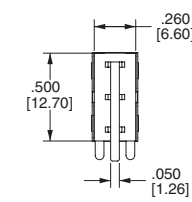
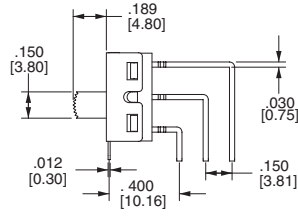
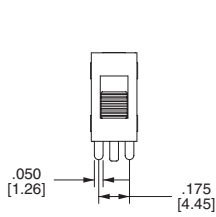

DOUBLE POLE

PC MOUNTING

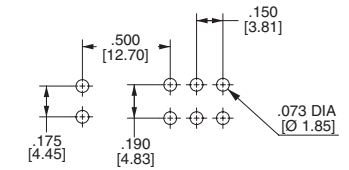
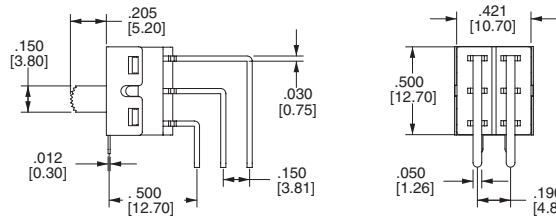
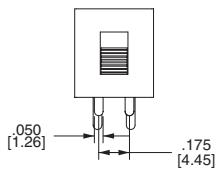

VS2

SINGLE POLE

PC MOUNTING

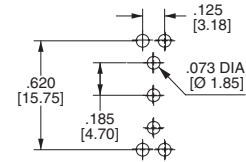
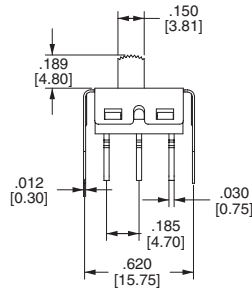
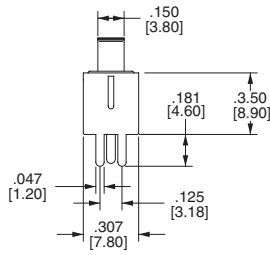

DOUBLE POLE

PC MOUNTING

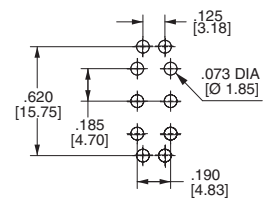
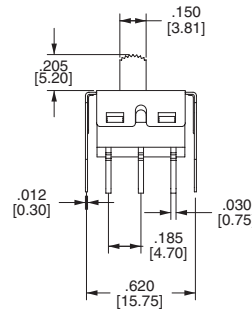
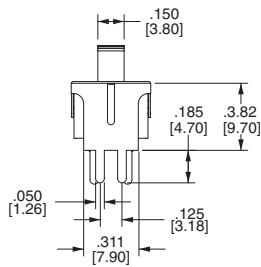

Компания «Life Electronics» занимается поставками электронных компонентов импортного и отечественного производства от производителей и со складов крупных дистрибьюторов Европы, Америки и Азии.

С конца 2013 года компания активно расширяет линейку поставок компонентов по направлению коаксиальный кабель, кварцевые генераторы и конденсаторы (керамические, пленочные, электролитические), за счёт заключения дистрибьюторских договоров

Мы предлагаем:

- Конкурентоспособные цены и скидки постоянным клиентам.
- Специальные условия для постоянных клиентов.
- Подбор аналогов.
- Поставку компонентов в любых объемах, удовлетворяющих вашим потребностям.
- Приемлемые сроки поставки, возможна ускоренная поставка.
- Доставку товара в любую точку России и стран СНГ.
- Комплексную поставку.
- Работу по проектам и поставку образцов.
- Формирование склада под заказчика.
- Сертификаты соответствия на поставляемую продукцию (по желанию клиента).
- Тестирование поставляемой продукции.
- Поставку компонентов, требующих военную и космическую приемку.
- Входной контроль качества.
- Наличие сертификата ISO.

В составе нашей компании организован Конструкторский отдел, призванный помогать разработчикам, и инженерам.

Конструкторский отдел помогает осуществить:

- Регистрацию проекта у производителя компонентов.
- Техническую поддержку проекта.
- Защиту от снятия компонента с производства.
- Оценку стоимости проекта по компонентам.
- Изготовление тестовой платы монтаж и пусконаладочные работы.



Тел: +7 (812) 336 43 04 (многоканальный)

Email: org@lifeelectronics.ru