

MAB series

Micro limit snap action switch

Distinctive features and specifications

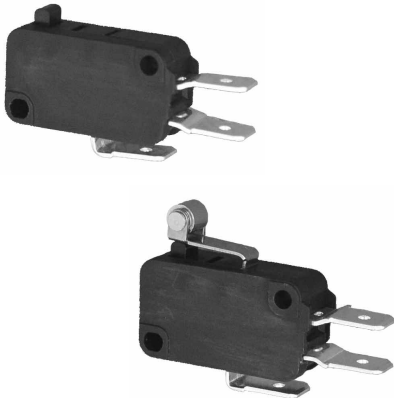

- Movement differential $\leq 0.4\text{mm}$.
- Available in normally open, normally closed and change-over functions.
- Solder lug, quick connect, PCB, and screw terminals available.

ELECTRICAL SPECIFICATIONS

- AC rating: 1(0.3)A...16(4)A, 250VAC
- Electrical life: 50,000 cycles min.

MATERIALS

- Case: PBT/PET (UL94V-0)
- Actuator: Phenolic (UL94V-0)
- Contact spring: CuBe
- Terminals: CuZn Ag plated
- Contacts: AgNi

GENERAL SPECIFICATIONS

- Operating temperature: -10°C to $+85/125^{\circ}\text{C}$
- Pretravel: $\leq 1.4\text{ mm}$
- Overtravel: 0.75mm min to 1.50mm max.
- Movement differential: $\leq 0.4\text{mm}$
- Operating position: $14.8 \pm 0.6\text{mm}$
- Contact gap: $< 3\text{mm}$

AGENCY APPROVALS



MAB series

Micro limit snap action switch

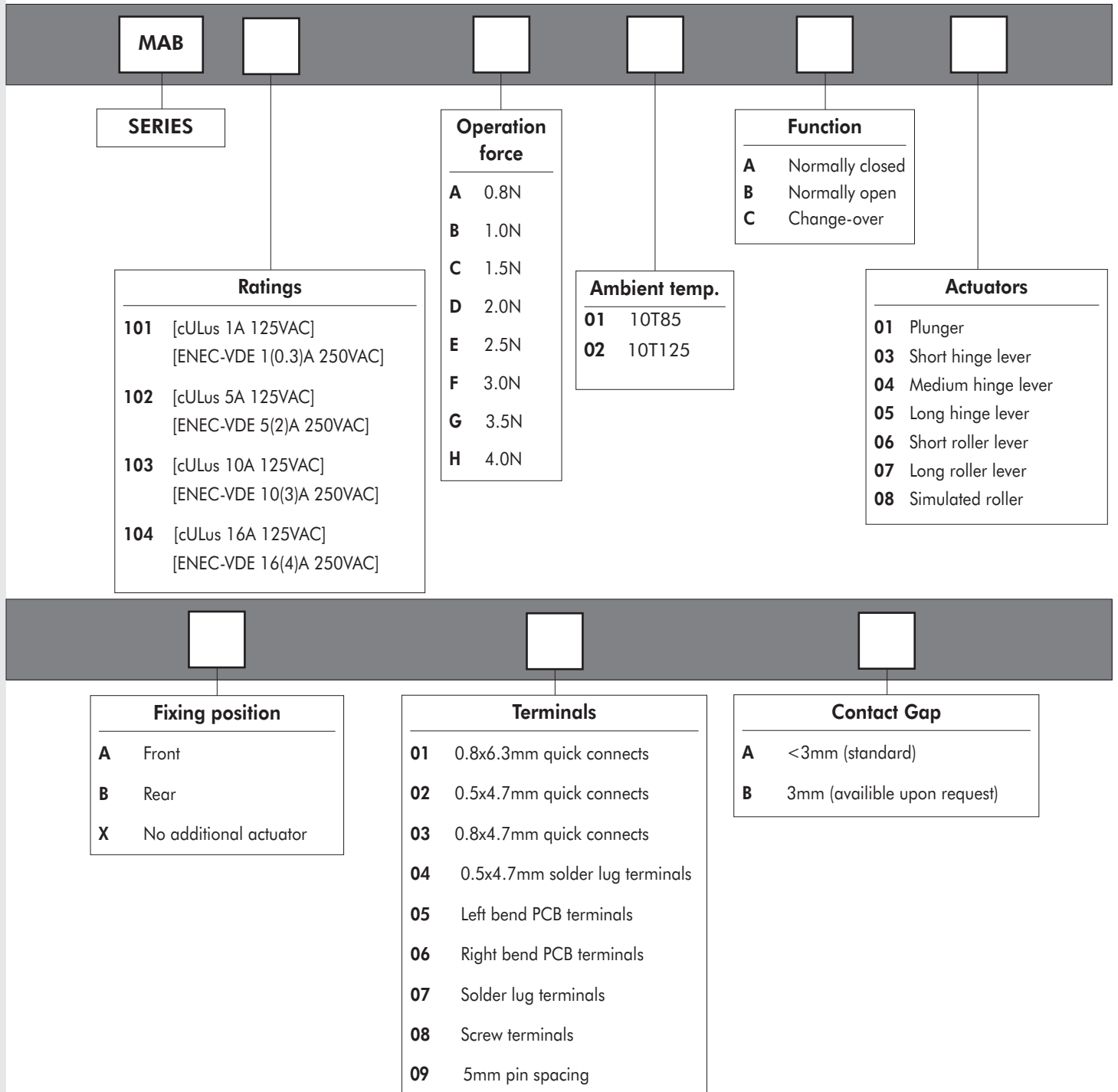

ABOUT THIS SERIES

On the following pages, you will find successively :

- model structure of switches
- options in the same order as in above chart

Dimensions : first dimensions are in mm while inches are shown as bracketed numbers.



NOTICE : please note that not all combinations of above numbers are available. Refer to the following pages for further information.

MAB series

Micro limit snap action switch

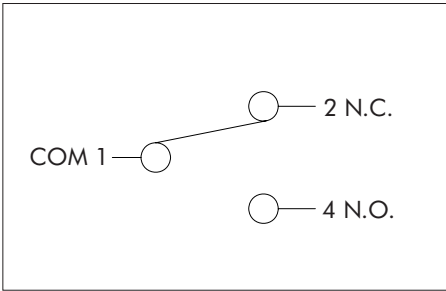

Change-over with plunger

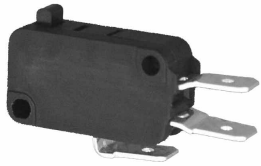

MAB C01B01

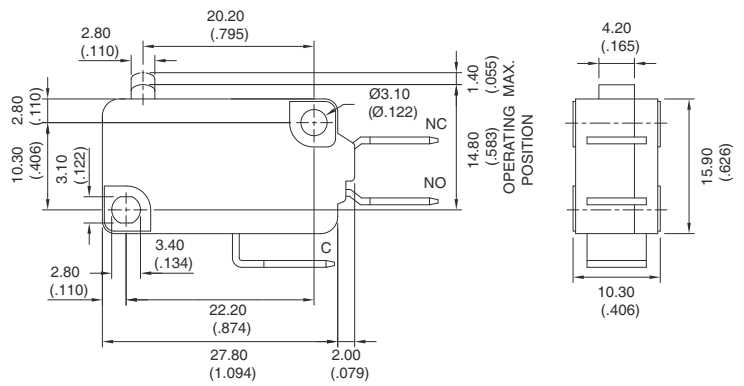

Change-over with short hinge lever

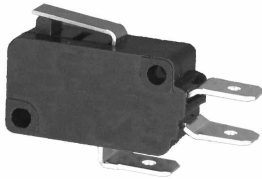

MAB C03B01

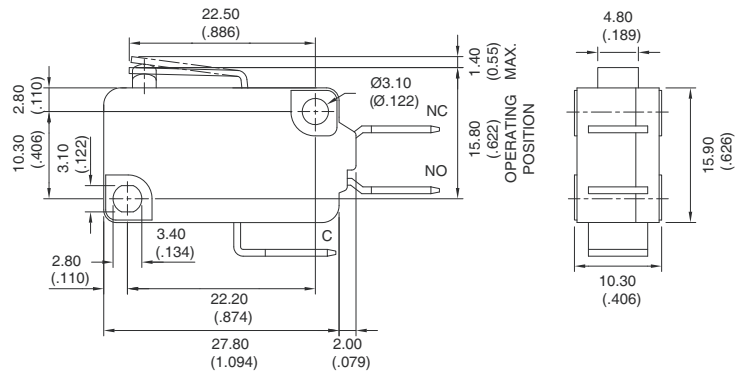

Change-over with medium hinge lever



MAB C04B01

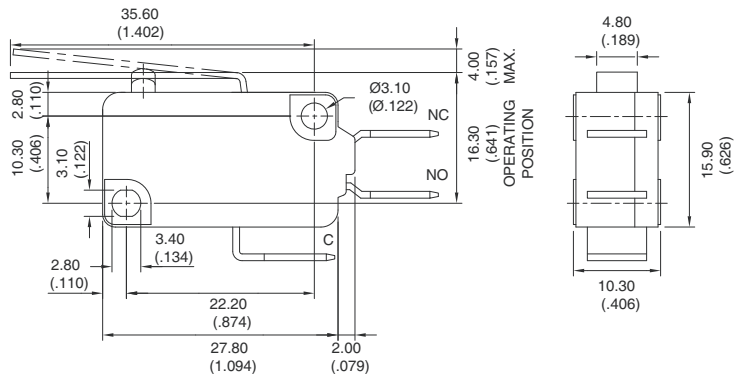

MAB series

Micro limit snap action switch

Change-over with long hinge lever

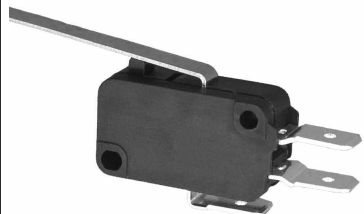

MAB C05B01

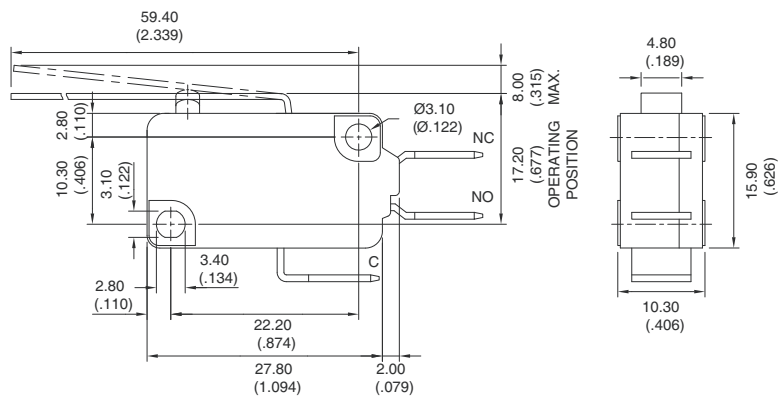

Change-over with short roller lever

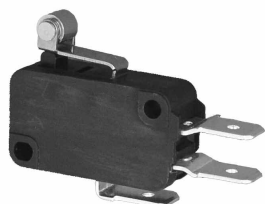

MAB C006B01

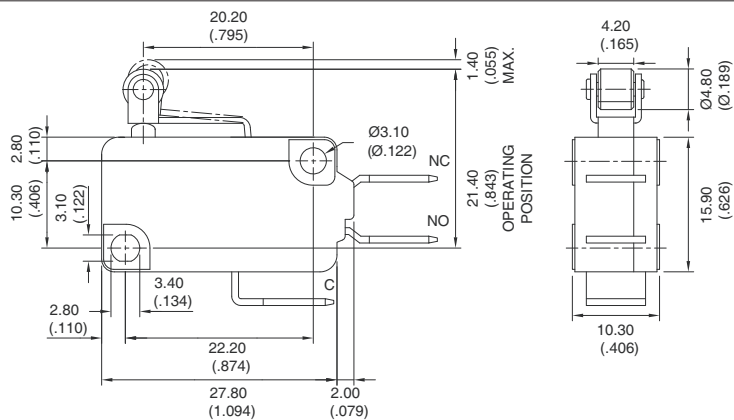

Change-over with long roller lever

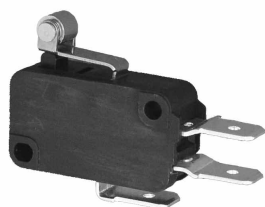

MAB C07B01

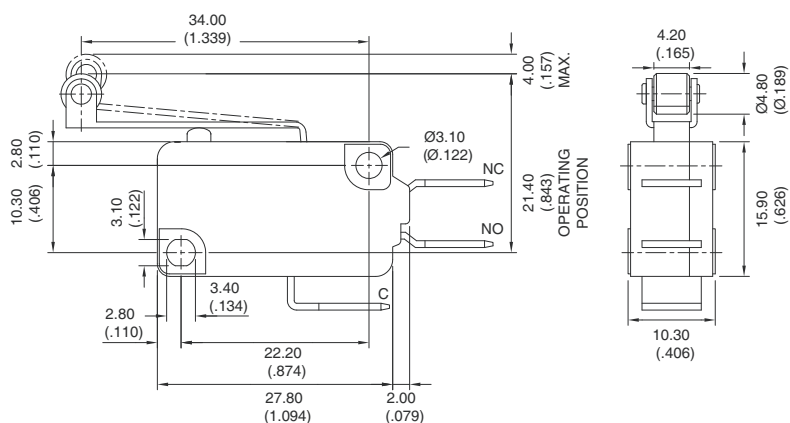

Change-over with simulated roller

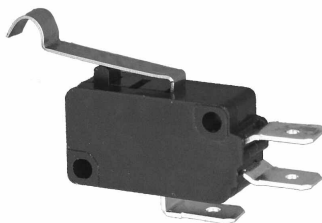

MAB C08B01

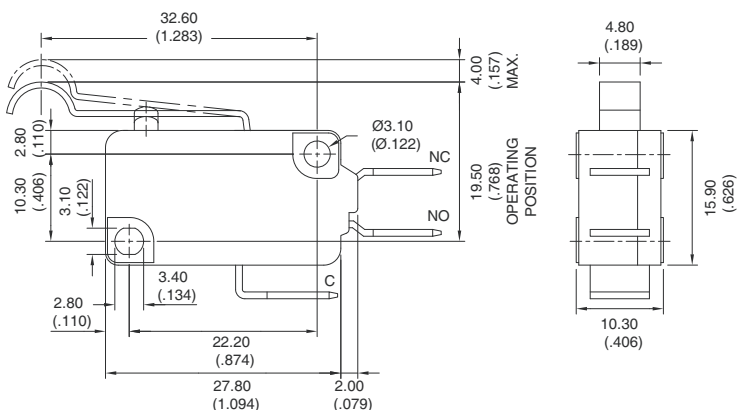

MAB series

Micro limit snap action switch

Fixing position

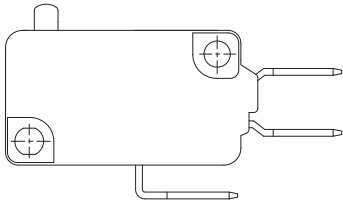

X No additional actuator

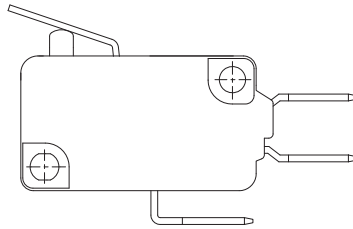

A Front

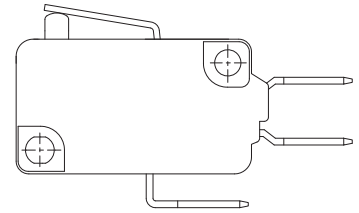

B Rear

Terminal options

01 0.8x6.3mm quick connect terminals

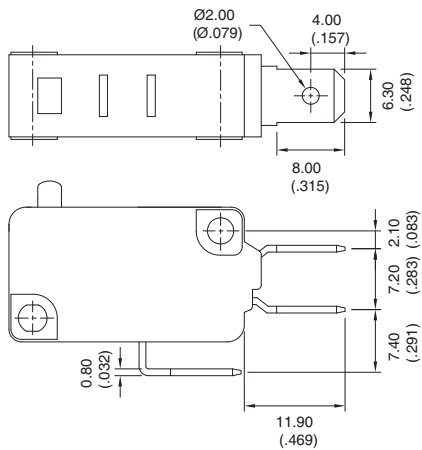

02 0.5x4.7mm quick connect terminals

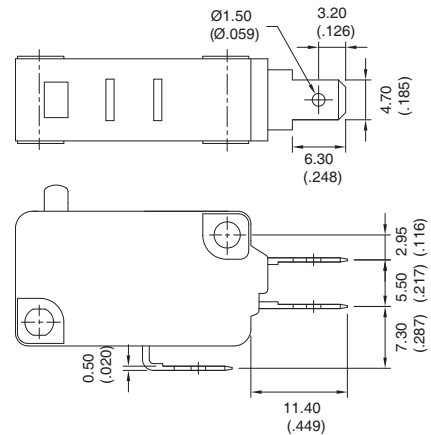

03 0.8x4.7mm quick connect terminals

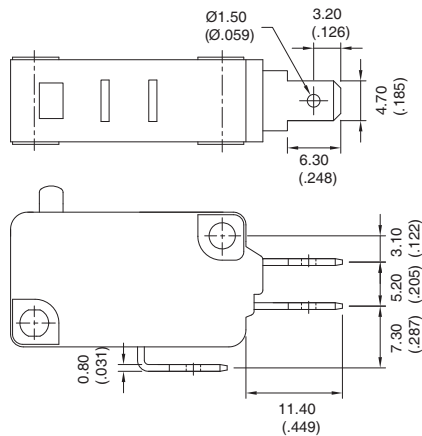

04 0.5x4.7mm solder lug terminals

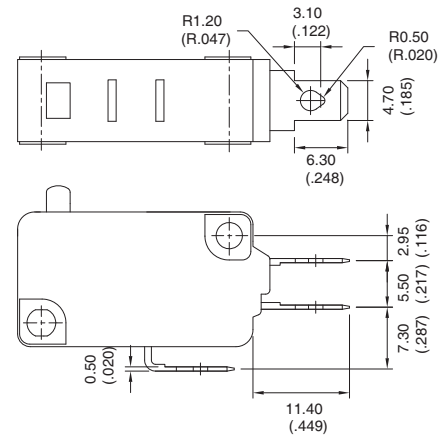

MAB series

Micro limit snap action switch

Terminal options

05 Left bend PCB terminals

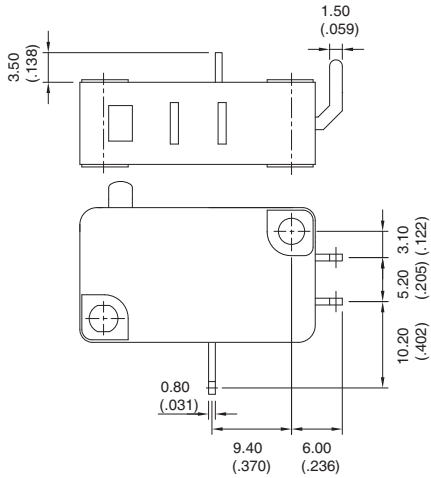

06 right bend PCB terminals

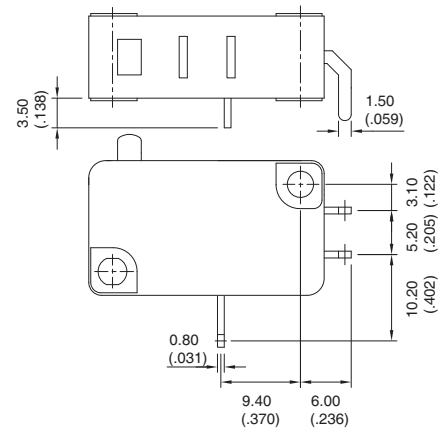

07 Solder lug terminals

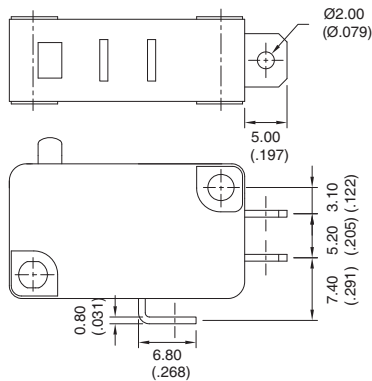

08 Screw terminals

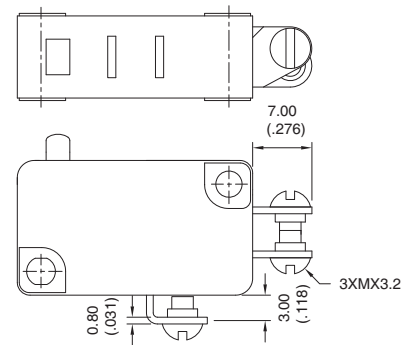

09 Solder lug with 5mm pin spacing

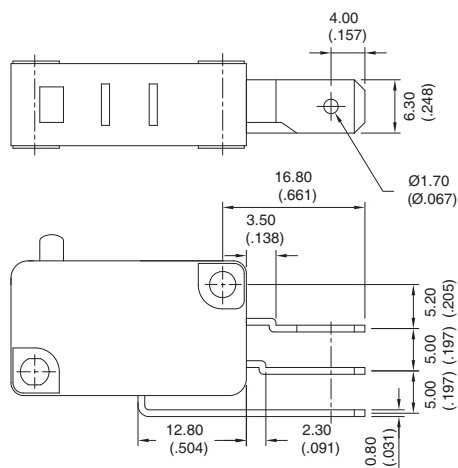

MAB series

Micro limit snap action switch

Mounting hole dimensions

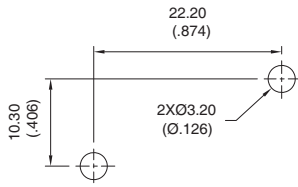

Fixing holes

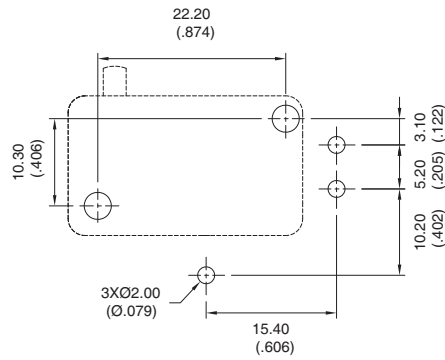

**Left bend
PCB terminals**

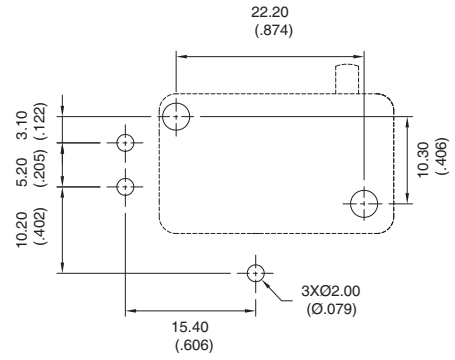

**Right bend
PCB terminals**

MAB series

Micro limit snap action switch

| MAB | Actuator | Actuator length | Operation force on plunger (≤N) | Operation force on lever (≤N) | Pretravel mm (in) | Overtravel mm (in) | Movement differential mm (in) | Free position mm (in) | Operating position |
|-----------------------------|----------|------------------|---------------------------------|-------------------------------|-------------------|--------------------------|-------------------------------|-----------------------|---------------------------|
| Plunger | 01 | - | 0.8 | - | 1.40 (.055) | 0.75-1.50 (.030-.059) | 0.40 (.016) | 16.80 (.661) | 14.80±0.60 (.583±.024) |
| | | | 1.0 | - | | | | | |
| | | | 1.5 | - | | | | | |
| | | | 2.0 | - | | | | | |
| | | | 2.5 | - | | | | | |
| | | | 3.0 | - | | | | | |
| | | | 3.5 | - | | | | | |
| 4.0 | - | | | | | | | | |
| Rear fixing position | | | | | | | | | |
| Short hinge lever | 03 | 22.50 (.886) | 0.8 | 0.80 | 1.40 (.055) | 1.00 (.039) | 0.50 (.020) | 17.70 (.697) | 15.80±0.50 (.622±.020) |
| | | | 1.0 | 1.00 | | | | | |
| | | | 1.5 | 1.50 | | | | | |
| | | | 2.0 | 2.00 | | | | | |
| | | | 2.5 | 2.50 | | | | | |
| | | | 3.0 | 3.00 | | | | | |
| | | | 3.5 | 3.50 | | | | | |
| 4.0 | 4.00 | | | | | | | | |
| Medium hinge lever | 04 | 35.60 (1.402) | 0.8 | 0.36 | 4.00 (.157) | 2.00 (.079) | 1.00 (.039) | 21.50 (.847) | 16.30±0.50 (.642±.020) |
| | | | 1.0 | 0.45 | | | | | |
| | | | 1.5 | 0.70 | | | | | |
| | | | 2.0 | 0.90 | | | | | |
| | | | 2.5 | 1.15 | | | | | |
| | | | 3.0 | 1.30 | | | | | |
| | | | 3.5 | 1.60 | | | | | |
| 4.0 | 1.80 | | | | | | | | |
| Long hinge lever | 05 | 59.40 (2.339) | 0.8 | 0.20 | 8.00 (.315) | 4.00 (.157) | 0.20 (.079) | 27.70 (1.091) | 17.20±2.50 (.677±.098) |
| | | | 1.0 | 0.25 | | | | | |
| | | | 1.5 | 0.37 | | | | | |
| | | | 2.0 | 0.50 | | | | | |
| | | | 2.5 | 0.62 | | | | | |
| | | | 3.0 | 0.75 | | | | | |
| | | | 3.5 | 0.88 | | | | | |
| 4.0 | 1.00 | | | | | | | | |
| Short roller lever | 06 | 20.20 (.795) | 0.8 | 0.90 | 1.40 (.055) | 1.00 (.039) | 0.40 (.016) | 23.40 (.921) | 21.40±0.60 (.843±.024) |
| | | | 1.0 | 1.10 | | | | | |
| | | | 1.5 | 1.60 | | | | | |
| | | | 2.0 | 2.20 | | | | | |
| | | | 2.5 | 2.66 | | | | | |
| | | | 3.0 | 3.20 | | | | | |
| | | | 3.5 | 3.72 | | | | | |
| 4.0 | 4.25 | | | | | | | | |
| Long roller lever | 07 | 34.00 (1.339) | 0.8 | 0.40 | 4.00 (.157) | 2.00 (.079) | 1.00 (.039) | 26.60 (1.047) | 21.40±1.20 (.843±.047) |
| | | | 1.0 | 0.50 | | | | | |
| | | | 1.5 | 0.80 | | | | | |
| | | | 2.0 | 1.00 | | | | | |
| | | | 2.5 | 1.30 | | | | | |
| | | | 3.0 | 1.60 | | | | | |
| | | | 3.5 | 1.87 | | | | | |
| 4.0 | 2.14 | | | | | | | | |
| Simulated roller lever | 08 | 32.60 (1.283) | 0.8 | 0.43 | 4.00 (.157) | 2.00 (.079) | 1.00 (.039) | 24.70 (.972) | 19.50±1.20 (.768±.047) |
| | | | 1.0 | 0.54 | | | | | |
| | | | 1.5 | 0.81 | | | | | |
| | | | 2.0 | 1.08 | | | | | |
| | | | 2.5 | 1.35 | | | | | |
| | | | 3.0 | 1.62 | | | | | |
| | | | 3.5 | 1.89 | | | | | |
| 4.0 | 2.16 | | | | | | | | |

MAB series

Micro limit snap action switch

| Front fixing position | | | | | | | | | |
|------------------------|----------|------------------|---|---------------------------------------|-------------------|--------------------|-------------------------------|-----------------------|---------------------------|
| MAB | Actuator | Actuator length | Operation force on plunger ($\leq N$) | Operation force on lever ($\leq N$) | Pretravel mm (in) | Overtravel mm (in) | Movement differential mm (in) | Free position mm (in) | Operating position |
| Short hinge lever | 03 | 28.20 (1.110) | 0.8 | 0.65 | 3.20 (.126) | 1.50 (.059) | 0.80 (.031) | 19.70 (.776) | 16.40±1.00 (.646±.03) |
| | | | 1.0 | 0.79 | | | | | |
| | | | 1.5 | 1.20 | | | | | |
| | | | 2.0 | 1.60 | | | | | |
| | | | 2.5 | 2.00 | | | | | |
| | | | 3.0 | 2.40 | | | | | |
| | | | 3.5 | 2.80 | | | | | |
| 4.0 | 3.20 | | | | | | | | |
| Medium hinge lever | 04 | 41.20 (1.622) | 0.8 | 0.45 | 6.20 (.244) | 3.00 (.118) | 1.20 (.047) | 25.50 (1.004) | 17.80±1.50 (.701±.059) |
| | | | 1.0 | 0.54 | | | | | |
| | | | 1.5 | 0.85 | | | | | |
| | | | 2.0 | 1.10 | | | | | |
| | | | 2.5 | 1.38 | | | | | |
| | | | 3.0 | 1.70 | | | | | |
| | | | 3.5 | 1.95 | | | | | |
| 4.0 | 2.20 | | | | | | | | |
| Long hinge lever | 05 | 64.90 (2.555) | 0.8 | 0.28 | 11.70 (.461) | 4.50 (.177) | 2.00 (.079) | 34.70 (1.366) | 20.50±2.50 (.807±.098) |
| | | | 1.0 | 0.35 | | | | | |
| | | | 1.5 | 0.52 | | | | | |
| | | | 2.0 | 0.70 | | | | | |
| | | | 2.5 | 0.87 | | | | | |
| | | | 3.0 | 1.05 | | | | | |
| | | | 3.5 | 1.22 | | | | | |
| 4.0 | 1.40 | | | | | | | | |
| Short roller lever | 06 | 25.60 (1.008) | 0.8 | 0.69 | 2.40 (.094) | 1.50 (.059) | 0.80 (.031) | 25.50 (1.004) | 22.50±0.60 (.886±.024) |
| | | | 1.0 | 0.87 | | | | | |
| | | | 1.5 | 1.30 | | | | | |
| | | | 2.0 | 1.74 | | | | | |
| | | | 2.5 | 2.17 | | | | | |
| | | | 3.0 | 2.60 | | | | | |
| | | | 3.5 | 3.00 | | | | | |
| 4.0 | 3.48 | | | | | | | | |
| Long roller lever | 07 | 39.40 (1.551) | 0.8 | 0.45 | 5.60 (.197) | 2.50 (.098) | 1.20 (.047) | 30.80 (1.213) | 24.00±1.20 (.945±.047) |
| | | | 1.0 | 0.56 | | | | | |
| | | | 1.5 | 0.84 | | | | | |
| | | | 2.0 | 1.12 | | | | | |
| | | | 2.5 | 1.40 | | | | | |
| | | | 3.0 | 1.68 | | | | | |
| | | | 3.5 | 1.95 | | | | | |
| 4.0 | 2.25 | | | | | | | | |
| Simulated roller lever | 08 | 38.20 (1.504) | 0.8 | 0.47 | 5.60 (.197) | 2.50 (.098) | 1.20 (.047) | 27.60 (1.087) | 20.80±1.20 (.819±.047) |
| | | | 1.0 | 0.59 | | | | | |
| | | | 1.5 | 0.88 | | | | | |
| | | | 2.0 | 1.18 | | | | | |
| | | | 2.5 | 1.47 | | | | | |
| | | | 3.0 | 1.76 | | | | | |
| | | | 3.5 | 2.06 | | | | | |
| 4.0 | 2.35 | | | | | | | | |

Компания «Life Electronics» занимается поставками электронных компонентов импортного и отечественного производства от производителей и со складов крупных дистрибьюторов Европы, Америки и Азии.

С конца 2013 года компания активно расширяет линейку поставок компонентов по направлению коаксиальный кабель, кварцевые генераторы и конденсаторы (керамические, пленочные, электролитические), за счёт заключения дистрибьюторских договоров

Мы предлагаем:

- Конкурентоспособные цены и скидки постоянным клиентам.
- Специальные условия для постоянных клиентов.
- Подбор аналогов.
- Поставку компонентов в любых объемах, удовлетворяющих вашим потребностям.
- Приемлемые сроки поставки, возможна ускоренная поставка.
- Доставку товара в любую точку России и стран СНГ.
- Комплексную поставку.
- Работу по проектам и поставку образцов.
- Формирование склада под заказчика.
- Сертификаты соответствия на поставляемую продукцию (по желанию клиента).
- Тестирование поставляемой продукции.
- Поставку компонентов, требующих военную и космическую приемку.
- Входной контроль качества.
- Наличие сертификата ISO.

В составе нашей компании организован Конструкторский отдел, призванный помогать разработчикам, и инженерам.

Конструкторский отдел помогает осуществить:

- Регистрацию проекта у производителя компонентов.
- Техническую поддержку проекта.
- Защиту от снятия компонента с производства.
- Оценку стоимости проекта по компонентам.
- Изготовление тестовой платы монтаж и пусконаладочные работы.



Тел: +7 (812) 336 43 04 (многоканальный)

Email: org@lifeelectronics.ru