

# Slide Potentiometer

Model PSxxM / PSxxL



## Features:

- Molded element
- 100,000 cycle life
- Metal or plastic shaft options
- With/without LED illumination
- With/without dust cover
- RoHS compliant

## Model Styles Available

|                       |       |
|-----------------------|-------|
| Dual Gang Without LED | PSxxM |
| Single Gang With LED  | PSxxL |

## Electrical

|   |   |
|---|---|
| Resistance Range, Ohms                        | 500 -1M   |
| Standard Resistance Tolerance                 | ± 20%   |
| Resistance Tapers                             | A,B,C   |
| Residual Resistance                           | Terminals 1 to 2: Less than 10 ohms<br>Terminals 2 to 3: Less than 30 ohms  |
| Input Voltage, Maximum                        | Linear B taper: 200 Vac    Other tapers: 150 Vac  |
| Power rating, Watts (Single Unit / Dual Unit) | <b>Linear B taper:</b> 20mm: 0.1W / 0.05W, 30mm: 0.2W / 0.1W<br>45mm: 0.25W / 0.125W, 60mm: 0.2W / 0.2W<br><b>Other tapers:</b> 20mm: 0.05W / 0.025W, 30mm: 0.1W / 0.05W<br>45mm: 0.125W / 0.06W, 60mm: 0.1W / 0.1W |
| Dielectric Strength                           | 300Vac, 1 minute  |
| Insulation Resistance, Minimum                | 10M ohms at 250Vdc/ 1 minute  |
| Sliding Noise                                 | Less than 100mV   |
| Gang Error                                    | ±3dB (-40dB to 0dB)   |

## Mechanical

|                               |               |
|-------------------------------|---------------|
| Static Stop Strength, Minimum | 5.0 Kg/cm     |
| Operating Force               | 10gf to 100gf |
| Detent Slip-out force         | 30gf to 200gf |

## Durability

|              |                |
|--------------|----------------|
| Sliding Life | 100,000 cycles |
|--------------|----------------|

### General Note

TT Electronics reserves the right to make changes in product specification without notice or liability. All information is subject to TT Electronics' own data and is considered accurate at time of going to print.

TT Electronics | BI Technologies  
4200 Bonita Place, Fullerton, CA USA 92835 | Ph: +1 714 447 2345  
www.ttelectronics.com | sensors@ttelectronics.com

# Slide Potentiometer

Model PSxxM / PSxxL



## Ordering

### Model PSxxM (Without LED)



### Model PSxxL (With LED)



## Standard Resistance Values, ohms

|     |    |    |    |     |     |     |      |      |      |       |
|-----|----|----|----|-----|-----|-----|------|------|------|-------|
| 500 | 1K | 2K | 5K | 10K | 20K | 50K | 100K | 200K | 500K | 1 MEG |
|-----|----|----|----|-----|-----|-----|------|------|------|-------|

#### General Note

TT Electronics reserves the right to make changes in product specification without notice or liability. All information is subject to TT Electronics' own data and is considered accurate at time of going to print.

TT Electronics | BI Technologies

4200 Bonita Place, Fullerton, CA USA 92835 | Ph: +1 714 447 2345  
www.ttelectronics.com | sensors@ttelectronics.com

# Slide Potentiometer

Model PSxxM / PSxxL



## Tapers

For Dual Gang units ONLY, the Standard Taper is a 3B taper  
If Linear Taper is desired, use "L" taper option



### General Note

TT Electronics reserves the right to make changes in product specification without notice or liability. All information is subject to TT Electronics' own data and is considered accurate at time of going to print.

TT Electronics | BI Technologies  
4200 Bonita Place, Fullerton, CA USA 92835 | Ph: +1 714 447 2345  
www.ttelectronics.com | sensors@ttelectronics.com

# Slide Potentiometer

Model PSxxM / PSxxL



## Outline Drawings

### Plastic Lever Types (For PSxxM Only)

| E-Type |     | B-Type |    | C-Type |       | D-Type |          |  |
|--------|-----|--------|----|--------|-------|--------|----------|--|
|        |     |        |    |        |       |        |          |  |
| L      | 5.0 | L      | 15 | L      | 10 15 | L      | 10 15 20 |  |
| CODE   | 1   | CODE   | 1  | CODE   | 1 2   | CODE   | 1 2 3    |  |

**Dust Cover option not offered for levers less than 10 mm in length**

### Metal Lever Types (For PSxxM Only)

| D-Type |    |    |    | C-Type |   |    |    | E-Type |      |   |
|--------|----|----|----|--------|---|----|----|--------|------|---|
|        |    |    |    |        |   |    |    |        |      |   |
| L      | 15 | 20 | 25 | F      | 5 | 10 | 10 | L      | 7.6  |   |
| CODE   | 1  | 2  | 3  | CODE   | 1 | 2  | 3  | 4      | CODE | 1 |

**\* Dust Cover option not offered for levers less than 10 mm in length**

#### General Note

TT Electronics reserves the right to make changes in product specification without notice or liability. All information is subject to TT Electronics' own data and is considered accurate at time of going to print.

TT Electronics | BI Technologies  
4200 Bonita Place, Fullerton, CA USA 92835 | Ph: +1 714 447 2345  
www.ttelectronics.com | sensors@ttelectronics.com

# Slide Potentiometer

Model PSxxM / PSxxL



## Outline Drawings

### Model PSxxM (Without LED)



### For PSxxM and PSxxL

| MODEL       | A  | B  | C  | D  | F    | G    |
|-------------|----|----|----|----|------|------|
| PS20M PS20L | 35 | 31 | 20 | 30 | 5    | 12.5 |
| PS30M PS30L | 45 | 41 | 30 | 40 | 10   | 22.5 |
| PS45M PS45L | 60 | 56 | 45 | 55 | 15   | 32.5 |
| PS60M PS60L | 75 | 71 | 60 | 70 | 22.5 | 47.5 |

#### General Note

TT Electronics reserves the right to make changes in product specification without notice or liability. All information is subject to TT Electronics' own data and is considered accurate at time of going to print.

TT Electronics | BI Technologies  
 4200 Bonita Place, Fullerton, CA USA 92835 | Ph: +1 714 447 2345  
 www.ttelectronics.com | sensors@ttelectronics.com

# Slide Potentiometer

Model PSxxM / PSxxL



## Outline Drawings

### Model PSxxL (With LED)

#### With Dust Cover



#### Without Dust Cover



|      |    |    |
|------|----|----|
| L    | 15 | 19 |
| CODE | 1  | 2  |

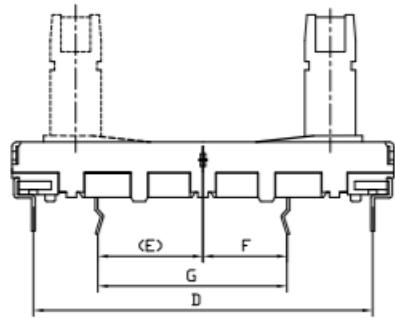
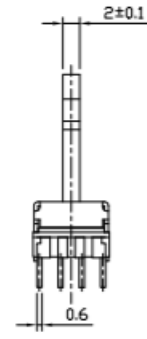

FRAME OPTION (F)

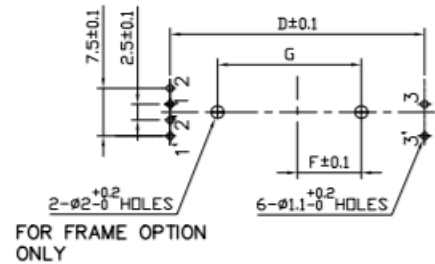

### PSxxL (Single gang with LED)



### PSxxM (Dual gang)



General Note

TT Electronics reserves the right to make changes in product specification without notice or liability. All information is subject to TT Electronics' own data and is considered accurate at time of going to print.

TT Electronics | BI Technologies  
4200 Bonita Place, Fullerton, CA USA 92835 | Ph: +1 714 447 2345  
www.ttelectronics.com | sensors@ttelectronics.com

Компания «Life Electronics» занимается поставками электронных компонентов импортного и отечественного производства от производителей и со складов крупных дистрибьюторов Европы, Америки и Азии.

С конца 2013 года компания активно расширяет линейку поставок компонентов по направлению коаксиальный кабель, кварцевые генераторы и конденсаторы (керамические, пленочные, электролитические), за счёт заключения дистрибьюторских договоров

Мы предлагаем:

- Конкурентоспособные цены и скидки постоянным клиентам.
- Специальные условия для постоянных клиентов.
- Подбор аналогов.
- Поставку компонентов в любых объемах, удовлетворяющих вашим потребностям.
- Приемлемые сроки поставки, возможна ускоренная поставка.
- Доставку товара в любую точку России и стран СНГ.
- Комплексную поставку.
- Работу по проектам и поставку образцов.
- Формирование склада под заказчика.
- Сертификаты соответствия на поставляемую продукцию (по желанию клиента).
- Тестирование поставляемой продукции.
- Поставку компонентов, требующих военную и космическую приемку.
- Входной контроль качества.
- Наличие сертификата ISO.

В составе нашей компании организован Конструкторский отдел, призванный помогать разработчикам, и инженерам.

Конструкторский отдел помогает осуществить:

- Регистрацию проекта у производителя компонентов.
- Техническую поддержку проекта.
- Защиту от снятия компонента с производства.
- Оценку стоимости проекта по компонентам.
- Изготовление тестовой платы монтаж и пусконаладочные работы.



Тел: +7 (812) 336 43 04 (многоканальный)

Email: [org@lifeelectronics.ru](mailto:org@lifeelectronics.ru)