



## Features/Benefits

- Compact design
- Low actuation force
- Detect mechanical movement
- Left and right options
- Right angle options

## Typical Applications

- Computer peripherals
- Office equipment
- Consumer electronics
- Appliances
- Audio and visual equipment

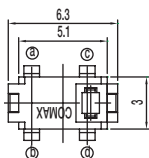

PART NUMBER	PACKAGING	SCHEMATIC
<b>DS-02005</b>	1,000 pieces	1P-1T

## Specifications

CONTACT ARRANGEMENT: SPST, NO  
 CONTACT RATING: 100mA @ 30 VDC  
 OPERATING LIFE: 50,000 cycles  
 OPERATING FORCE: 50 gf max.  
 PRE-TRAVEL: 0.7 mm  
 TOTAL TRAVEL: 2.6 mm  
 INITIAL CONTACT RESISTANCE: 1  $\Omega$  max.  
 INSULATION RESISTANCE: 100 M  $\Omega$  min. @ 100 VDC 60 sec.  
 DIELECTRIC STRENGTH: 100 V AC (50-60Hz) 60 sec.  
 OPERATING TEMPERATURE: -40°C to +85°C.

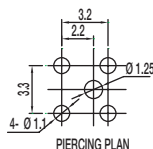
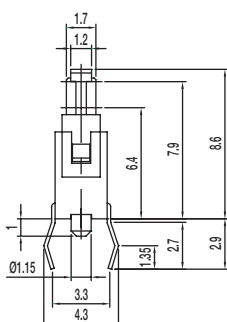
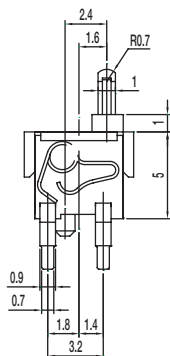

## Materials

KNOB: PA  
 COVER: PA  
 SPRING: Gold plated, copper alloy  
 HOUSING: PA  
 TERMINAL: Silver plated, copper alloy

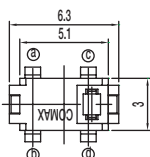

PART NUMBER	PACKAGING	SCHEMATIC
<b>DS-02005 (30)</b>	1,000 pieces	1P-1T

## Specifications

CONTACT ARRANGEMENT: SPST, NO  
 CONTACT RATING: 100mA @ 30 VDC  
 OPERATING LIFE: 50,000 cycles  
 OPERATING FORCE: 30 gf max.  
 PRE-TRAVEL: 0.7 mm  
 TOTAL TRAVEL: 2.2 mm  
 INITIAL CONTACT RESISTANCE: 1  $\Omega$  max.  
 INSULATION RESISTANCE: 100 M  $\Omega$  min. @ 100 VDC 60 sec.  
 DIELECTRIC STRENGTH: 100 V AC (50-60Hz) 60 sec.  
 OPERATING TEMPERATURE: -40°C to +85°C.

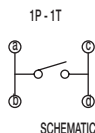
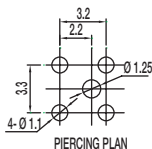
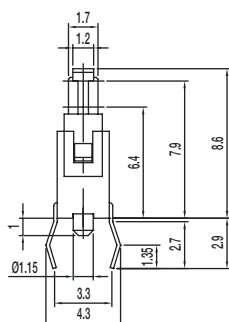
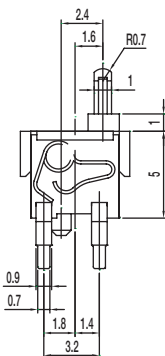

## Materials

KNOB: PA  
 COVER: PA  
 SPRING: Gold plated, copper alloy  
 HOUSING: PA  
 TERMINAL: Silver plated, copper alloy

# DS Series Detect Switch

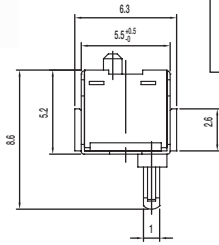

PART NUMBER	PACKAGING	SCHEMATIC
<b>DS-02005-A</b>	1,000 pieces	1P-1T  N.O.

## Specifications

CONTACT ARRANGEMENT: SPST, NO  
 CONTACT RATING: 100mA @ 30 VDC  
 OPERATING LIFE: 50,000 cycles  
 OPERATING FORCE: 50 gf max.  
 PRE-TRAVEL: 0.7 mm  
 TOTAL TRAVEL: 2.6 mm  
 INITIAL CONTACT RESISTANCE: 1 Ω max.  
 INSULATION RESISTANCE: 100 M Ω min. @ 100 VDC 60 sec.  
 DIELECTRIC STRENGTH: 100 V AC (50-60Hz) 60 sec.  
 OPERATING TEMPERATURE: -40°C to +85°C.

## Materials

KNOB: PA  
 COVER: PA  
 SPRING: Gold plated, copper alloy  
 HOUSING: PA  
 TERMINAL: Silver plated, copper alloy

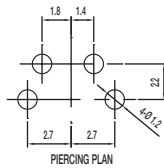
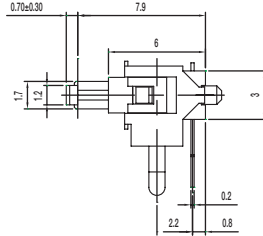
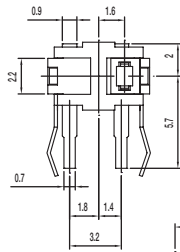

PART NUMBER	PACKAGING	SCHEMATIC
<b>DS-21805</b>	2,500 pieces	 N.O.

## Specifications

CONTACT ARRANGEMENT: SPDT  
 CONTACT RATING: 5mA @ 5 VDC  
 OPERATING LIFE: 100,000 cycles  
 OPERATING FORCE: 36 gf  
 TOTAL TRAVEL: 2.20 mm  
 INITIAL CONTACT RESISTANCE: 1 Ω max.  
 INSULATION RESISTANCE: 100 M Ω min. @ 100 VDC 60 sec.  
 DIELECTRIC STRENGTH: 100 V AC (50-60Hz) 60 sec.  
 OPERATING TEMPERATURE: -20°C to +70°C.

## Materials

KNOB: POM  
 COVER: PA46  
 SPRING: Silver plated  
 HOUSING: PPS  
 TERMINAL: Silver plated

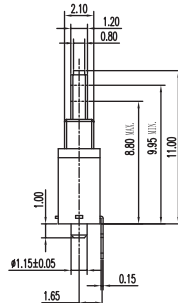
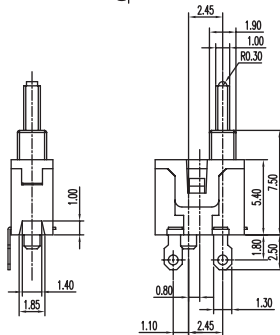
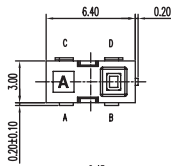

D

Detect



PART NUMBER	PACKAGING	SCHEMATIC
<b>DS-203-A</b>	2,500 pieces	

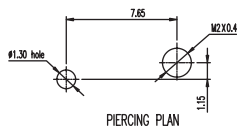
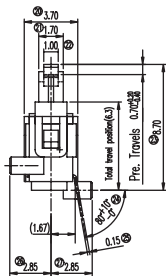
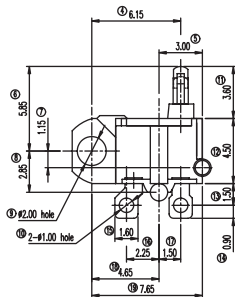
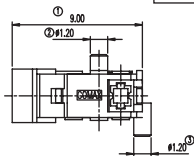

## Specifications

CONTACT ARRANGEMENT: SPST  
 CONTACT RATING: 100mA @ 30 VDC  
 OPERATING LIFE: 50,000 cycles  
 OPERATING FORCE: 36 gf  
 PRE TRAVEL: 0.70 +0.20/-0.40 mm  
 INITIAL CONTACT RESISTANCE: 1 Ω max.  
 INSULATION RESISTANCE: 50 M Ω min. @ 250 VDC 60 sec.  
 DIELECTRIC STRENGTH: 250 V AC (50-60Hz) 60 sec.  
 OPERATING TEMPERATURE: -20°C to +70°C.

## Materials

KNOB: POM  
 COVER: PA  
 SPRING: Gold plated  
 HOUSING: PA  
 TERMINAL: Silver plated



PART NUMBER	PACKAGING	SCHEMATIC
<b>DS-040-02</b>	1,000 pieces	

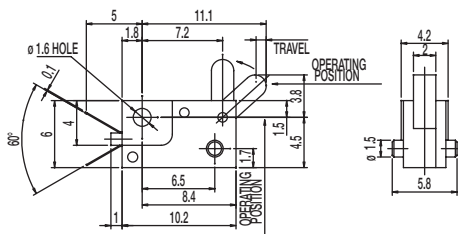
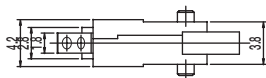

## Specifications

CONTACT ARRANGEMENT: SPST, NO  
 CONTACT RATING: 0.1A @ 16 VDC  
 OPERATING LIFE: 20,000 cycles  
 OPERATING FORCE: 30 ± 15 gf  
 TRAVEL: 0.90 ± 0.20 mm  
 INITIAL CONTACT RESISTANCE: 40 m Ω max.  
 INSULATION RESISTANCE: 100 M Ω min. @ 250 VDC 60 sec.  
 DIELECTRIC STRENGTH: 250 V AC (50-60Hz) 60 sec.  
 OPERATING TEMPERATURE: -20°C to +70°C.

## Materials

LEVER: POM  
 CASE: PBT  
 COVER: PC

# DS Series Detect Switch



PART NUMBER	PACKAGING	SCHEMATIC
<b>DS-080</b>	1,000 pieces	

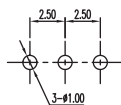
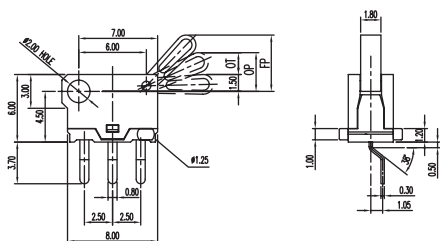

PIERCING PLAN

## Specifications

CONTACT ARRANGEMENT: SPDT  
 CONTACT RATING: 100mA @ 30 VDC  
 OPERATING LIFE: 20,000 cycles  
 OPERATING FORCE: 30 ± 20 gf  
 OVER TRAVEL: 2.0 ± 0.40 mm  
 INITIAL CONTACT RESISTANCE: 200 m Ω max.  
 INSULATION RESISTANCE: 10 M Ω min. @ 250 VDC 60 sec.  
 DIELECTRIC STRENGTH: 250 V AC (50-60Hz) 60 sec.  
 OPERATING TEMPERATURE: -20°C to +70°C.

## Materials

KNOB: POM  
 COVER: PA46  
 SLIDER: PBT  
 HOUSING: PA46  
 TERMINAL: Silver plated



PART NUMBER	PACKAGING	SCHEMATIC
<b>DS-080-C PA</b>	1,000 pieces	

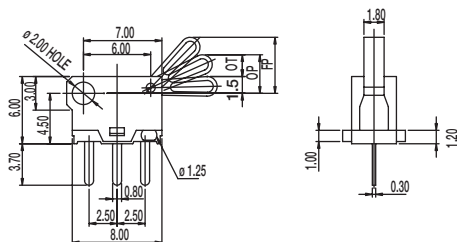
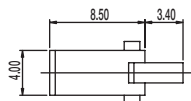

PIERCING PLAN

## Specifications

CONTACT ARRANGEMENT: SPDT  
 CONTACT RATING: 100mA @ 30 VDC  
 OPERATING LIFE: 20,000 cycles  
 OPERATING FORCE: 30 ± 20 gf  
 OVER TRAVEL: 2.0 ± 0.40 mm  
 INITIAL CONTACT RESISTANCE: 200 m Ω max.  
 INSULATION RESISTANCE: 10 M Ω min. @ 250 VDC 60 sec.  
 DIELECTRIC STRENGTH: 250 V AC (50-60Hz) 60 sec.  
 OPERATING TEMPERATURE: -20°C to +70°C.

## Materials

KNOB: POM  
 COVER: PA46  
 SLIDER: PBT  
 HOUSING: PA46  
 TERMINAL: Silver plated



D

Detect



PART NUMBER	PACKAGING	SCHEMATIC
<b>DS-09005-02 BK</b>	500 pieces	 N.O.

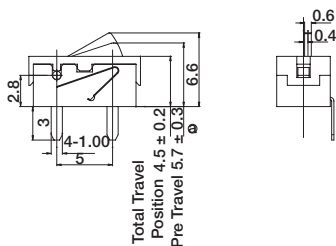
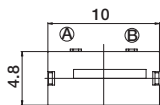

## Specifications

CONTACT ARRANGEMENT: SPST  
 CONTACT RATING: 1mA @ 5 VDC  
 OPERATING LIFE: 100,000 cycles  
 OPERATING FORCE: 50 gf max.  
 TOTAL TRAVEL: 4.5±0.2 mm  
 INITIAL CONTACT RESISTANCE: 500 m Ω max.  
 INSULATION RESISTANCE: 100 M Ω min. @ 500 VDC 60 sec.  
 DIELECTRIC STRENGTH: 500 V AC (50-60Hz) 60 sec.  
 OPERATING TEMPERATURE: -20°C to +70°C.

## Materials

LEVER: POM  
 COVER: PA  
 HOUSING: PA  
 TERMINAL: Silver plated

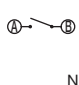

PART NUMBER	PACKAGING	SCHEMATIC
<b>DS-09005-02 RP</b>	500 pieces	 N.O.

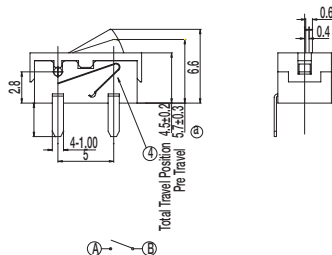
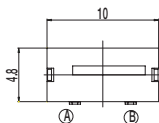

## Specifications

CONTACT ARRANGEMENT: SPST  
 CONTACT RATING: 1mA @ 5 VDC  
 OPERATING LIFE: 100,000 cycles  
 OPERATING FORCE: 50 gf max.  
 TOTAL TRAVEL: 4.5±0.2 mm  
 INITIAL CONTACT RESISTANCE: 500 m Ω max.  
 INSULATION RESISTANCE: 100 M Ω min. @ 500 VDC 60 sec.  
 DIELECTRIC STRENGTH: 500 V AC (50-60Hz) 60 sec.  
 OPERATING TEMPERATURE: -20°C to +70°C.

## Materials

LEVER: POM  
 COVER: PA  
 HOUSING: PA  
 TERMINAL: Silver plated



Detect

Компания «Life Electronics» занимается поставками электронных компонентов импортного и отечественного производства от производителей и со складов крупных дистрибьюторов Европы, Америки и Азии.

С конца 2013 года компания активно расширяет линейку поставок компонентов по направлению коаксиальный кабель, кварцевые генераторы и конденсаторы (керамические, пленочные, электролитические), за счёт заключения дистрибьюторских договоров

Мы предлагаем:

- Конкурентоспособные цены и скидки постоянным клиентам.
- Специальные условия для постоянных клиентов.
- Подбор аналогов.
- Поставку компонентов в любых объемах, удовлетворяющих вашим потребностям.
- Приемлемые сроки поставки, возможна ускоренная поставка.
- Доставку товара в любую точку России и стран СНГ.
- Комплексную поставку.
- Работу по проектам и поставку образцов.
- Формирование склада под заказчика.
- Сертификаты соответствия на поставляемую продукцию (по желанию клиента).
- Тестирование поставляемой продукции.
- Поставку компонентов, требующих военную и космическую приемку.
- Входной контроль качества.
- Наличие сертификата ISO.

В составе нашей компании организован Конструкторский отдел, призванный помогать разработчикам, и инженерам.

Конструкторский отдел помогает осуществить:

- Регистрацию проекта у производителя компонентов.
- Техническую поддержку проекта.
- Защиту от снятия компонента с производства.
- Оценку стоимости проекта по компонентам.
- Изготовление тестовой платы монтаж и пусконаладочные работы.



Тел: +7 (812) 336 43 04 (многоканальный)

Email: [org@lifeelectronics.ru](mailto:org@lifeelectronics.ru)