



Patent Pending



**SafeSite® LED Linear Fixture - UL 844**  
for Indoor and Outdoor Hazardous Locations



# SafeSite® LED Linear Fixture



## Features & Benefits

- L70 rated for > 100,000 hours @ 25°C
- 5 year full performance warranty
- Low power consumption
- Instant on/off operation
- Universal input (100-277V AC or 347 - 480V AC), 50/60Hz
- Mercury free
- Resistant to shock and vibration
- Temperature compensation technology for longer life
- Resistant to water, salt, dust & vibration
- Vibration tested to UL 844 for 35 hours @ 2,000 CPM
- Resistant up to 20 PSI of hose directed water
- Factory Sealed options available

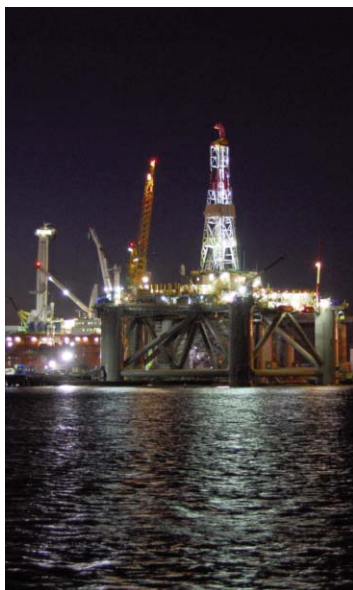

## Typical Applications

- Food and Beverage
- Heavy Industrial
- Manufacturing
- Pulp and Paper
- Fuel Pump Canopy
- Cold Storage
- Warehouse

View the full case studies at:

**Diamond Pet Foods** - [www.dialight.com/assets/brochures\\_and\\_catalogs/Illumination/mdexmognp001.pdf](http://www.dialight.com/assets/brochures_and_catalogs/Illumination/mdexmognp001.pdf)

**Rockline Industries** - [www.dialight.com/Assets/Brochures\\_And\\_Catalogs/Illumination/mdexrkinex001.pdf](http://www.dialight.com/Assets/Brochures_And_Catalogs/Illumination/mdexrkinex001.pdf)

Complete your own Return on Investment calculation at: [www.dialight.com/tcoCalculator](http://www.dialight.com/tcoCalculator)



## SafeSite® LED Linear Fixture

### Class I, Div. 2 Version

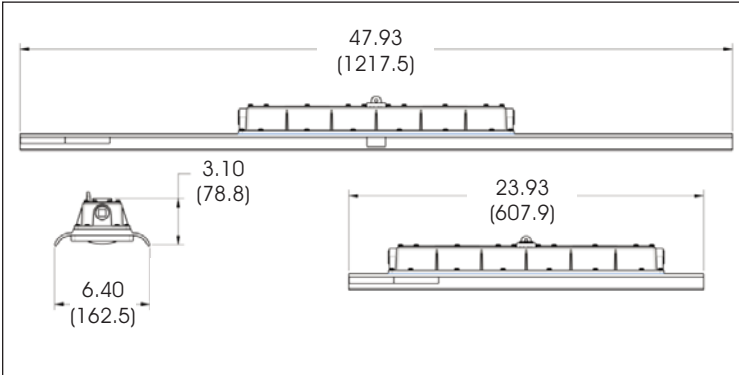

#### Certifications & Ratings

- Class I Div. 2 Groups A, B, C, D
- Class II Div. 1 Groups E, F, G
- Class II Div. 2 Groups F, G
- Class III Div. 1
- Class III Div. 2
- UL 1598/A
- UL 844
- UL 8750
- CSA 22.2 No.137-M81
- IP 66 rated
- NEMA 4X rated

#### LSD Models

- ABS Design Assessed: # 12-HS942957-PDA

#### Application

The first of its kind, Dialight's SafeSite® LED linear fixture replaces HID and fluorescent lighting fixtures in industrial applications and hazardous location applications.

The SafeSite LED Linear fixture's rugged solid state design makes it highly resistant to shock and vibration. Its fully gasketed IP 66 rated enclosure makes it suitable for dust & wet locations, its 1598A rating guarantees added protection from salt water spray. The SafeSite LED Linear's superior design allows for mounting versatility and ease of installation for many lighting applications.

#### Mechanical Information

Fixture Weight:	17 lbs (7.71 kg) 4' 12 lbs (5.44 kg) 2'
Shipping Weight:	19 lbs (8.62 kg) 4' 14 lbs (6.35 kg) 2'
Mounting:	(3) 3/4" NPT openings Optional swivel bracket - LSXW4
Cabling:	10' (3.5m) SOOW Power cord (for Gx and Cx Models)

#### Electrical Specifications

Operating Voltage:	100 - 277V AC 50/60Hz or 347 - 480V AC 50/60Hz
Power Consumption:	See ordering information
Operating Temp:	-40°F to +133°F (-40°C to +55°C)
Harmonics:	EC 61000-3-2
Surge Protection	
100 - 277V AC 50/60Hz:	1 kV line to line 2 kV line to ground
347 - 480V AC 50/60Hz:	6 kV line to line 6 kV line to ground
THD:	< 15%
Power Factor:	> 0.9

Power supply equipped with inline fuse

#### Construction

Body:	Powder coated aluminum
Lens:	Polycarbonate

#### Photometric Information

CRI:	70
CCT:	6,000K (cool white)
IES Files:	Available upon request

All values typical unless otherwise stated  
All lumen values are typical (tolerance +/- 10%)

#### Temperature Ratings

Ambient Temperature Range  
T5 Temperature Code

-40°F to +149°F (-40°C to +65°C)

Conduit Top Mount

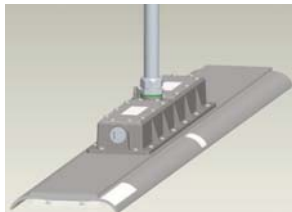

Conduit Side Mount

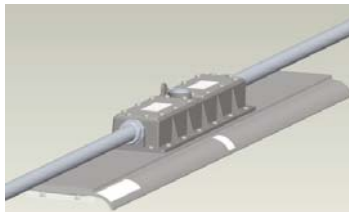

LSXW4





## SafeSite® LED Linear Fixture

### Class I, Div. 1 Version

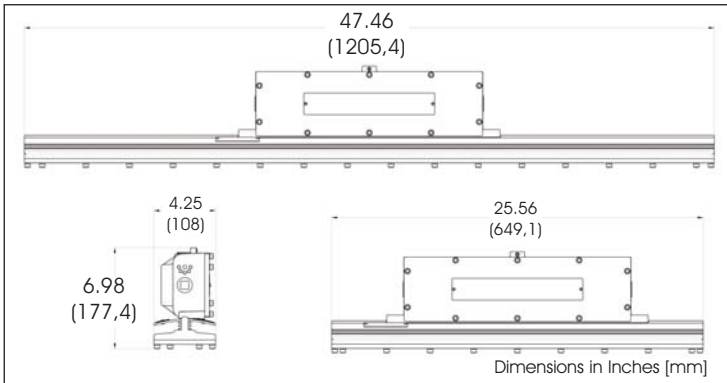

#### Certifications

- Class I, Div 1 Groups C, D
- UL 844
- UL1598
- CSA 22.2 No.137-M81
- UL 8750
- ABS Design Assessed: # 12-HS942957-PDA
- IP66 rated
- NEMA 4X rated

#### Application

The first of its kind, the Dialight SafeSite® LED linear luminaire was designed specifically to replace HID and fluorescent lighting fixtures in industrial and hazardous location applications.

The SafeSite LED Linear fixture's rugged solid state design makes it highly resistant to shock and vibration, while its superior design allows for increased mounting versatility and ease of installation.

#### Mechanical Information

Fixture Weight:	26.0 lbs (11.79 kg) 4' 17.5 lbs (7.94 kg) 2'
Shipping Weight:	28.0 lbs (12.70 kg) 4' 19.5 lbs (8.85 kg) 2'
Mounting:	(1) Threaded 3/4" NPT Side (2) Threaded 3/4" NPT Ends

#### Electrical specifications:

Operating Voltage:	100 - 277V AC 50/60Hz or 347 - 480V AC 50/60Hz
Power Consumption:	See ordering information
Operating Temp:	-40°F to +133°F (-40°C to +55°C)
Harmonics:	IEC 61000-3-2

#### Surge Protection

100 - 277V AC 50/60Hz:	1 kV line to line 2 kV line to ground
347 - 480V AC 50/60Hz:	6 kV line to line 6 kV line to ground

THD: < 15%

Power Factor: > 0.9

#### Construction

Body:	Powder Coated Aluminum
Lens:	Glass

#### Photometric Information

CRI:	70
CCT:	6,000K (cool white)
IES Files:	Available upon request

All values typical unless otherwise state  
All lumen values are typical (tolerance +/- 10%)

#### Temperature Ratings

LSC3C4M3GEX (4ft) Ambient Temperature Range T4a Temperature Code	LSC3C4D3GEX (2ft) Ambient Temperature Range T5 Temperature Code
-40°F to +149°F (-40°C to +65°C)	-40°F to +149°F (-40°C to +65°C)

## Mounting Options

Conduit Top Mount

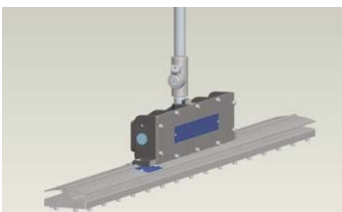

Conduit Side Mount

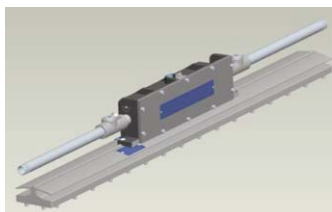

LSXW5

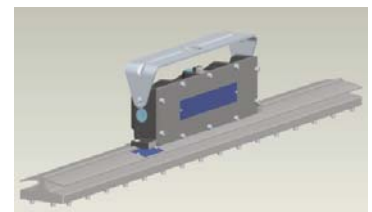



## SafeSite® LED Linear Fixture Class I, Div. 2 Battery Backup Version

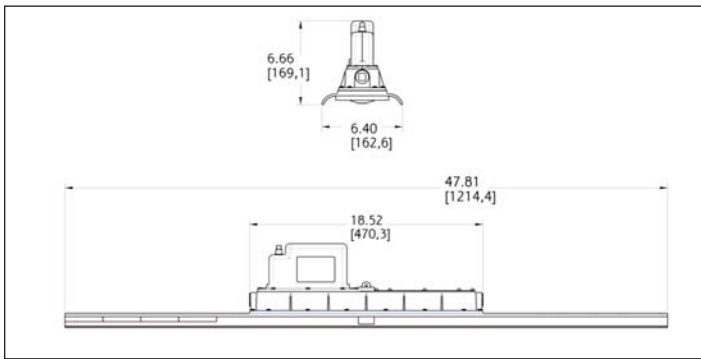

### Certifications

- UL1598A
- UL 844
- UL 924
- CSA 22.2 No.137-M81
- UL 8750
- IP66 rated
- NEMA 4X

### Features & Benefits

- 3 year full performance warranty
- 450 lumens in battery backup mode consistent throughout life of battery
- Low power consumption
- Battery status indication light
- Instant on/off operation
- Push to test button
- Superior color rendition index compared to HPS, LPS, MV
- Mercury Free
- Resistant to shock and vibration
- Temperature compensation technology for longer life

### Application

The first of its kind, the Dialight SafeSite® LED linear luminaire was designed specifically to replace fluorescent lighting fixtures in industrial and hazardous location applications. When main AC power is lost, these lights will continue to operate as they transfer to the integrated battery.

The SafeSite Linear fixture's rugged solid state design makes it highly resistant to shock and vibration, while it's superior design allows for increased mounting versatility and ease of installation.

### Mechanical Information

Fixture Weight:	18.0 lbs (8.16 kg)
Shipping Weight:	21.0 lbs (9.53 kg)
Mounting:	(1) Threaded 3/4" NPT Side (2) Threaded 3/4" NPT Ends

### Electrical specifications:

Operating Voltage:	100-277V AC 50/60 Hz
Power Consumption:	85W 4' version
Operating Temp:	-29°F to +149°F (-20°C to +65°C)
Battery:	3.6V 10Ah Nimh
Battery Life:	3 years
Battery Duration:	>3 hours
Harmonics:	IEC 61000-3-2
Surge Protection:	1 kV line to line 2 kV line to ground

THD:	< 15%
Power Factor:	> 0.95

### Construction

Body:	Powder Coated Aluminum
Lens:	Polycarbonate

### Photometric Information

CRI:	70
CCT:	6,000K (cool white)
IES Files:	Available upon request

All values typical unless otherwise state  
All lumen values are typical (tolerance +/- 10%)

Temperature Rating
Ambient Temperature Range
T4a Temperature Code
-20°F to +149°F (-29°C to +65°C)

### In-line Conduit Mount

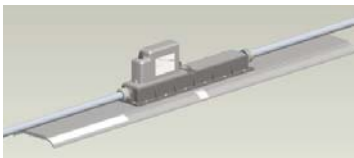

### Mounting Options

#### Overhead Conduit Mount

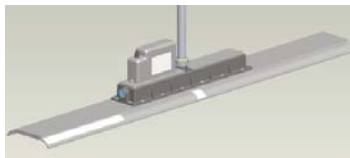

#### Bracket Mount

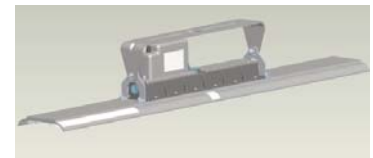

# SafeSite® LED Linear Fixture

## Class 1 Div. 2 Ordning Information

Part Number	Length	Class I, Div 1	Class I Div 2	Class II, Div 1	Class II, Div 2	Class III, Div 1	Class III, Div 2	Voltage	Lens	Initial Fixture Lumens	Watt	Lumens Per Watt
Class I, Div 2												
LSD3C4M2PHE	4'		A / B / C / D		F / G			100 - 277V AC	Clear	7,000	67	104
LSD3C4M2P	4'		A / B / C / D		F / G			100 - 277V AC	Clear	7,250	78	93
LSD3C4H2D	4'		A / B / C / D		F / G			100 - 277V AC	Diffused	5,600	78	72
LSD3C5M2P	4'		A / B / C / D		F / G			347 - 480V AC	Clear	7,250	78	93
LSD3C5H2D	4'		A / B / C / D		F / G			347 - 480V AC	Diffused	5,600	78	72
LSD3C4D2PHE	2'		A / B / C / D		F / G			100 - 277V AC	Clear	3,500	34	103
LSD3C4D2P	2'		A / B / C / D		F / G			100 - 277V AC	Clear	3,600	39	92
LSD3C4B2D	2'		A / B / C / D		F / G			100 - 277V AC	Diffused	2,800	39	72
LSD3C5D2P	2'		A / B / C / D		F / G			347 - 480V AC	Clear	3,600	39	92
LSD3C5B2D	2'		A / B / C / D		F / G			347 - 480V AC	Diffused	2,800	39	72
LSF3C4D2P	2'		A / B / C / D	E / F / G	F / G	•	•	100 - 277V AC	Clear	3,600	39	92
LSF3C4M2P	4'		A / B / C / D	E / F / G	F / G	•	•	100 - 277V AC	Clear	7,250	78	93
LSF3C5D2P	2'		A / B / C / D	E / F / G	F / G	•	•	347 - 480V AC	Clear	3,600	39	92
LSF3C5M2P	4'		A / B / C / D	E / F / G	F / G	•	•	347 - 480V AC	Clear	7,250	78	93
Class I, Div 2 Battery Backup Version												
<sup>2</sup> LSD3C4MEP	4'		A / B / C / D		F/G			100 - 277V AC	Clear	7,250	85	85

Notes:

<sup>1</sup>Part numbers listed in the above table are cool white. For neutral white version replace the 5th character with **N**. Ex. LSD3C4D2P becomes LSD3N4D2P

<sup>2</sup>450 Lumens in battery backup mode

## Class 1 Div. 2 Wiring Configurations (Optional)



Add one of the following suffixes to the above Part Numbers for factory sealed and installed 10' cable and cable gland:

- GS added for installed on one of the side entries (shown to the left)
- GT added for installed on the top entry (not shown)

Ex. LSD3C4D2P becomes LSD3C4D2P**GS**



Add one of the following suffixes to the above Part Numbers for factory sealed and installed 10' cable and 3/4" conduit fitting.:

- CT added for installed on the top entry (shown to the left)
- CS added for installed on one the side entries (not shown)

Ex. LSD3C4D2P becomes LSD3C4D2P**CT**

## Class 1 Div. 1 Ordning Information

Part Number	Length	Class I, Div 1	Class I Div 2	Class II, Div 1	Class II, Div 2	Class III, Div 1	Class III, Div 2	Voltage	Lens	Initial Fixture Lumens	Watt	Lumens Per Watt
Class I, Div 1												
LSC3C4M3GEX	4'	•						100 - 277V AC	Clear	7,250	78	93
LSC3C5M3GEX	4'	•						347 - 480V AC	Clear	7,250	78	93
LSC3C4D3GEX	2'	•						100 - 277V AC	Clear	3,600	39	92
LSC3C5D3GEX	2'	•						347 - 480V AC	Clear	3,600	39	92

# SafeSite® LED Linear Fixture

## Options and Accessories

	Part Number	Description	Kit Includes
Class I, Div. 2 and Class I, Div 2 Battery Backup			
	LSXW4	Mounting bracket Can be angled at 0°, 30°, 45°, 60° & 90°	Mounting bracket Mounting hardware
	LSXENDCAPKIT	Chain mount brackets	2 Mounting brackets Mounting hardware
	LSXBATREP1	Replacement Battery Kit (for Battery Backup version only)	Batteries Wiring Connector
Class I, Div 1			
	LSXW5	Mounting bracket Can be angled at 0°, 30°, 45°, 60° & 90°	Mounting bracket Mounting hardware
All Models			
	HZXSTAN100S	1.00" Slip-Fit Stanchion Mount Junction Box	Junction box Mounting hardware
	HZXSTAN125S	1.25" Slip-Fit Stanchion Mount Junction Box	
	HZXSTAN150S	1.50" Slip-Fit Stanchion Mount Junction Box	
	HZXSTAN200S	2.00" Slip-Fit Stanchion Mount Junction Box	
	HZXSTAN100T	1.00" NPT Threaded Stanchion Mount Junction Box	
	HZXSTAN125T	1.25" NPT Threaded Stanchion Mount Junction Box	
	HZXSTAN150T	1.50" NPT Threaded Stanchion Mount Junction Box	
	HZXSTAN200T	2.00" NPT Threaded Stanchion Mount Junction Box	
	HZXSAFEKIT	Safety Cable Kit	2 Eyelets 2 53" Safety cables Mounting hardware

Dialight reserves the right to make changes at any time in order to supply the best product possible. The most current version of this document will always be available at: [www.dialight.com/Assets/Brochures\\_And\\_Catalogs/Illumination/MDTFSLINX001.pdf](http://www.dialight.com/Assets/Brochures_And_Catalogs/Illumination/MDTFSLINX001.pdf)  
Warranty Statement: EXCEPT FOR THE WARRANTY EXPRESSLY PROVIDED FOR [HEREIN/ABOVE/BELOW], DIALIGHT DISCLAIMS ANY AND ALL OTHER WARRANTIES, EXPRESS OR IMPLIED, INCLUDING, WITHOUT LIMITATION, ANY WARRANTIES OF MERCHANTABILITY, FITNESS FOR A PARTICULAR PURPOSE, TITLE, AND NONINFRINGEMENT.

**SafeSite® LED Linear Fixture**  
for Indoor and Outdoor Industrial Applications





Компания «Life Electronics» занимается поставками электронных компонентов импортного и отечественного производства от производителей и со складов крупных дистрибьюторов Европы, Америки и Азии.

С конца 2013 года компания активно расширяет линейку поставок компонентов по направлению коаксиальный кабель, кварцевые генераторы и конденсаторы (керамические, пленочные, электролитические), за счёт заключения дистрибьюторских договоров

Мы предлагаем:

- Конкурентоспособные цены и скидки постоянным клиентам.
- Специальные условия для постоянных клиентов.
- Подбор аналогов.
- Поставку компонентов в любых объемах, удовлетворяющих вашим потребностям.
- Приемлемые сроки поставки, возможна ускоренная поставка.
- Доставку товара в любую точку России и стран СНГ.
- Комплексную поставку.
- Работу по проектам и поставку образцов.
- Формирование склада под заказчика.
- Сертификаты соответствия на поставляемую продукцию (по желанию клиента).
- Тестирование поставляемой продукции.
- Поставку компонентов, требующих военную и космическую приемку.
- Входной контроль качества.
- Наличие сертификата ISO.

В составе нашей компании организован Конструкторский отдел, призванный помогать разработчикам, и инженерам.

Конструкторский отдел помогает осуществить:

- Регистрацию проекта у производителя компонентов.
- Техническую поддержку проекта.
- Защиту от снятия компонента с производства.
- Оценку стоимости проекта по компонентам.
- Изготовление тестовой платы монтаж и пусконаладочные работы.



Тел: +7 (812) 336 43 04 (многоканальный)  
Email: [org@lifeelectronics.ru](mailto:org@lifeelectronics.ru)