

| LOC | DIST | REVISIONS |     |                           |           |     |      |
|-----|------|-----------|-----|---------------------------|-----------|-----|------|
| GP  | 00   | P         | LTN | DESCRIPTION               | DATE      | DWN | APVD |
|     |      | B         |     | REVISED PER ECR-18-002882 | 27FEB2018 | IT  | SH   |

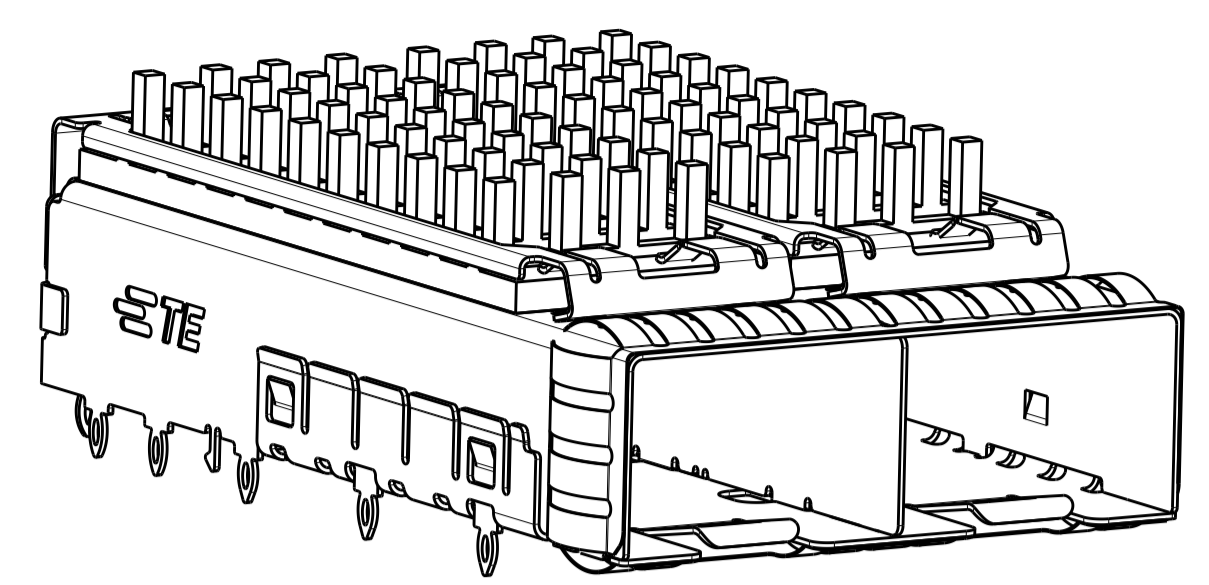

2198230-1, 2, 3, 4  
 FINISHED ASSEMBLY WITH  
 PIN TYPE HEAT SINK

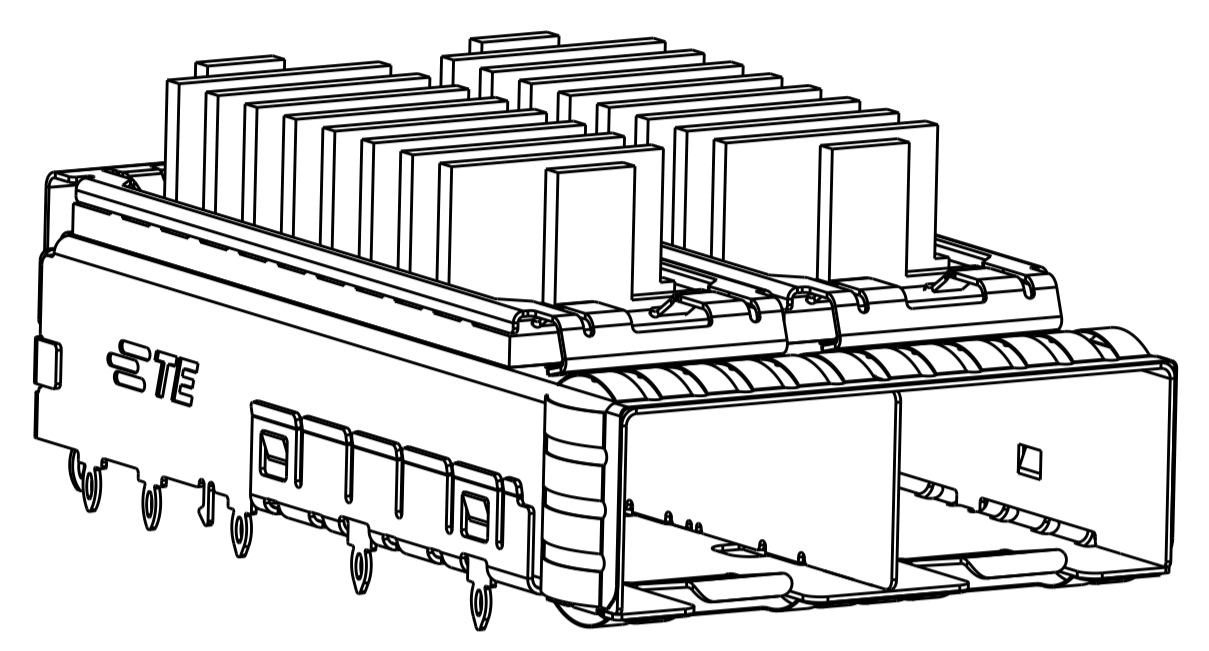

2198230-5, 6, 7, 8  
 FINISHED ASSEMBLY WITH  
 FIN TYPE HEAT SINK

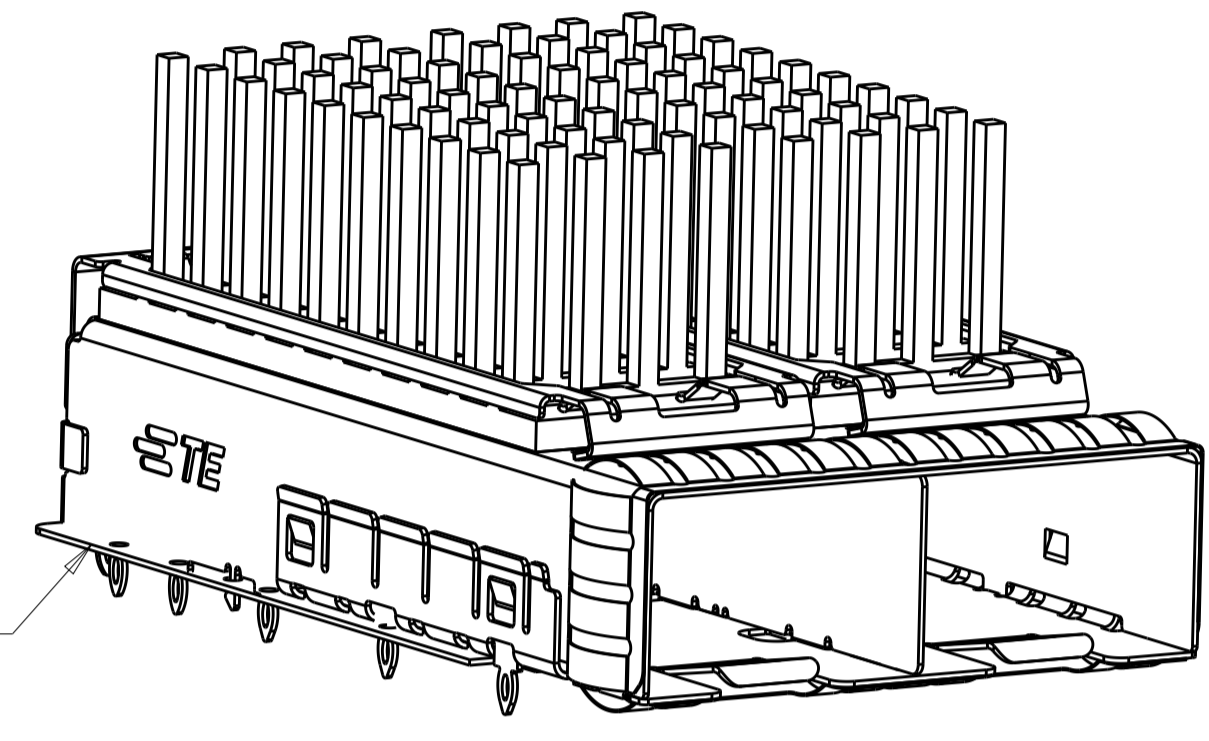

PCB GASKET

1-2198230-4  
 FINISHED ASSEMBLY WITH  
 PIN TYPE HEAT SINK, WITH BELLY GASKET

△ MATERIAL:  
 CAGE ASSEMBLY:  
 0.25mm THICK NICKEL SILVER ALLOY  
 EMI SPRINGS: COPPER ALLOY  
 HEAT SINK: ALUMINUM  
 HEAT SINK CLIP: STAINLESS STEEL.

△ FINISH:  
 HEAT SINK: ELECTROLESS NICKEL  
 HEAT SINK CLIP: PASSIVATE.  
 EMI SPRINGS: 0.8µm MIN MATTE TIN OVER  
 0.8µm MIN NICKEL, NON-PLATED EDGES PERMISSIBLE.

△ DATUM AND BASIC DIMENSIONS ESTABLISHED BY CUSTOMER.

△ PADS AND VIAS CHASSIS GROUND.

5. MATES WITH SFP MSA COMPLIANT RECIEVERS.

6. INTERPRETATION OF DATUM REFERENCE FRAME IN ACCORDANCE WITH SECT 4.4.1.1 OR ASME Y14.5M-1994.

△ MINIMUM PC BOARD THICKNESS:  
 SINGLE SIDED: 1.5mm  
 DOUBLE SIDED: 2.25mm

△ HOLE PATTERN REPEATS FOR EACH PORT, SPACING BETWEEN PORTS IS 14.25mm.

△ REFERENCE APPLICATION SPEC. 114-13120, HOLE A, FOR RECOMMENDED DRILL HOLE DIAMETER AND PLATING THICKNESS.

△ REFERENCE APPLICATION SPEC. 114-13120, HOLE B, FOR RECOMMENDED DRILL HOLE DIAMETER AND PLATING THICKNESS.

11. CERTAIN MATING TRANCEIVERS MAY REQUIRE ADDITIONAL PCB THICKNESS THAT WOULD NEED TO BE DETERMINED BY THE CUSTOMER.

12. PRODUCT COMPLIES WITH SPECIFICATION SFF-8433 IMPROVED PLUGGABLE FORM FACTOR FOR SFP+ GANGED CAGES.

△ DIMENSION APPLIES PRIOR TO INSERTION OF SFP MODULE.

△ WITH BELLY GASKET: RF ABSORBER

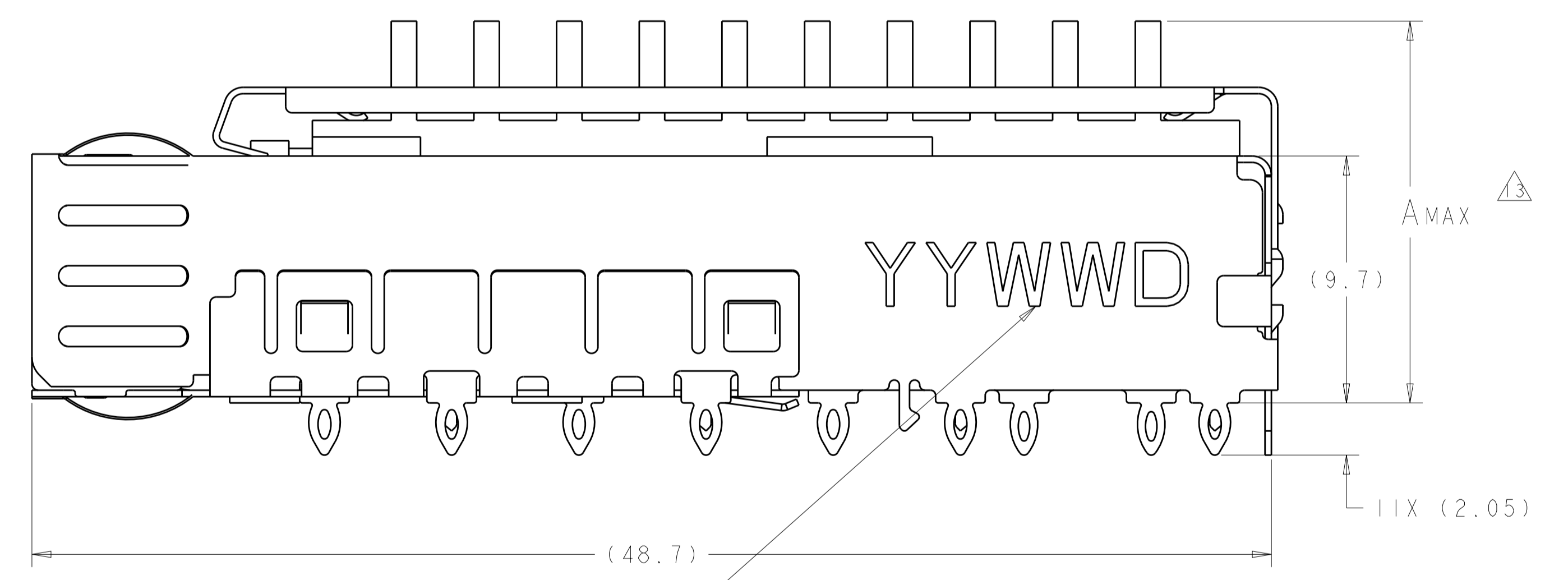
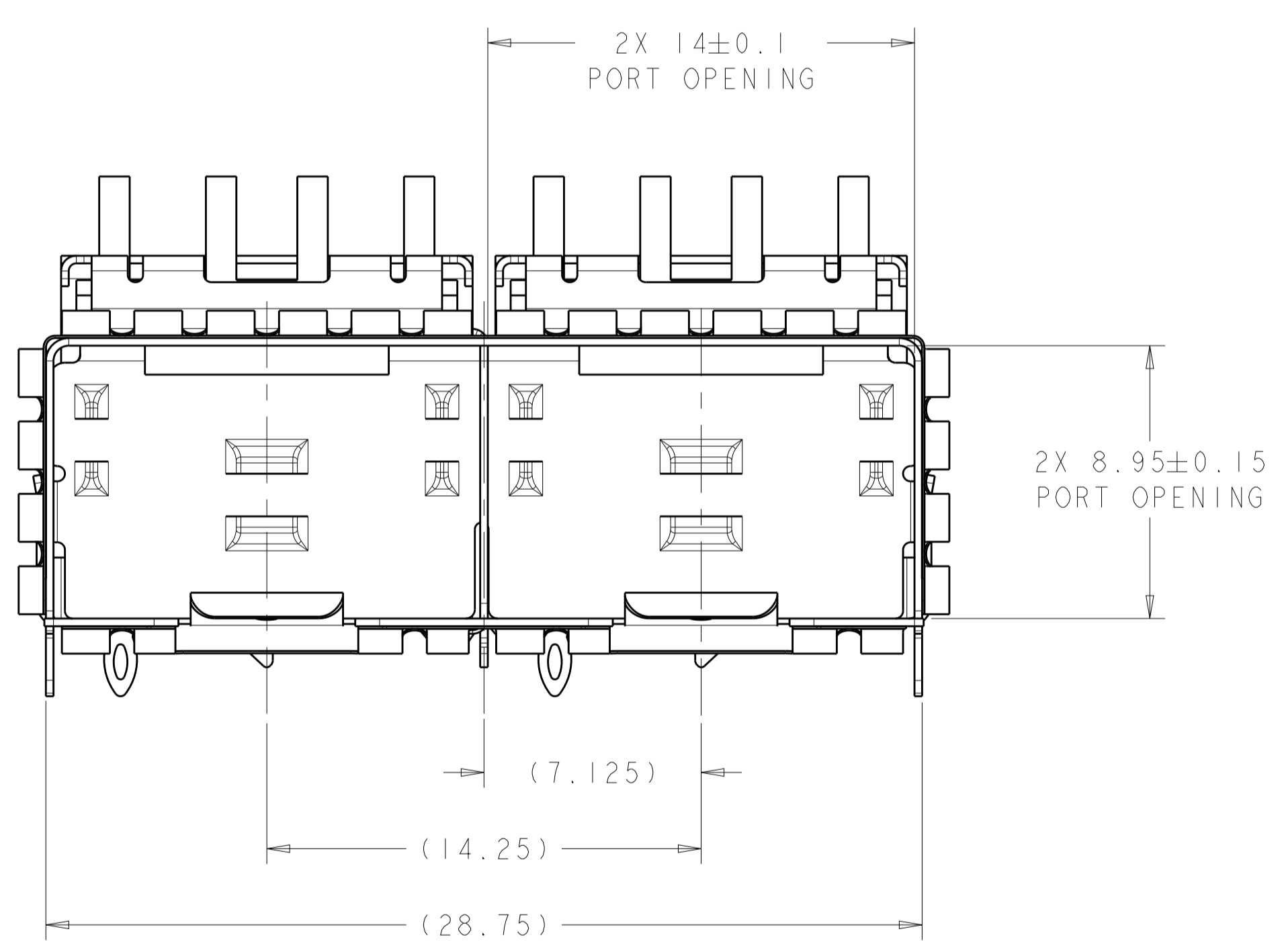

APPROXIMATE LOCATION OF DATE CODE

|           |      |                   |             |
|-----------|------|-------------------|-------------|
| FIN TYPE  | 22.5 | NETWORKING, TALL  | 2198230-8   |
| FIN TYPE  | 18.1 | NETWORKING, SHORT | 2198230-7   |
| FIN TYPE  | 15.5 | SAN               | 2198230-6   |
| FIN TYPE  | 13.2 | PCI               | 2198230-5   |
| PIN TYPE  | 22.5 | NETWORKING, TALL  | 1-2198230-4 |
| PIN TYPE  | 22.5 | NETWORKING, TALL  | 2198230-4   |
| PIN TYPE  | 18.1 | NETWORKING, SHORT | 2198230-3   |
| PIN TYPE  | 15.5 | SAN               | 2198230-2   |
| PIN TYPE  | 13.2 | PCI               | 2198230-1   |
| HEAT SINK | A    | DESCRIPTION       | PART NUMBER |

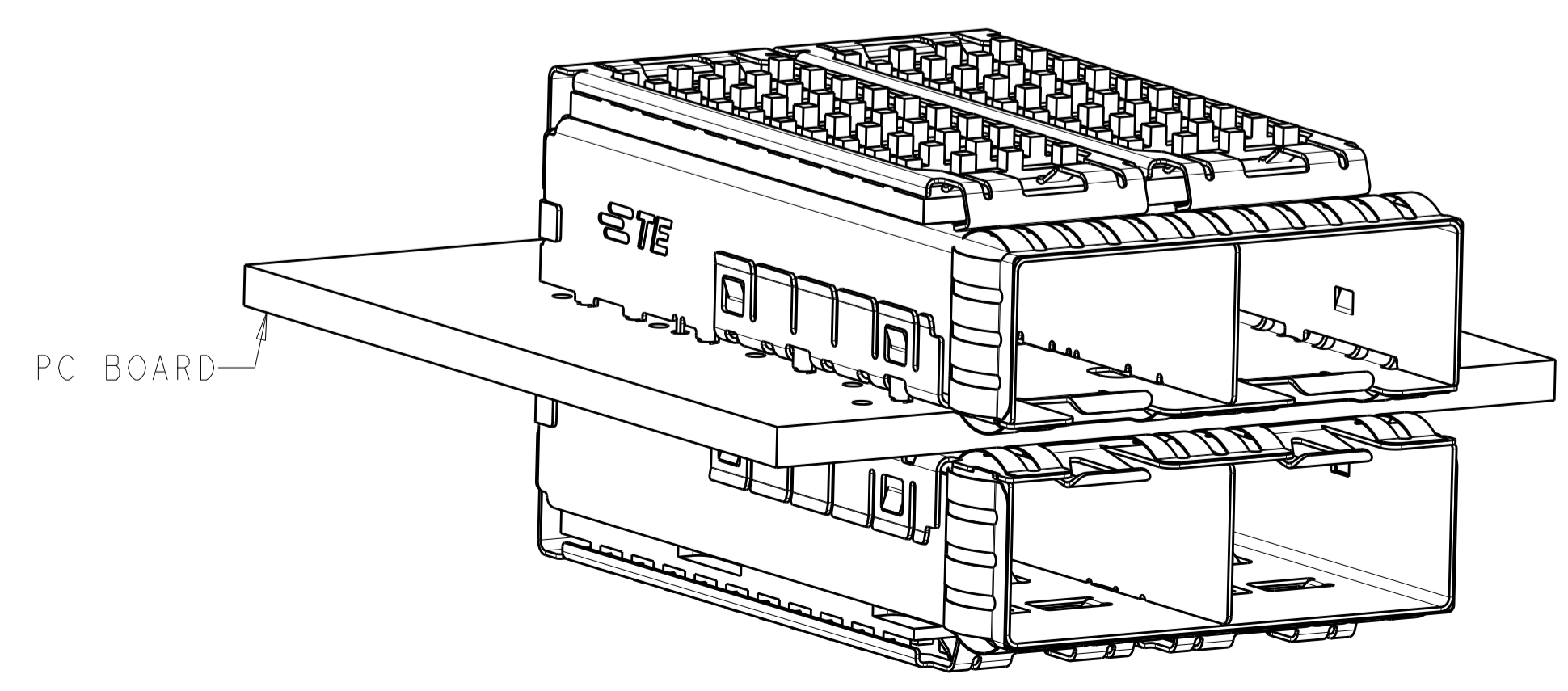

PC BOARD

2198230-1  
 MOUNTED BELLY TO BELLY  
 SCALE 3:1

THIS DRAWING IS A CONTROLLED DOCUMENT. DWN C. VALENTINE 06OCT2011  
 CHK M. SCHMITT 06OCT2011  
 APVD M. SCHMITT 06OCT2011

**STE** TE Connectivity

NAME: SFP+ ENHANCED 1X2 CAGE ASSEMBLY, PRESS-FIT, EMI SPRINGS, HEAT SINK

PRODUCT SPEC: 108-2364  
 APPLICATION SPEC: 114-13120

SIZE: A1  
 CAGE CODE: 00779  
 DRAWING NO: C=2198230

RESTRICTED TO: -

Customer Drawing SCALE 2:1 SHEET 1 OF 4 REV B

| LOC |    | DIST |     | REVISIONS   |      |     |      |
|-----|----|------|-----|-------------|------|-----|------|
| GP  | 00 | P    | LTH | DESCRIPTION | DATE | DMN | APVD |
|     |    | -    | -   | SEE SHEET 1 | -    | -   | -    |

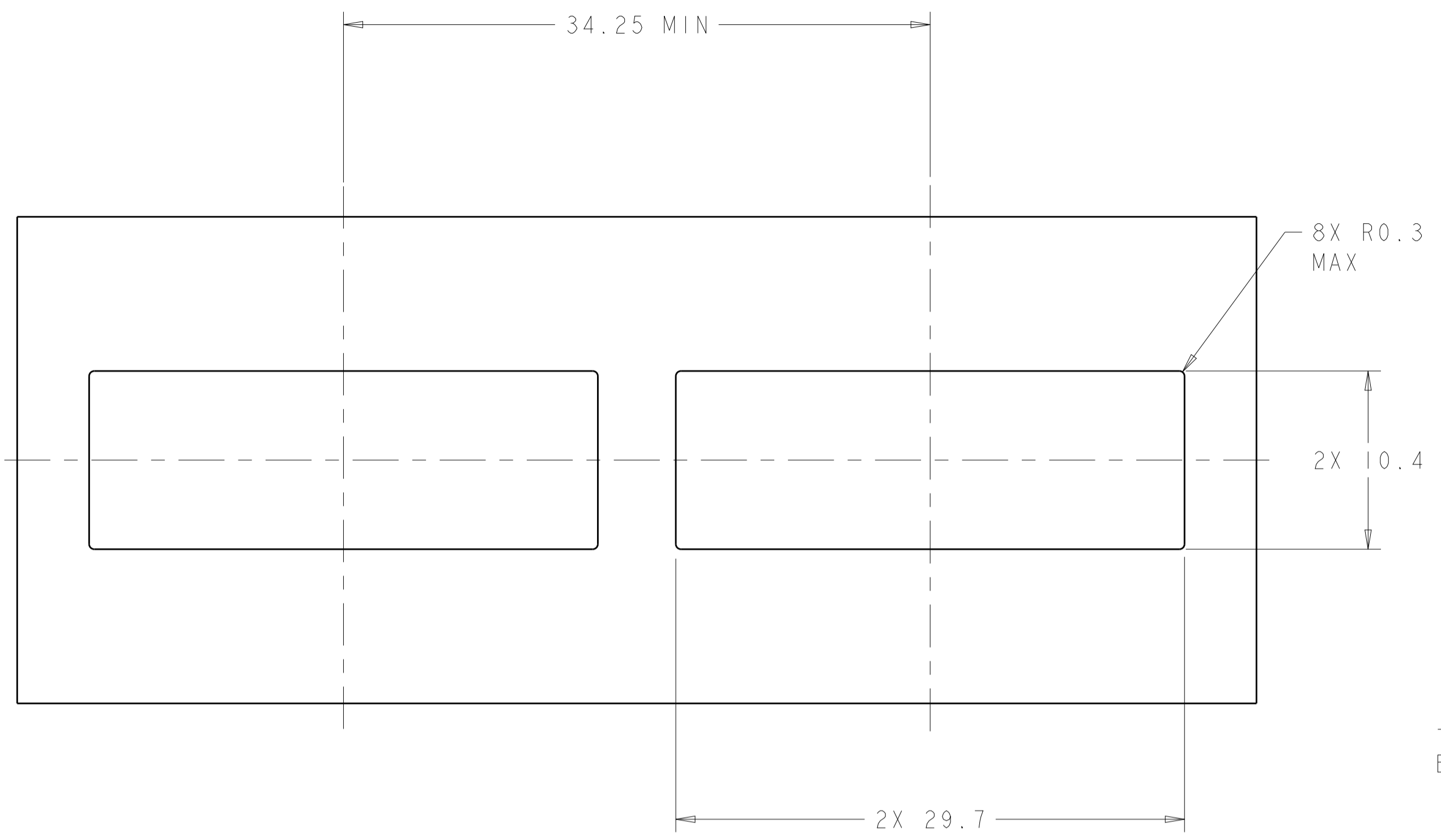

RECOMMENDED BEZEL CUT-OUT  
 SINGLE SIDED APPLICATIONS  
 SCALE 4:1

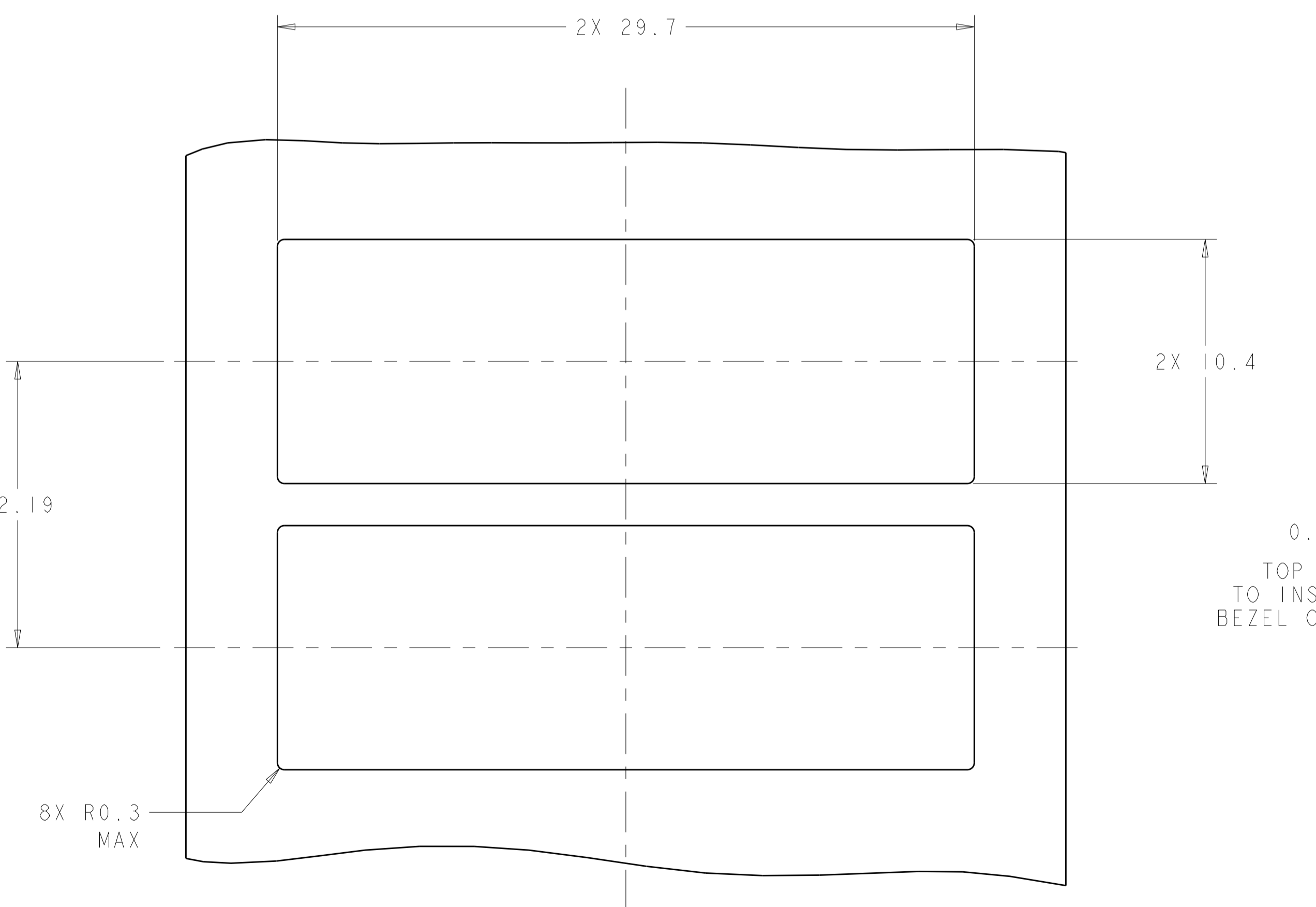

RECOMMENDED BEZEL CUT-OUT  
 BELLY TO BELLY APPLICATIONS

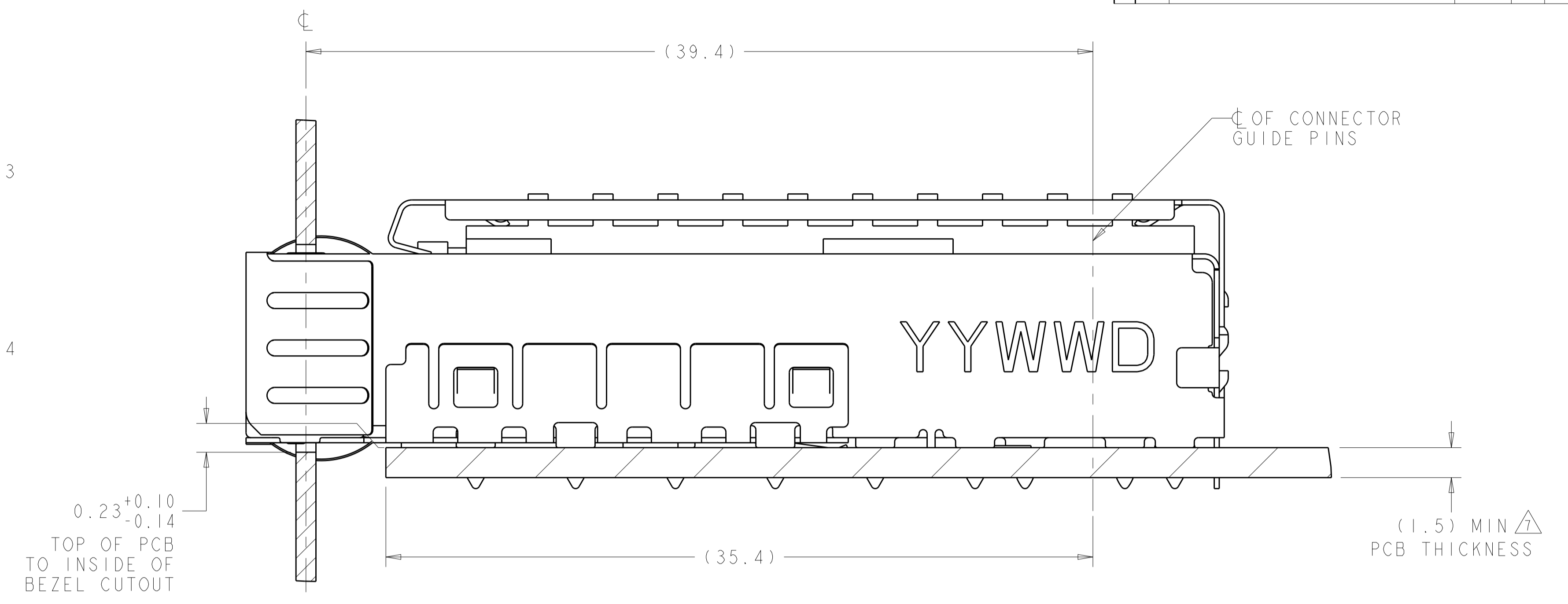

2198230-1  
 MOUNTED ON PC BOARD  
 SHOWN THRU RECOMMENDED BEZEL

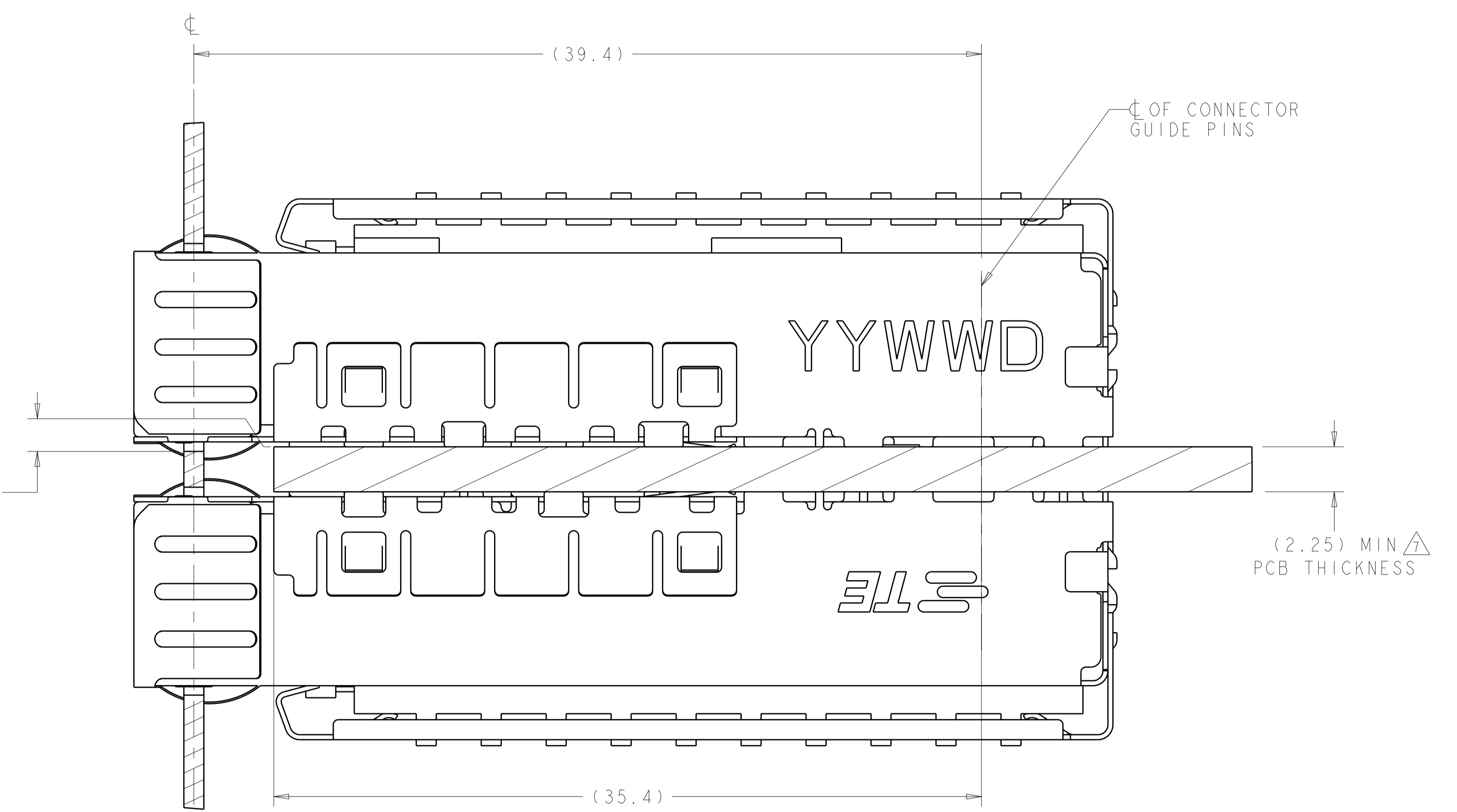

2198230-1  
 MOUNTED BELLY TO BELLY ON PC BOARD  
 SHOWN THRU RECOMMENDED BEZEL

|  |             |                                  |  |
|--|-------------|----------------------------------|--|
| THIS DRAWING IS A CONTROLLED DOCUMENT. |             | DMN<br>C. VALENTINE<br>06OCT2011 | <br>TE Connectivity  |
| DIMENSIONS:                            |             | CHK<br>M. SCHMITT<br>06OCT2011   |  |
| TOLERANCES UNLESS OTHERWISE SPECIFIED: |             | APVD<br>M. SCHMITT<br>06OCT2011  | NAME<br>SFP+ ENHANCED 1X2 CAGE ASSEMBLY,<br>PRESS-FIT, EMI SPRINGS,<br>HEAT SINK |
| mm                                     | 0 PLC ±0.13 | PRODUCT SPEC                     | SIZE<br>108-2364   |
|  | 1 PLC ±0.1  | APPLICATION SPEC                 | RESTRICTED TO  |
|  | 2 PLC ±0.08 | 114-13120                        | A100779  |
|  | 3 PLC ±0.05 | WEIGHT                           | SCALE 6:1 SHEET 2 OF 4 REV B   |
|  | 4 PLC ±0.05 | FINISH                           | Customer Drawing   |
|  | ANGLES      |                                  |  |

| LOC | DIST | REVISIONS |             |    |      |
|-----|------|-----------|-------------|----|------|
| GP  | 00   | REV       | DATE        | BY | APPV |
|     |      | 1         | SEE SHEET 1 |    |      |

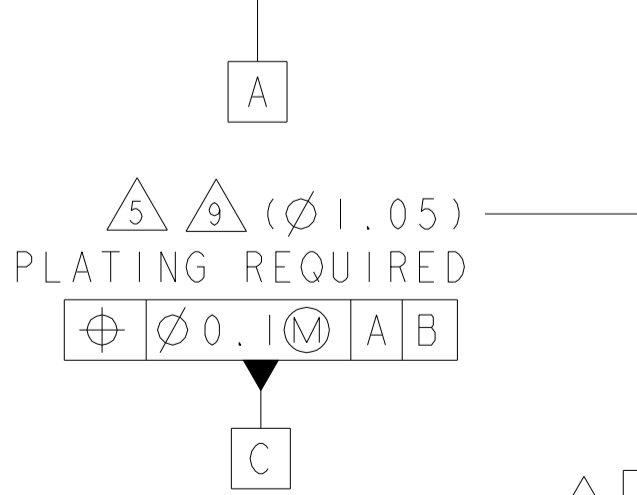
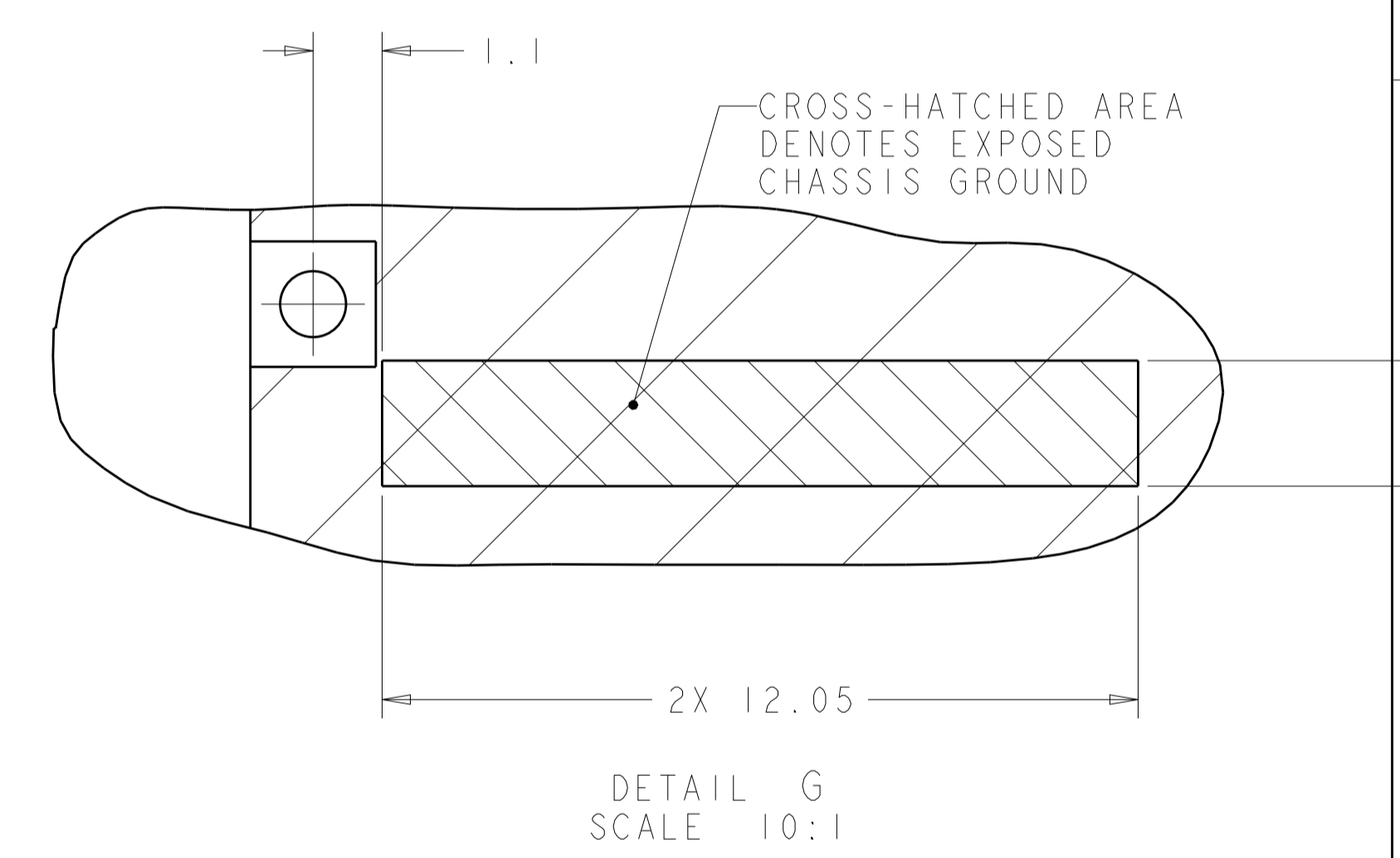
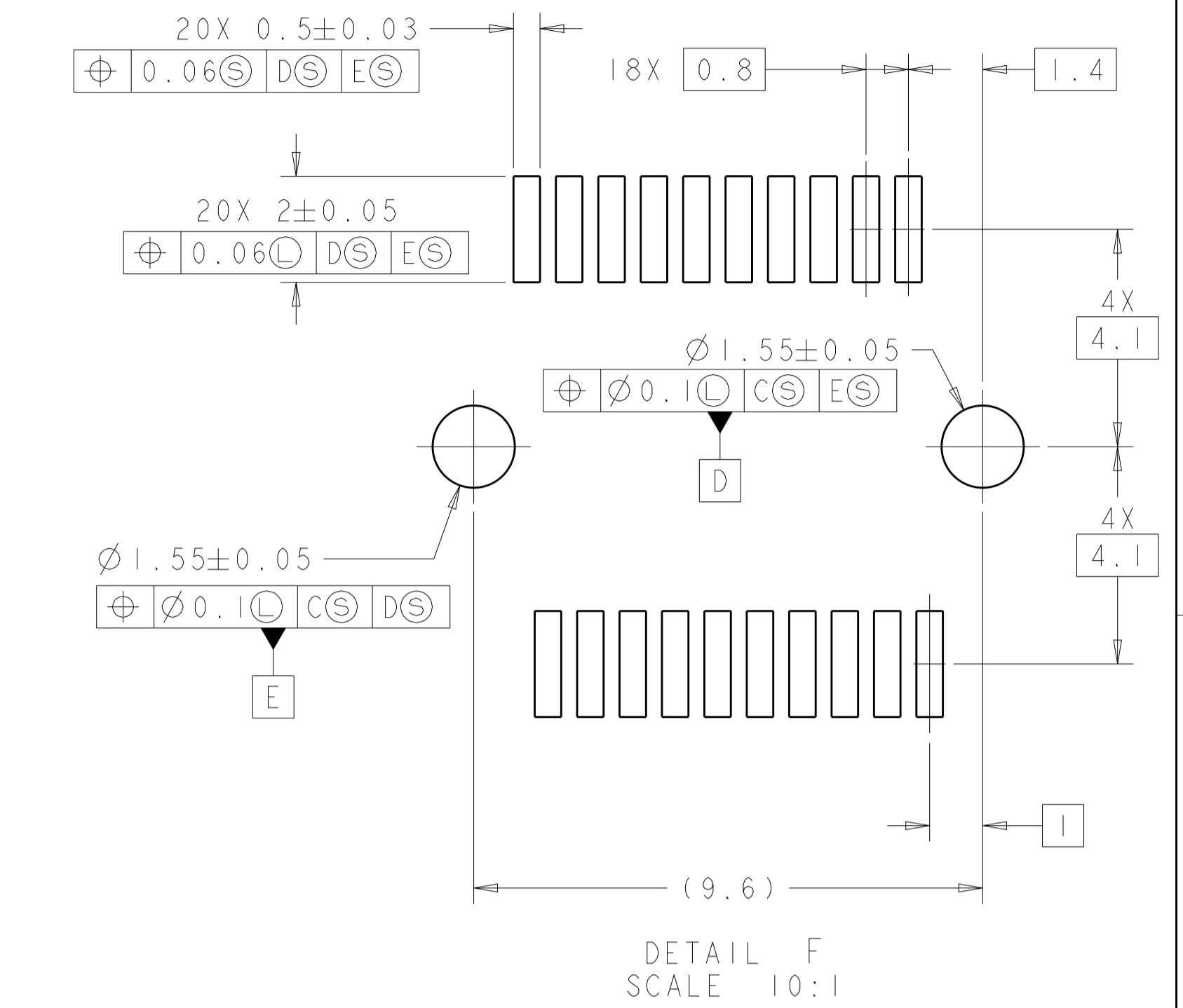
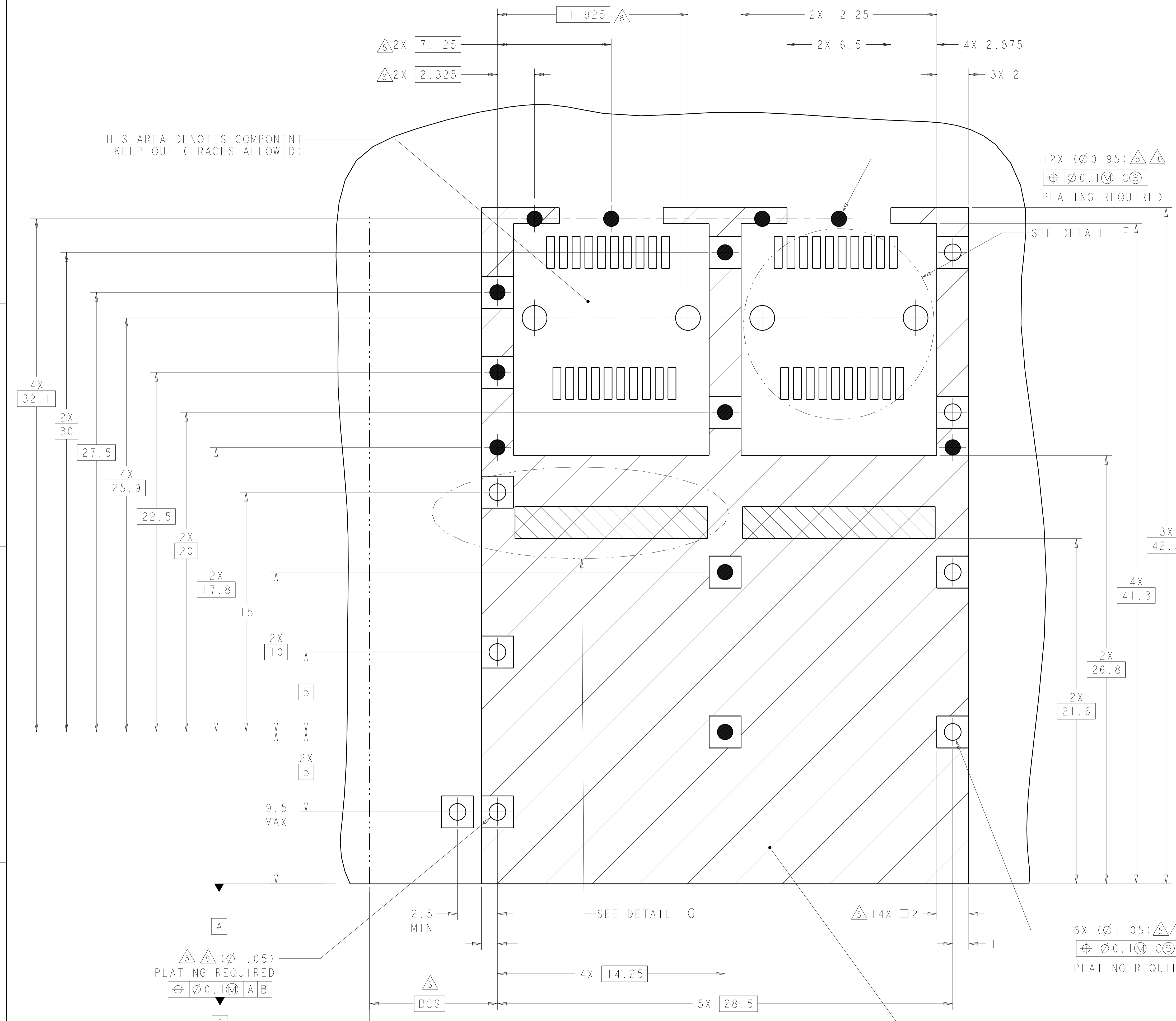

RECOMMENDED PCB CONFIGURATION WITH KEEP-OUT AREAS SINGLE SIDED APPLICATIONS SCALE 8:1

CROSS-HATCHED AREA DENOTES COMPONENT AND TRACE KEEP-OUT (EXCEPT CHASSIS GROUND)

|  |       |                             |   |
|--|-------|-----------------------------|---|
| THIS DRAWING IS A CONTROLLED DOCUMENT. |       | OWN: C. VALENTINE 06OCT2011 | TE Connectivity<br>NAME: SFP+ ENHANCED 1X2 CAGE ASSEMBLY, PRESS-FIT, EMI SPRINGS, HEAT SINK |
| DIMENSIONS: mm                         |       | CHK: M. SCHMITT 06OCT2011   |   |
| TOLERANCES UNLESS OTHERWISE SPECIFIED: |       | APVD: M. SCHMITT 06OCT2011  | PRODUCT SPEC  |
| 0 PLC                                  | ±0.13 | 108-2364                    | APPLICATION SPEC  |
| 1 PLC                                  | ±0.1  | 114-13120                   | WEIGHT  |
| 2 PLC                                  | ±0.08 |                             | Customer Drawing  |
| 3 PLC                                  | ±0.05 |                             | SCALE 6:1   |
| 4 PLC                                  | ±0.05 |                             | SHEET 3 OF 4  |
| ANGLES                                 | ±0.5  |                             | REV B   |

| LOC | DIST | REV | DATE | APPV |
|-----|------|-----|------|------|
| GP  | 00   |     |      |      |

| REVISIONS |      |      |             |    |
|-----------|------|------|-------------|----|
| REV       | DATE | APPV | DESCRIPTION | BY |
| -         | -    | -    | SEE SHEET 1 | -  |

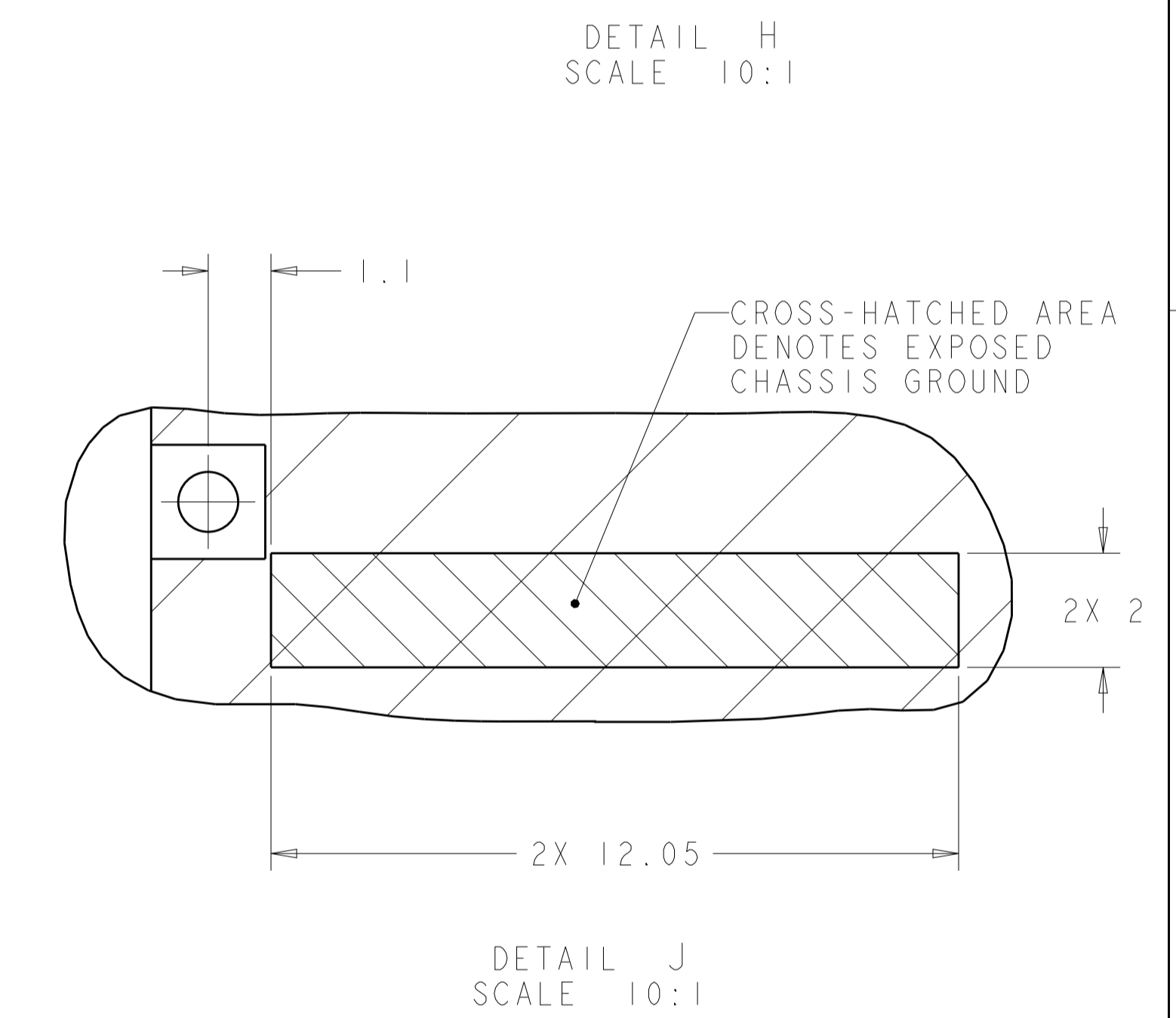
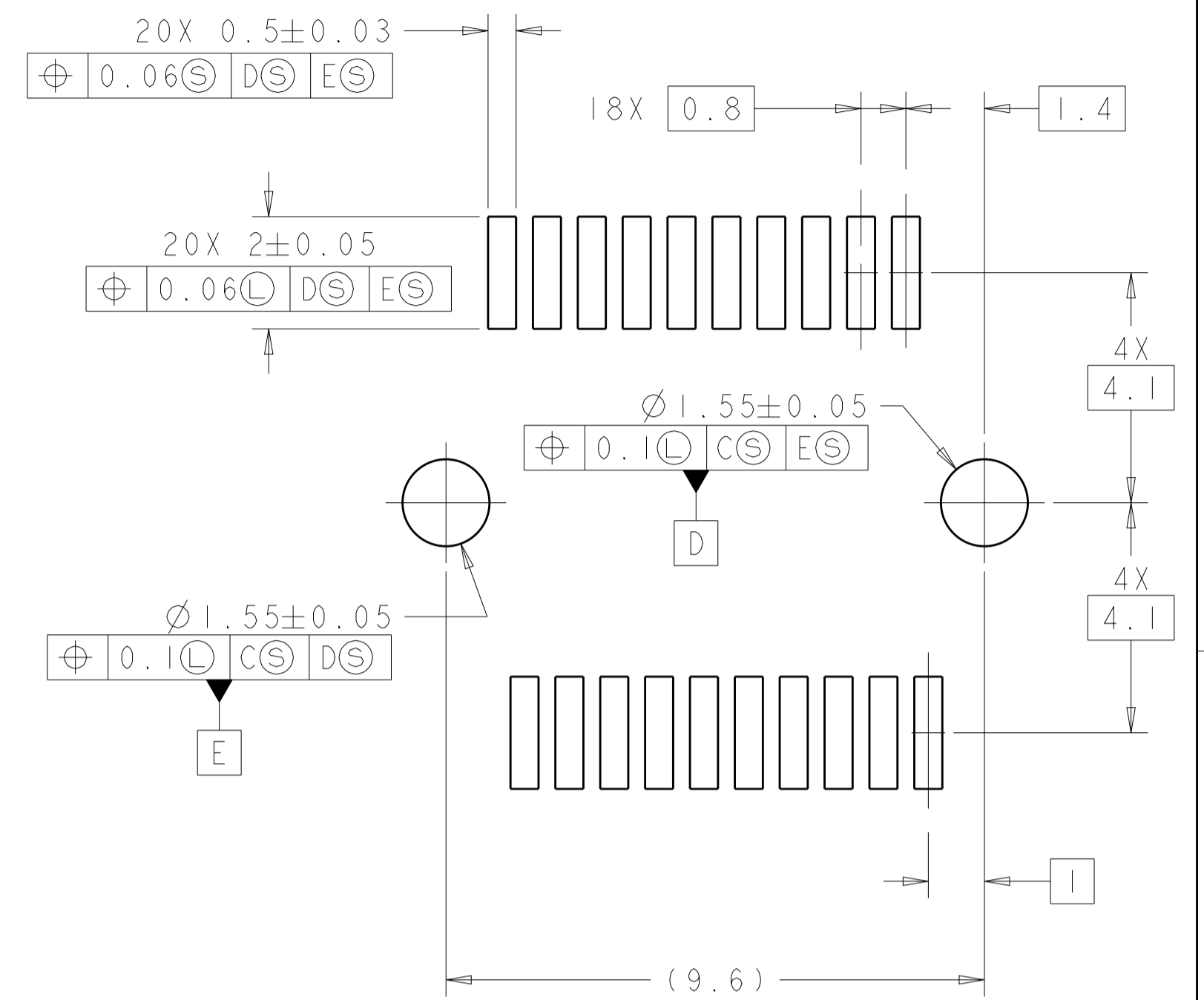
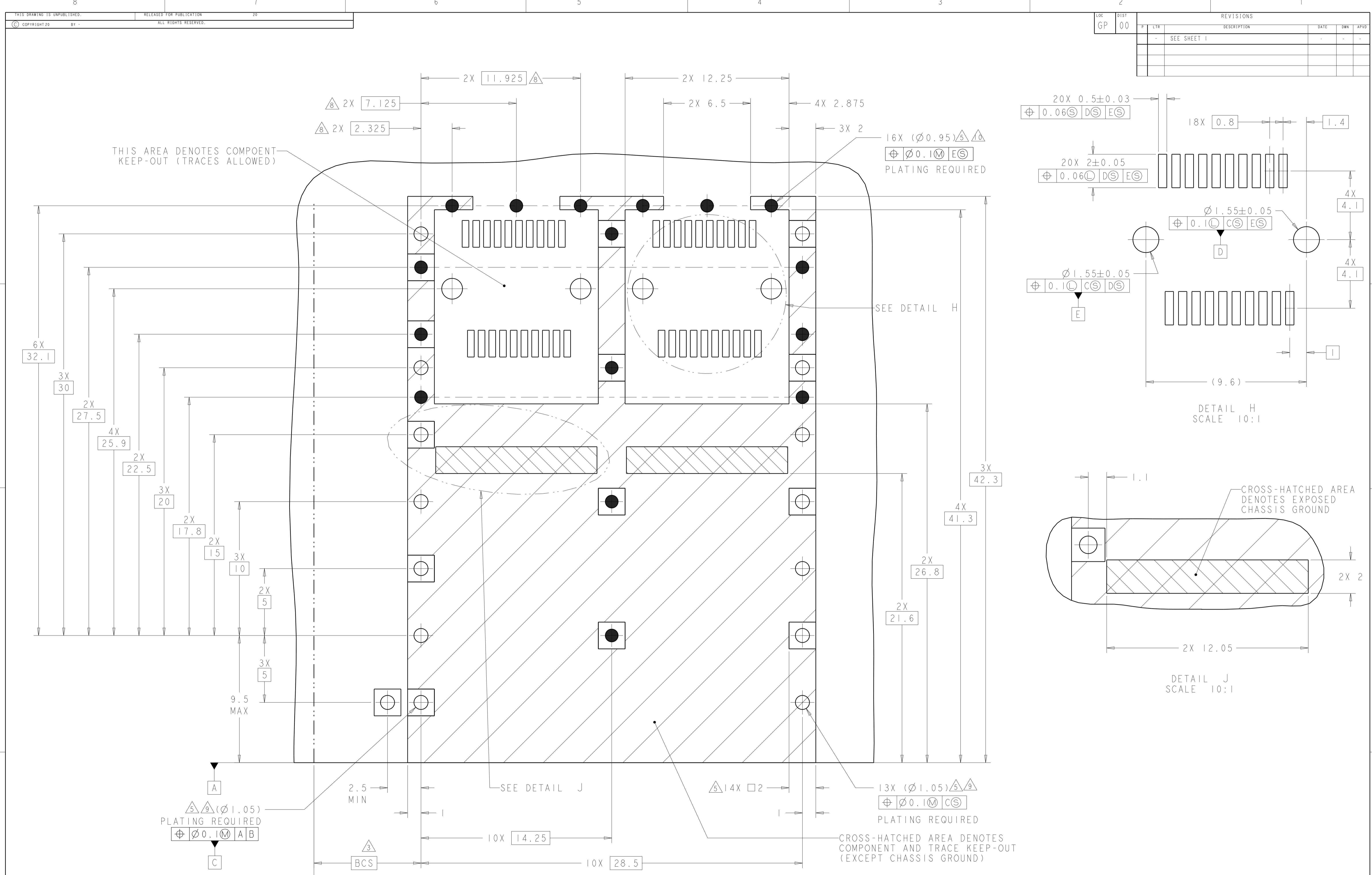

RECOMMENDED PCB CONFIGURATION WITH KEEP-OUT AREAS BELLY TO BELLY APPLICATIONS SCALE 8:1

|  |  |                             |   |
|--|--|-----------------------------|---|
| THIS DRAWING IS A CONTROLLED DOCUMENT. |  | OWN: C. VALENTINE 06OCT2011 | TE Connectivity   |
| DIMENSIONS: mm                         |  | CHK: M. SCHMITT 06OCT2011   |   |
| TOLERANCES UNLESS OTHERWISE SPECIFIED: |  | APVD: M. SCHMITT 06OCT2011  | NAME: SFP+ ENHANCED 1X2 CAGE ASSEMBLY, PRESS-FIT, EMI SPRINGS, HEAT SINK<br>PRODUCT SPEC: 108-2364<br>APPLICATION SPEC: 114-13120<br>WEIGHT: -<br>SCALE: 6:1 SHEET 4 OF 4 REV B |
| 0 PLC ±0.13                            |  | RESTRICTED TO:              |   |
| 1 PLC ±0.1                             |  |                             |   |
| 2 PLC ±0.08                            |  |                             |   |
| 3 PLC ±0.05                            |  |                             |   |
| 4 PLC ±0.05                            |  |                             |   |
| ANGLES ±1                              |  |                             |   |
| MATERIAL FINISH                        |  |                             |   |

Компания «Life Electronics» занимается поставками электронных компонентов импортного и отечественного производства от производителей и со складов крупных дистрибьюторов Европы, Америки и Азии.

С конца 2013 года компания активно расширяет линейку поставок компонентов по направлению коаксиальный кабель, кварцевые генераторы и конденсаторы (керамические, пленочные, электролитические), за счёт заключения дистрибьюторских договоров

Мы предлагаем:

- Конкурентоспособные цены и скидки постоянным клиентам.
- Специальные условия для постоянных клиентов.
- Подбор аналогов.
- Поставку компонентов в любых объемах, удовлетворяющих вашим потребностям.
- Приемлемые сроки поставки, возможна ускоренная поставка.
- Доставку товара в любую точку России и стран СНГ.
- Комплексную поставку.
- Работу по проектам и поставку образцов.
- Формирование склада под заказчика.
- Сертификаты соответствия на поставляемую продукцию (по желанию клиента).
- Тестирование поставляемой продукции.
- Поставку компонентов, требующих военную и космическую приемку.
- Входной контроль качества.
- Наличие сертификата ISO.

В составе нашей компании организован Конструкторский отдел, призванный помогать разработчикам, и инженерам.

Конструкторский отдел помогает осуществить:

- Регистрацию проекта у производителя компонентов.
- Техническую поддержку проекта.
- Защиту от снятия компонента с производства.
- Оценку стоимости проекта по компонентам.
- Изготовление тестовой платы монтаж и пусконаладочные работы.



Тел: +7 (812) 336 43 04 (многоканальный)

Email: [org@lifeelectronics.ru](mailto:org@lifeelectronics.ru)